

# Heidelberg Mo Rider Roller Installation

**1**

Locate the two M8 tapped holes in the OPS press frame just below the form roller hanger. Install the provided stop bracket assembly using the supplied bolt (finger tighten only at this point) in the lower hole as shown in the diagram (OPS shown). The flip down tab on these brackets will lock out the rider roller and prevent the hangers from contacting the form roller when the rider roller is removed. Make sure that the brackets are installed so that the radiused portion of the tab is on top when the tab is flipped down as shown. Repeat this procedure for the NOPS.

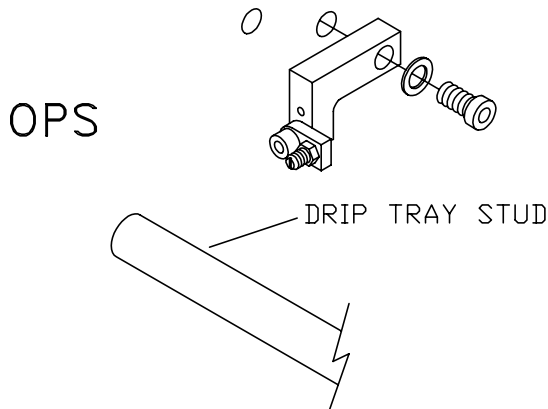

**2**

Install the provided OPS rider roller hanger in the upper M8 hole using the spool and supplied hardware as shown in the diagram. Rotate the stop installed in the previous step until it hits the bottom of the spool. Tighten the stop bracket bolt. Do not attach the spring at this time. Repeat this procedure for the NOPS.

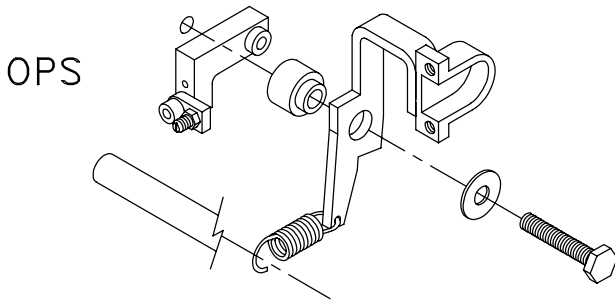

**3**

Install the rider roller and secure it in place with the bearing caps as shown in the diagram. Hook the springs that are attached to the hangers around the drip tray stud. Check to make sure that the rider roller is contacting the form roller.

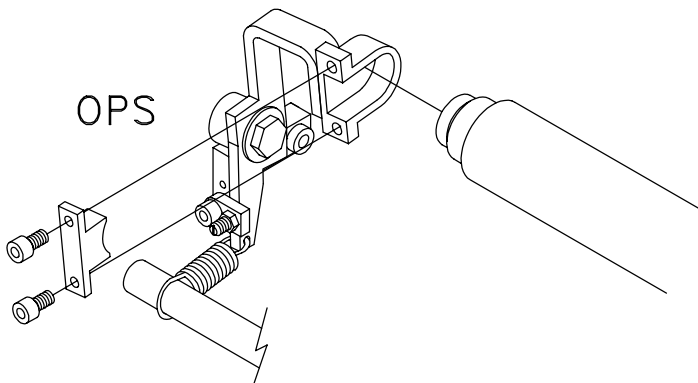

HEIDELBERG MD RIDER ROLL OPS

