

PowderPro[®] Spray System

Installation Instructions

Ryobi 3304

ACCEL  [®]
Graphic Systems

GENERAL INFORMATION

**ATTENTION
POWDERPRO®
OWNER!**

Accel Graphic Systems provides parts and service through its authorized distributors and dealers. Therefore, all requests for parts and service should be directed to your local dealer.

The philosophy of Accel Graphic Systems is to continually improve all of its products. Written notices of changes and improvements are sent to Accel Graphic Systems' Dealers.

If the operating characteristics or the appearance of your product differs from those described in this manual, please contact your local Accel Graphic Systems Dealer for updated information and assistance.

Always update your equipment when improvements are made available, especially those related to safety.

YOUR AUTHORIZED POWDERPRO® DEALER IS:

**THE SERIAL NUMBER OF YOUR
POWDERPRO® IS:**

For technical assistance, please contact:

ACCEL GRAPHIC SYSTEMS
11103 Indian Trail
Dallas, TX 75229
(972) 484-6808
FAX (800) 365-6510
E-Mail accel@dallas.net
Web Site www.accelgraphicsystems.com

PowderPro® is covered by U.S. Patents Pending

INSTALLATION

1

DISCONNECT THE ELECTRICAL POWER TO THE PRESS.

2

Remove the NOPS side covers necessary to access the press electrical cabinet and where the powder spray hoses go through the press frame.

3

Remove the original spray system from the press including the control box, spray head, pump and all hoses and wiring.

5

Diagram A

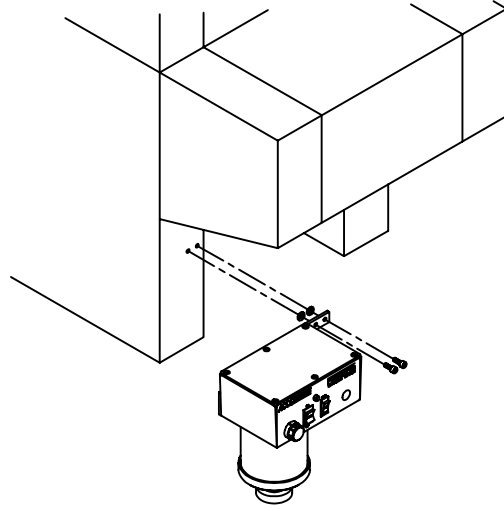
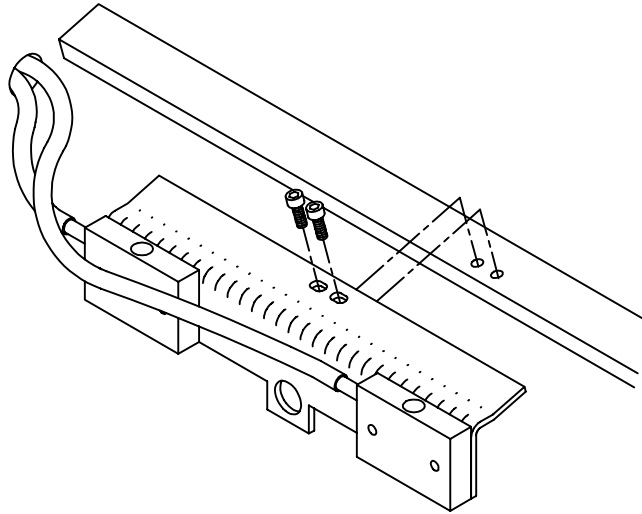

Diagram B



INSTALLATION

4

Using the supplied bolts and thick washers install the PowderPro® control box to the press as shown in DIAGRAM A. The thick washers go behind the mounting bracket to allow clearance for the side cover. The PowderPro® control box mounts to the press using the same two threaded holes that the original spray control attached to.

5

Using the provided bolts attach the PowderPro® spray bar to the press as shown in DIAGRAM B. The spray bar attaches to the same tie bar that the original spray bar did. Route the hoses attached to the spray heads through the hole in the NOPS press frame as shown in DIAGRAM B. Have someone rotate the press by hand to make sure the spray bar and hoses are clear of all moving parts in the delivery.

6

In the press electrical cabinet, locate the MC33 and MC34 connectors on the circuit board. Attach the provided t-tap splice connectors to the wires in positions 1,2,4 and 5 on both the MC33 and MC34 connectors.

7

Diagram C

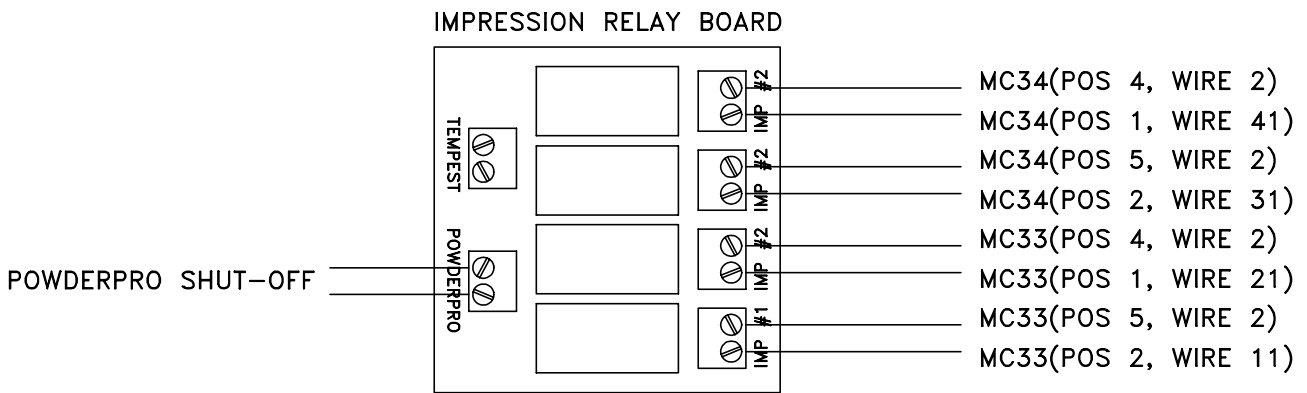

INSTALLATION

7

Place the provided impression relay board in an open area inside the electrical cabinet so that the cables on the board will reach the connectors installed in a previous step.

8

Connect the four cables from the impression board into the t-tap connectors installed in the previous step. On the MC33 connector, connect one cable to the wires in positions 1 and 4, and another cable to the wires in positions 2 and 5. On the MC34 connector, connect one cable to the wires in positions 1 and 4, and another cable into the wires in positions 2 and 5. See diagram C.

9

Plug the provided cable assembly into the two-pin connector coming out of the PowderPro® control box. Route the cable into the press electrical box and to the impression board installed in a previous step. Insert the wire into the J6 connector (also labeled "PowderPro®") on the board. Use the provided tie wraps to secure the cable as necessary.

9

INSTALLATION

10

Set the provided pump on the floor of the NOPS. Plug the cable into the appropriate connector coming out of the PowderPro® control box. Route the hose from the pump to the barbed fitting coming out of the PowderPro® control box.

11

Route the tubes coming from the spray heads, installed in a previous step, into the delivery side cover and out the notch in the side of the cover. Connect the tubes to the stainless steel tubes coming out the end of the PowderPro® control box.

12

Use the provided tie-wraps to secure all loose wires and hose. Plug the power cord into a 110V wall receptacle.

Replace all covers. Switch the power to the press ON. Proceed to the section "OPERATION & MAINTENANCE."

OPERATION & MAINTENANCE

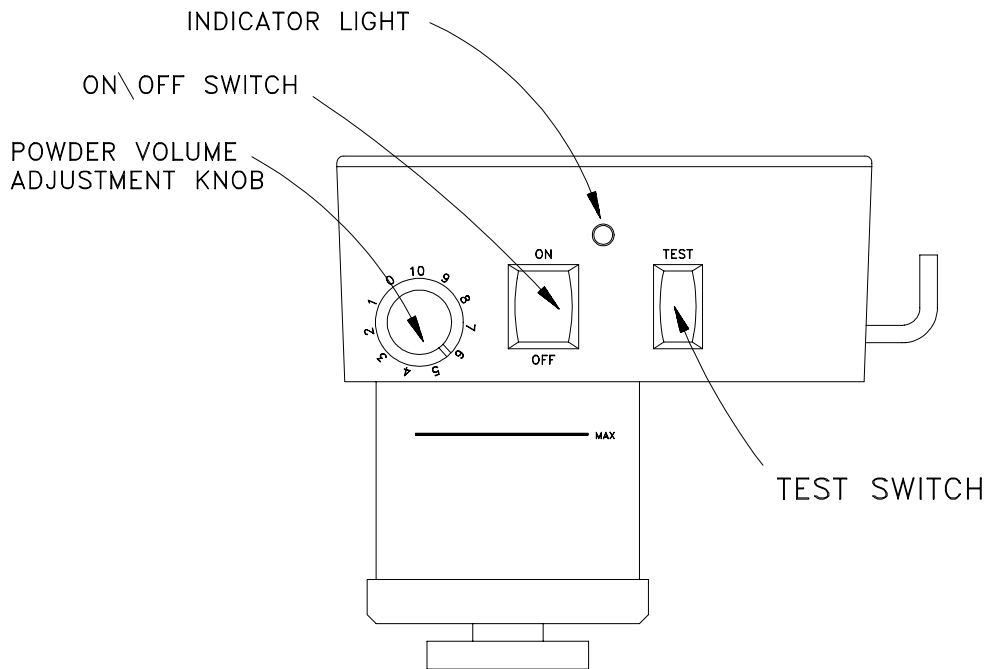

POWDER PRO CONTROLS

VOLUME ADJUSTMENT KNOB

Adjusts the amount of spray powder with "0" the minimum and "10" the maximum.

ON/OFF SWITCH

When switched to the "MANUAL PUMP ON" position the pump will come on to allow for spray volume setting. When switched to the "NORMAL OPERATION" position, the system is armed and will spray only when the press goes on impression. The center position is off.

INDICATOR LIGHT

This light is illuminated only when the unit is actually spraying. The light will go on and off as sheets pass under the spray nozzles.

TEST SWITCH

Use this switch for setting powder volume when not printing. With the on/off switch set to "MANUAL PUMP ON," push the test switch to visually see the amount of powder being sprayed. Adjust if necessary.

OPERATION & MAINTENANCE

INITIAL SETTINGS

The initial setting for the powder volume adjustment on an average job is “5”. If more powder is required than is available at a setting of “10” you need to adjust the pump. If less powder is required than is available at a setting of “0” you also have to adjust the pump. So that you have a wide range of powder volume adjustment available for different jobs you want your “normal” setting for average jobs to be somewhere in the range from “4” to “6”, otherwise you need to adjust the pump.

PUMP ADJUSTMENT

Powder volume range is adjusted by the outlet pressure of the pump. Locate the adjustment knob on the pump near the outlet hose. Loosen the locking knob and turn the adjustment knob clockwise to increase the pressure for more powder. Turn the knob counter clockwise to decrease pressure for less powder. Set the correct pump pressure as follows:

1. Set the ON/OFF switch on the PowderPro® control box to the "MANUAL PUMP ON" position.
2. Set the powder volume adjustment knob to "10".
3. Hold the "Test" switch "On" while looking at the spray nozzles in the delivery.
4. Have someone slowly adjust the pressure on the pump until the powder is barely visible. A powder setting of "10" with visible powder in the delivery is more than enough powder. Consequently, a setting of "5" results in no visible powder but sufficient powder for most jobs.

If powder is visible at the "5" setting then too much powder is being sprayed. Return to step 3 and reset the pump.

5. Tighten the locking knob on the pump adjustment.

OPERATION & MAINTENANCE

OPERATION

1. Fill the hopper with an intermediate grain (20 -25 micron) powder, available from Accel, up to the "MAX" line on the hopper.
2. Place the "ON/OFF" switch in the "NORMAL OPERATION" position. Sprayer comes on and off automatically when the press is on or off impression.
3. Adjust the powder volume adjustment knob as necessary.

MAINTENANCE

1. Clean the filter on the pump once a week, blowing it clean with compressed air.
2. Remove powder that may accumulate on the bottom of the spray nozzles daily.
3. Never use solvents containing oil when cleaning any part of the sprayer.
4. Use compressed air only if your compressor is equipped with a proper in-line dryer. Otherwise, use canned air. Moisture in the sprayer affects its performance.

RYOBI 3304

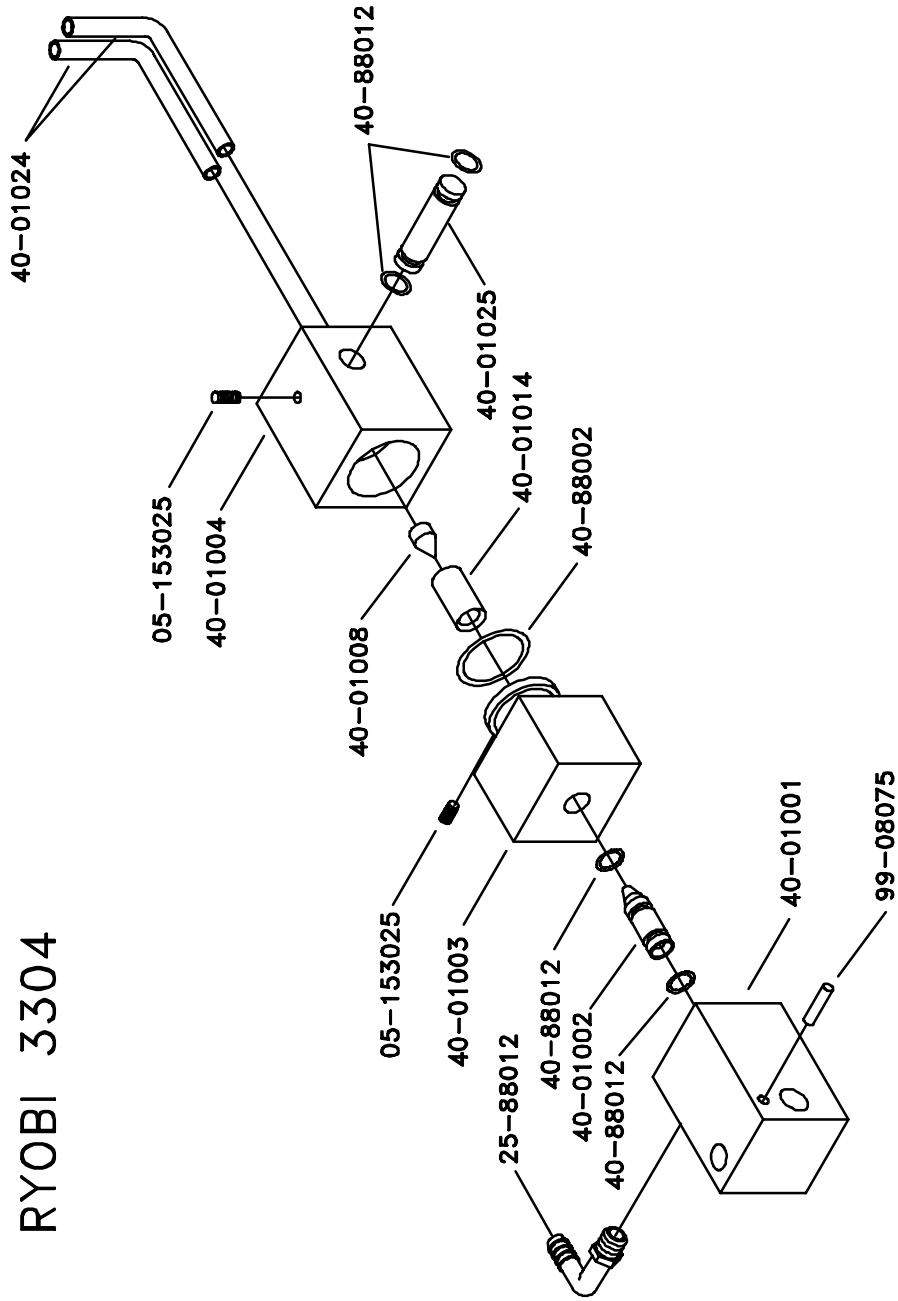

3304P01 9-8-97

RYOBI 3304

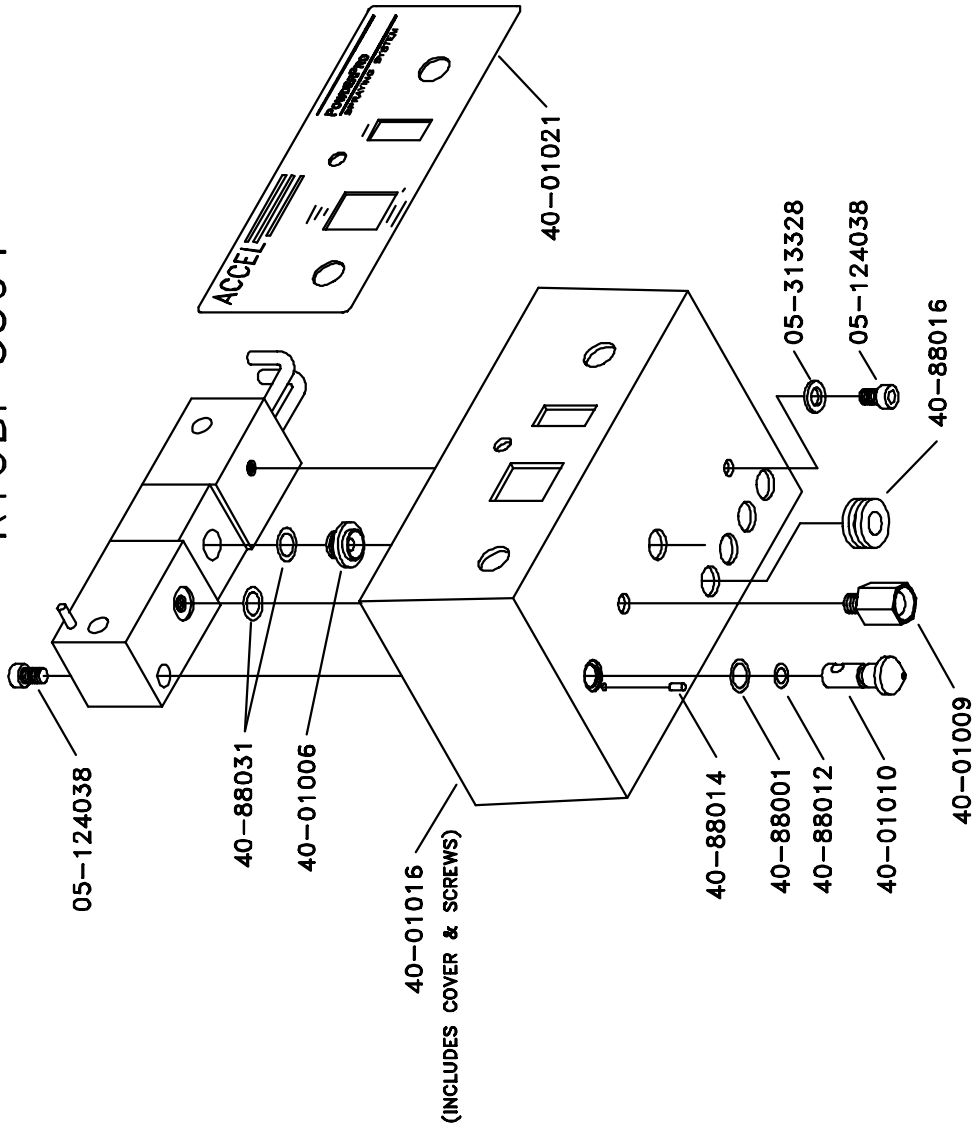

3304P02 9-8-97

RYOBI 3304

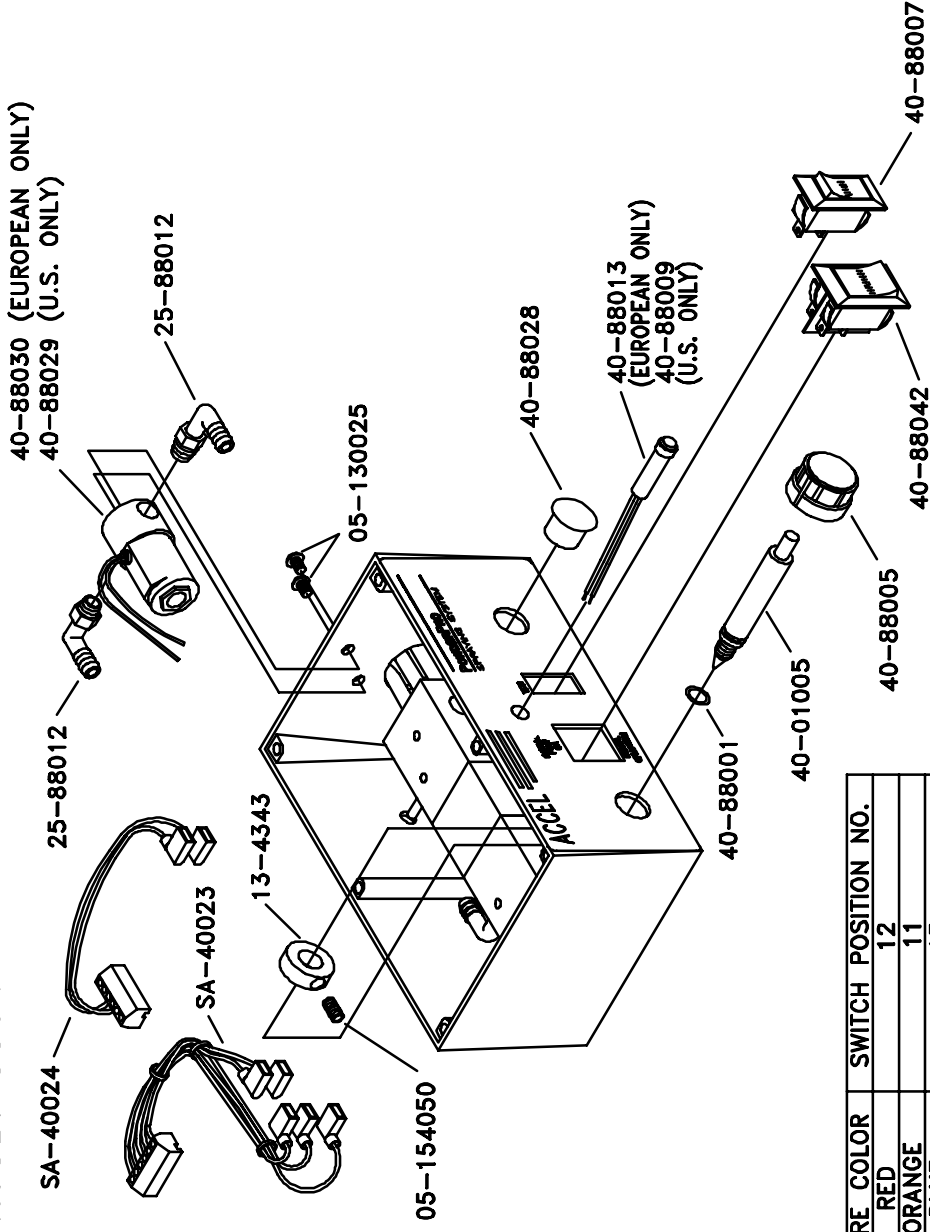

WIRE COLOR	SWITCH POSITION NO.
RED	12
ORANGE	11
BLUE	13
WHITE	24
BLACK	26

3304P03 9-8-97

RYOBI 3304

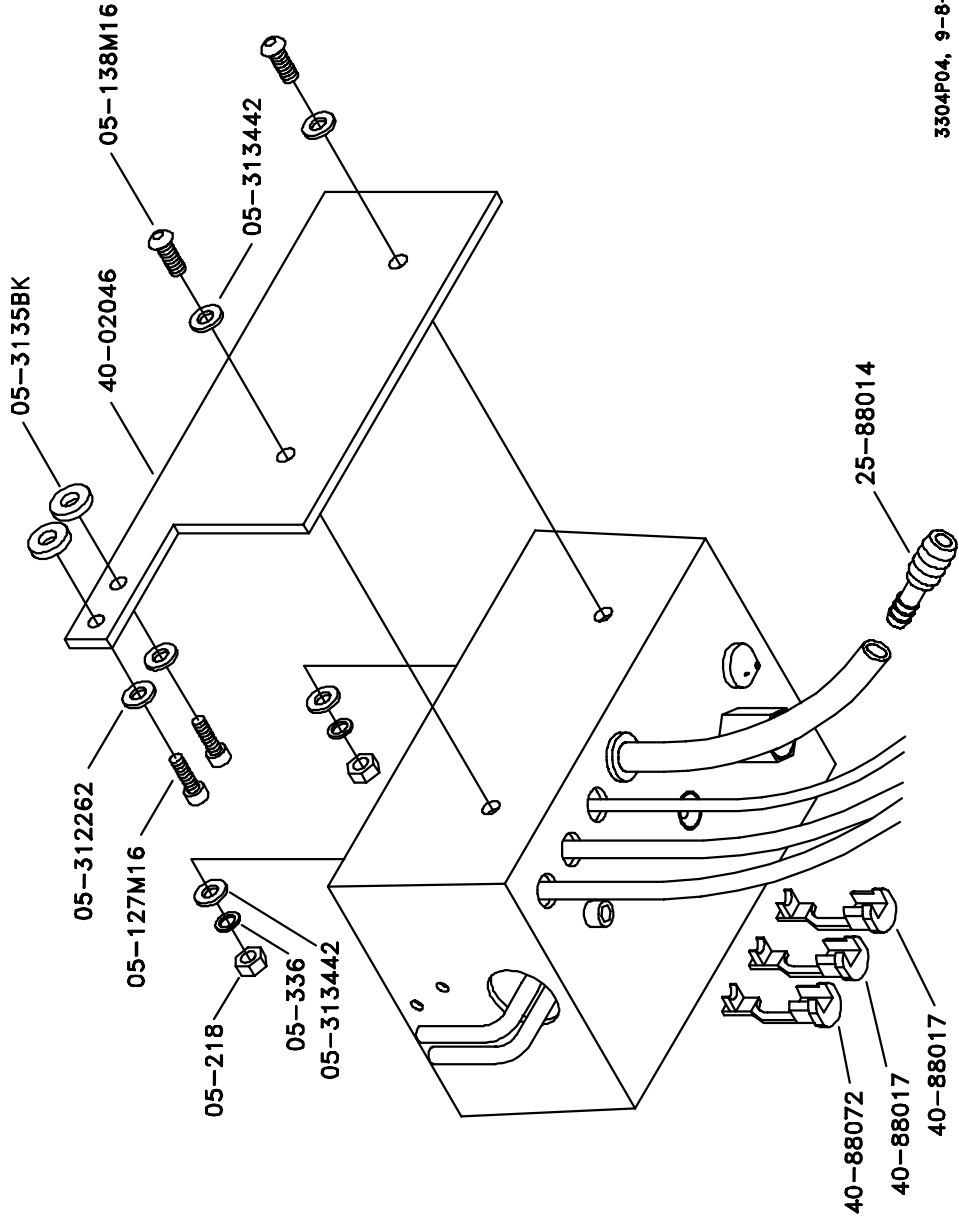

3304P04, 9-8-97

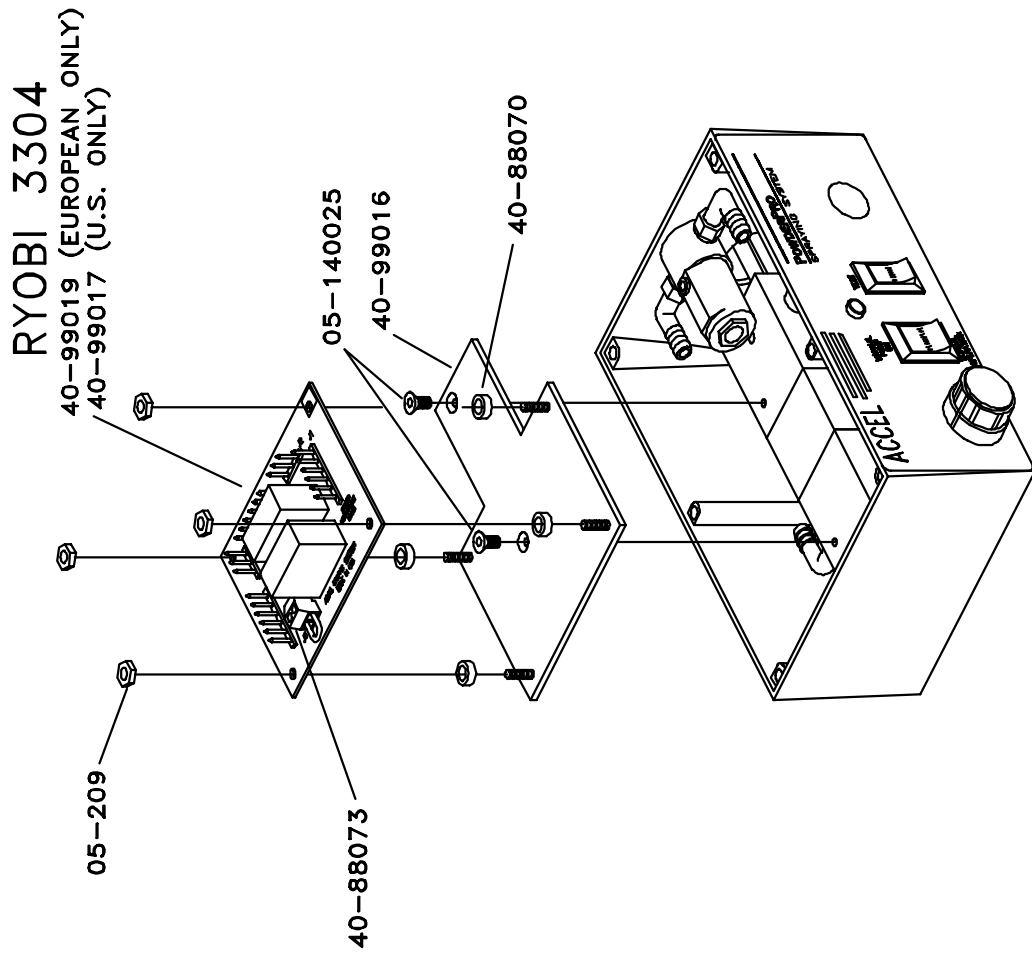

3304P05 9-8-97

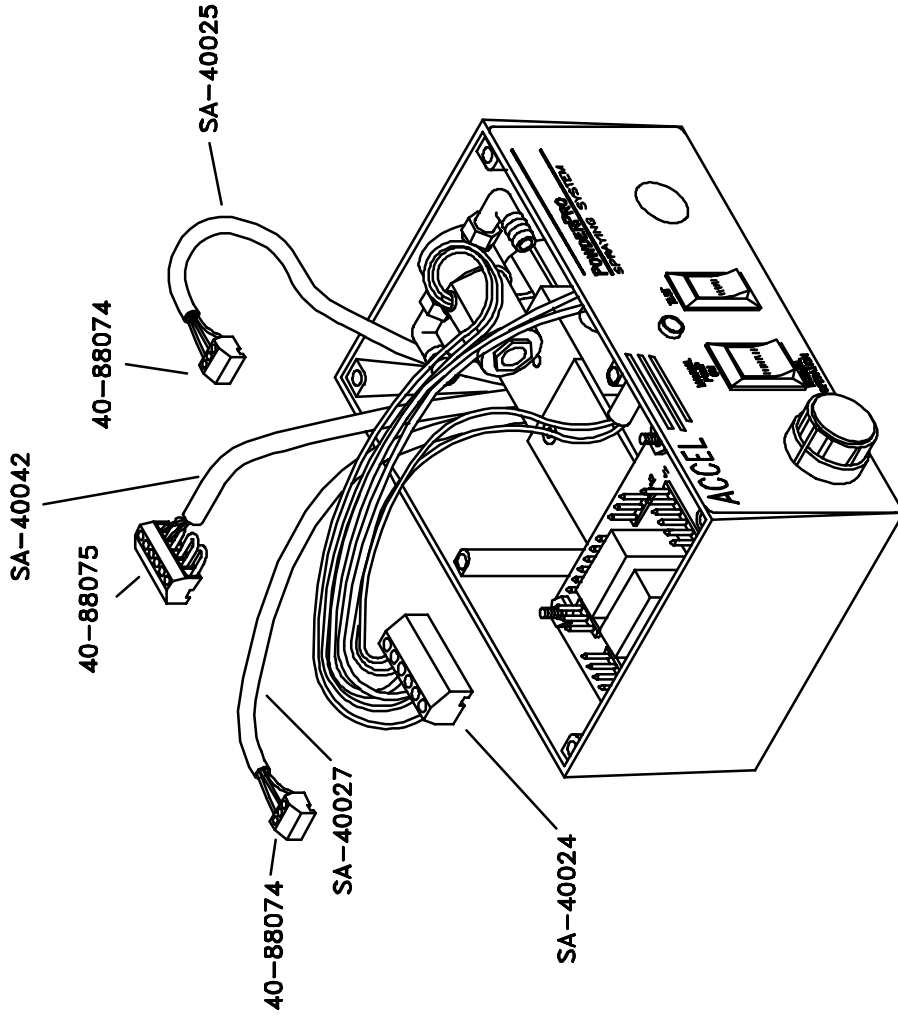

RYOBI 3304

3304P06 9-8-97

RYOBI 3304

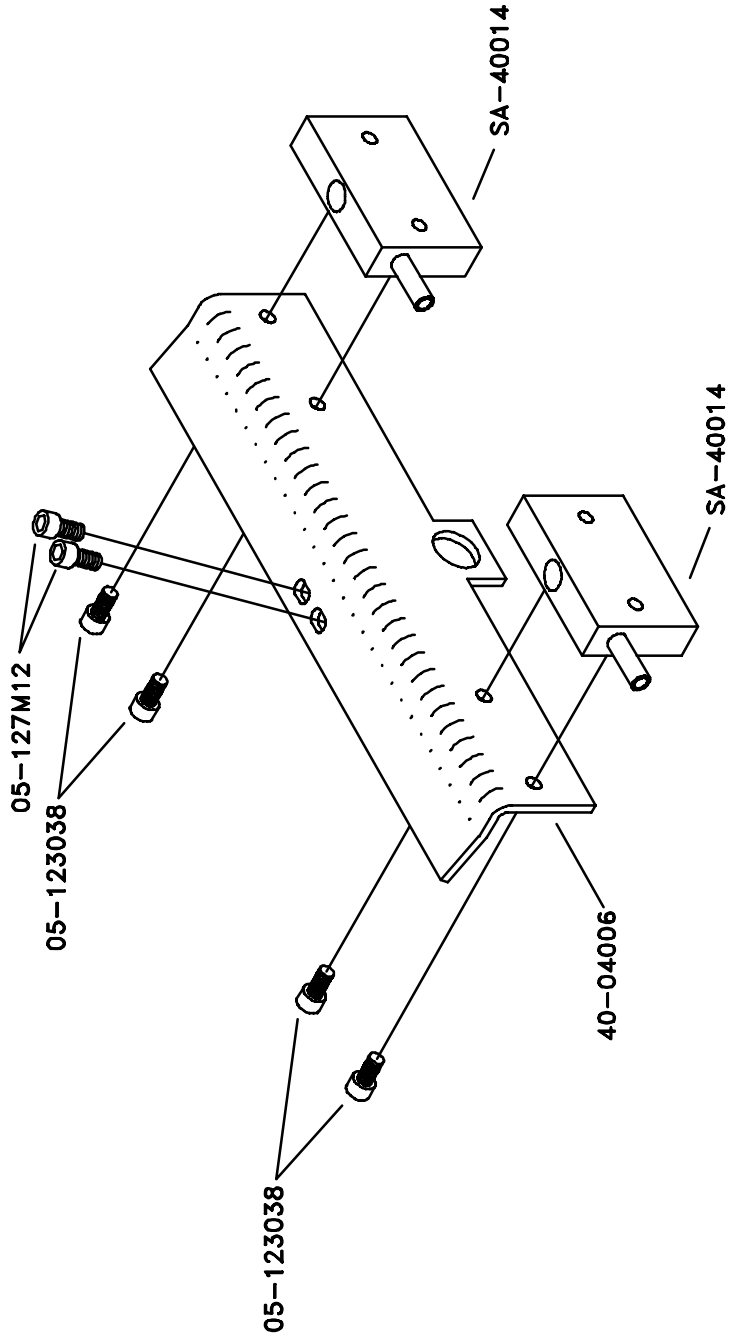

3304P07, 9-8-97

RYOBI 3304

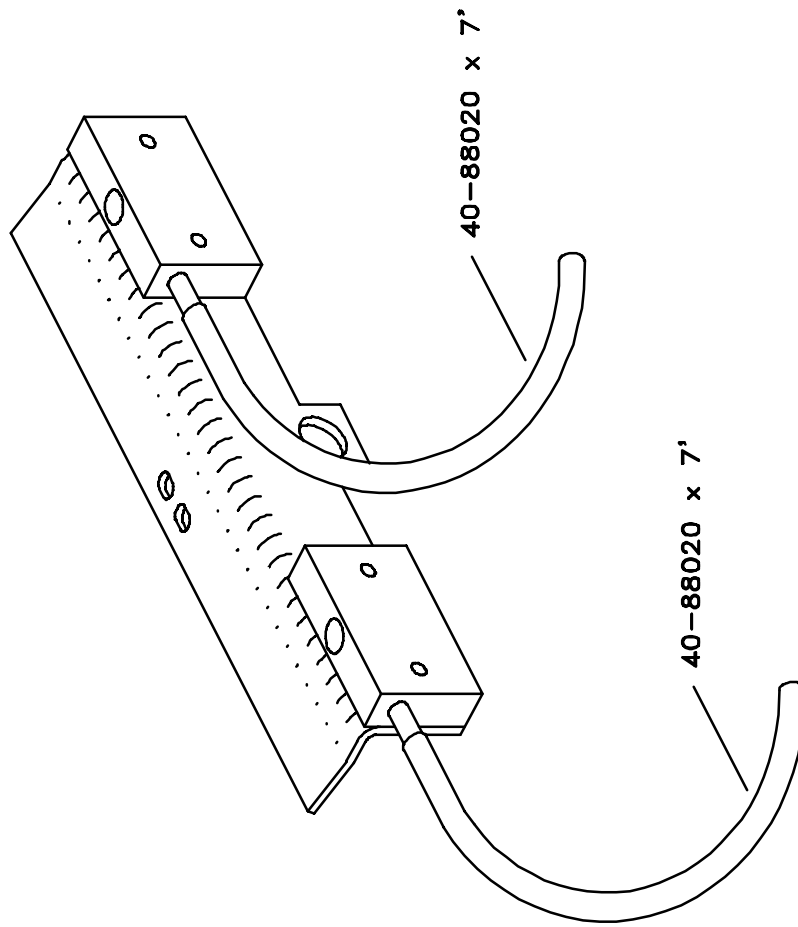

3304P08, 9-8-97

RYOBI 3304

SA-40038 (EUROPEAN ONLY)
SA-40030 (U.S. ONLY)

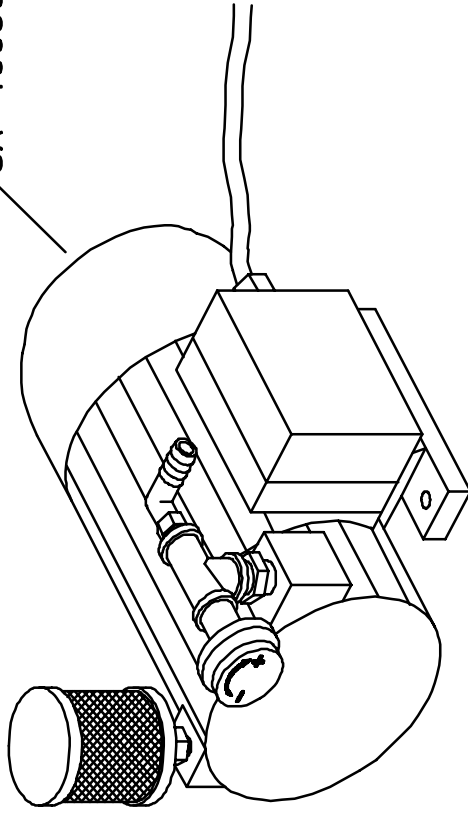

3304P09 9-8-97

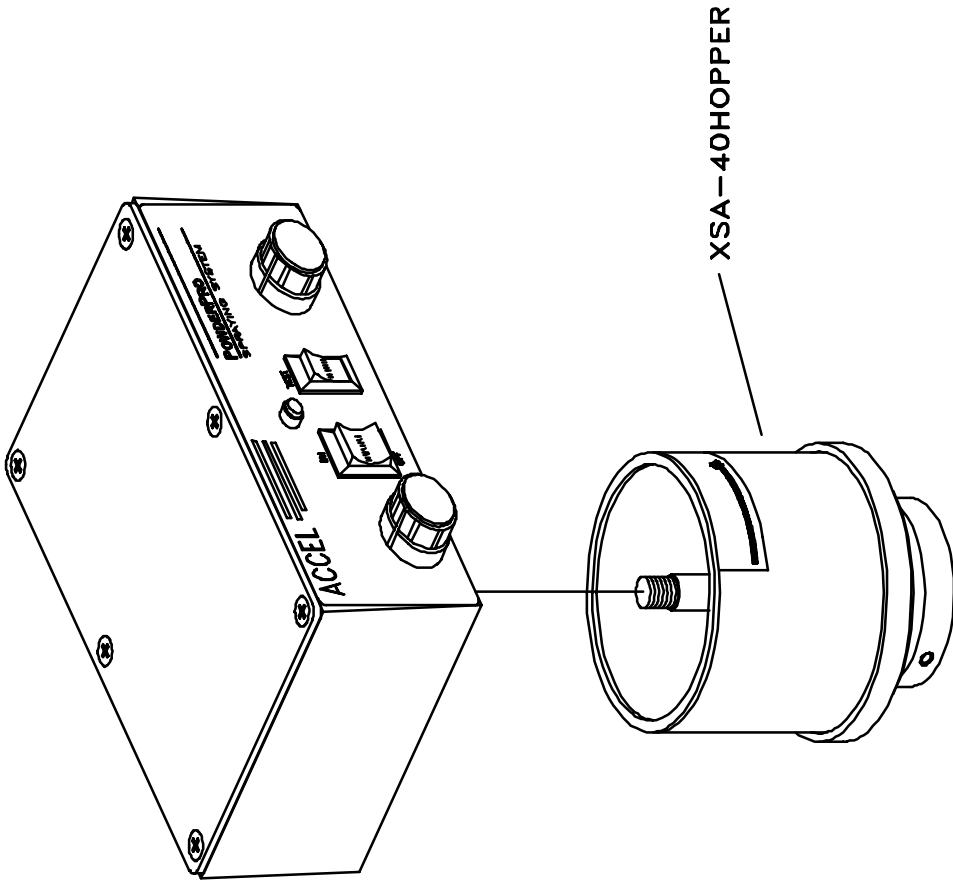

3304P10 9-8-97

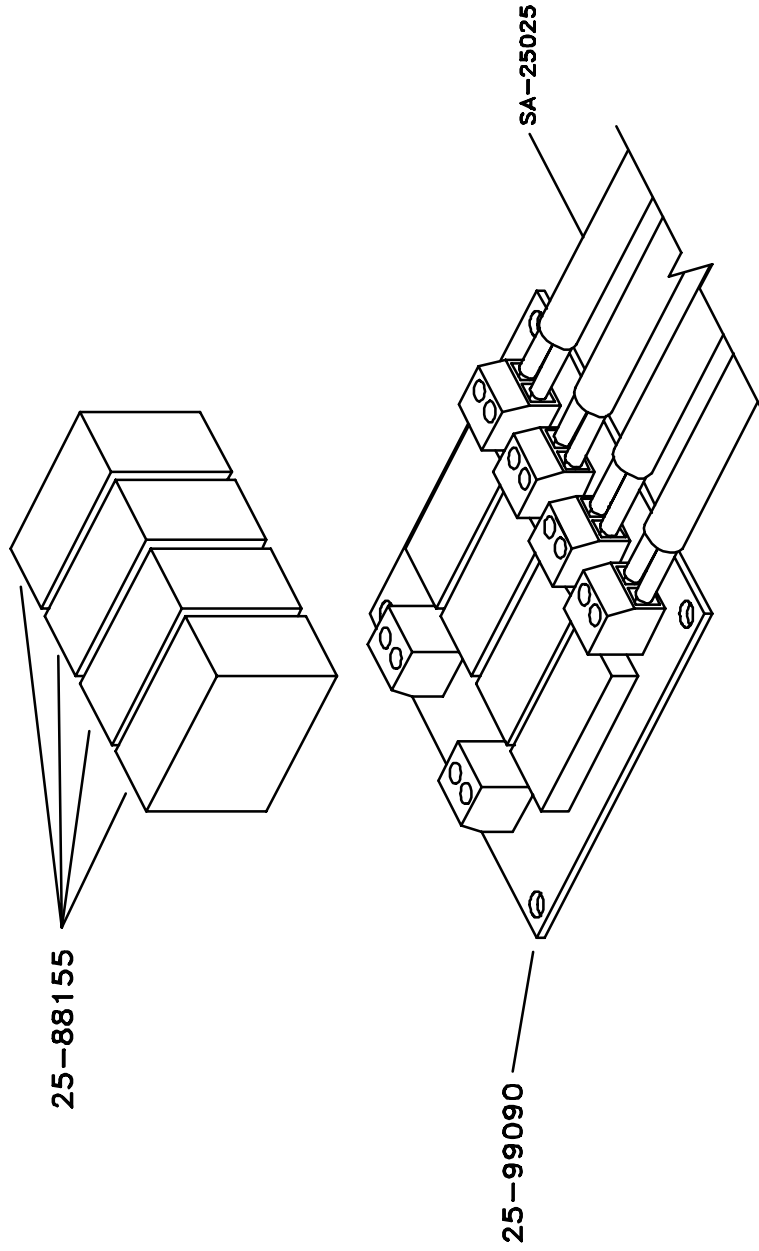

3304P11, 1-15-98

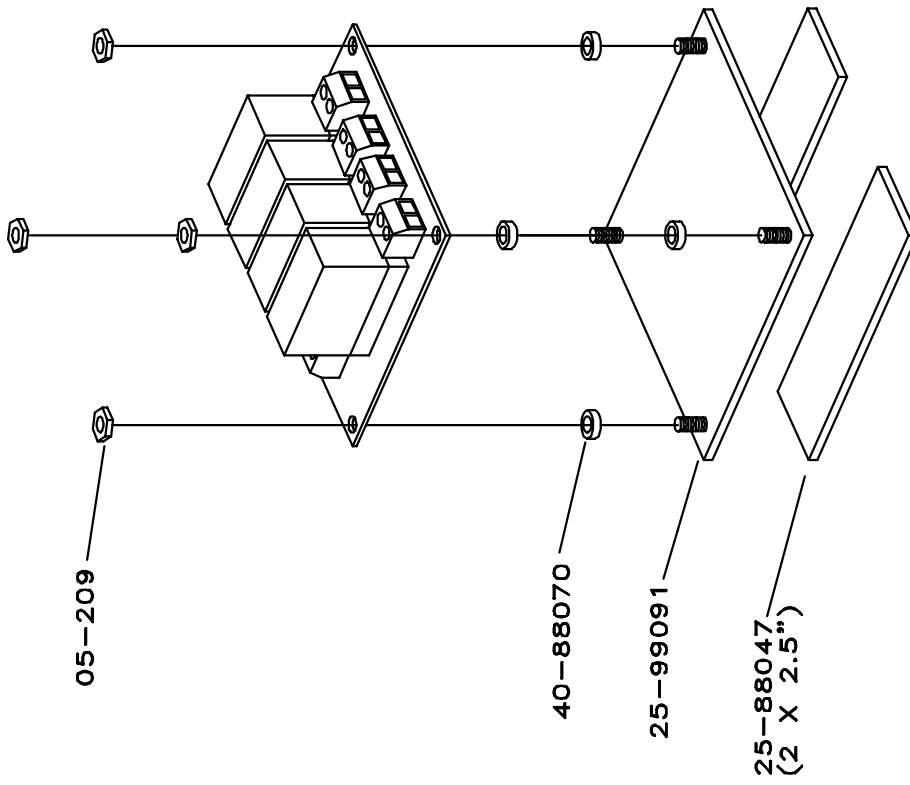

3304P12, 1-9-98

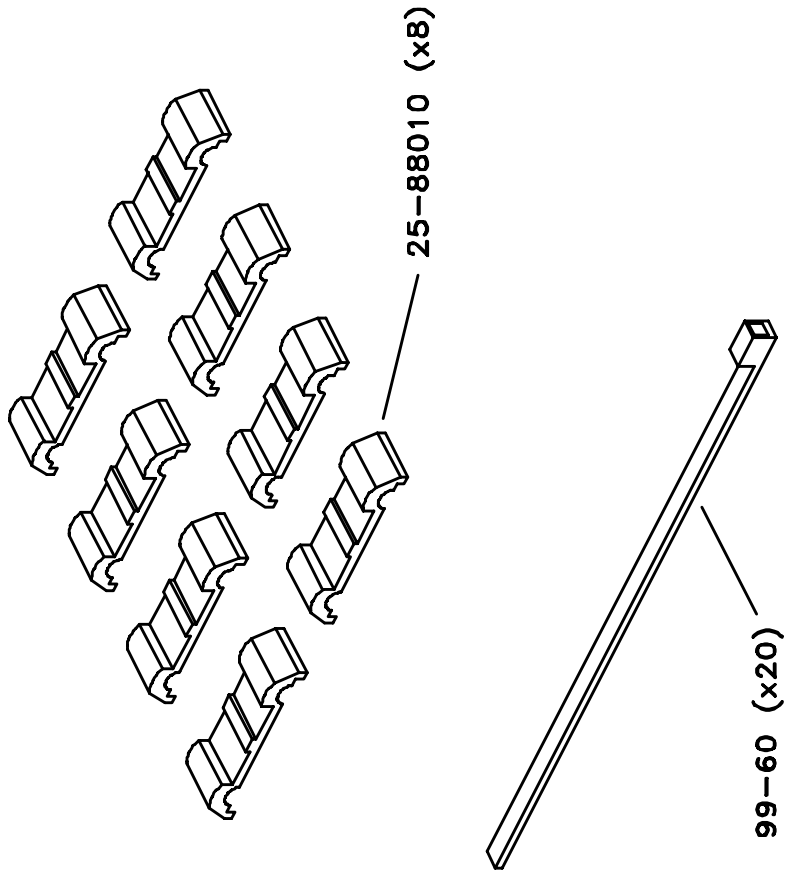

ACCEL ®

Graphic Systems

11103 Indian Trail, Dallas, TX 75229 Phone 972-484-6808, Fax 800-365-6510

E-Mail accel@dallas.net, Web Site www.accelgraphicsystems.com