

# **PowderPro<sup>®</sup> Spraying System**

## **Installation Instructions**

**Heidelberg SORK/SORM/SORD**

**ACCEL**  <sup>®</sup>  
*Graphic Systems*



# GENERAL INFORMATION

**ATTENTION  
POWDERPRO®  
OWNER!**

Accel Graphic Systems provides parts and service through its authorized distributors and dealers. Therefore, all requests for parts and service should be directed to your local dealer.

The philosophy of Accel Graphic Systems is to continually improve all of its products. Written notices of changes and improvements are sent to Accel Graphic Systems' Dealers.

If the operating characteristics or the appearance of your product differs from those described in this manual, please contact your local Accel Graphic Systems Dealer for updated information and assistance.

Always update your equipment when improvements are made available, especially those related to safety.

**YOUR AUTHORIZED POWDERPRO® DEALER IS:**

---

---

---

---

**THE SERIAL NUMBER OF YOUR  
POWDERPRO® IS:**

---

---

For technical assistance, please contact

**ACCEL GRAPHIC SYSTEMS**  
11103 Indian Trail  
Dallas, TX 75229  
(972) 484-6808  
FAX (800) 365-6510  
E-MAIL [accel@dallas.net](mailto:accel@dallas.net)  
WEB SITE [www.accelgraphicsystems.com](http://www.accelgraphicsystems.com)

**PowderPro® is covered by U.S. Patents Pending**

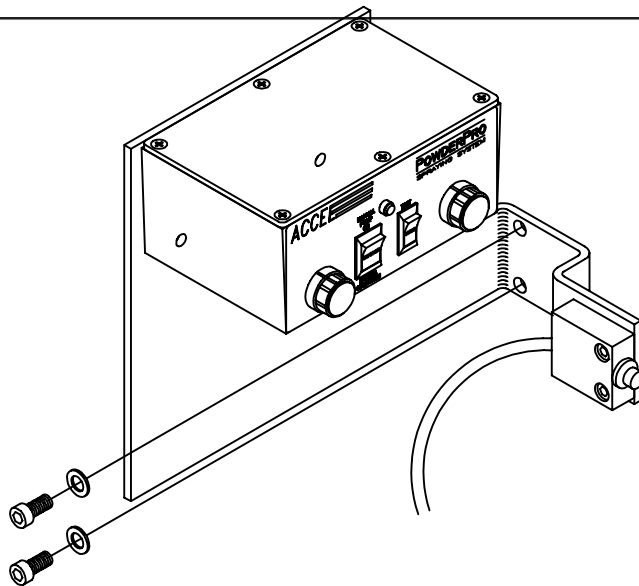

# INSTALLATION

1

Disconnect the electrical power to the press.

2

Remove the original powder spray system from the press including the hopper, pump, valve, and spray bar assembly. **Do not remove** the spray length adjustment cams or its actuation arms. This timing system is used with the PowderPro® spray system

3

Using the provided hardware attach the PowderPro control box assembly to the press as shown in the diagram. Use the same holes in the press frame that the original spray valve mounted to.

5

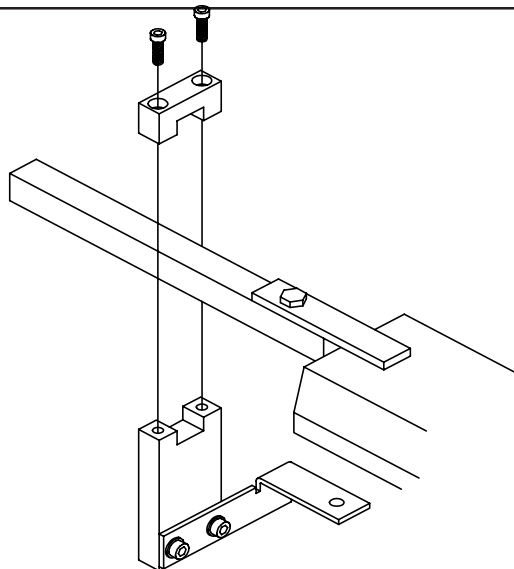
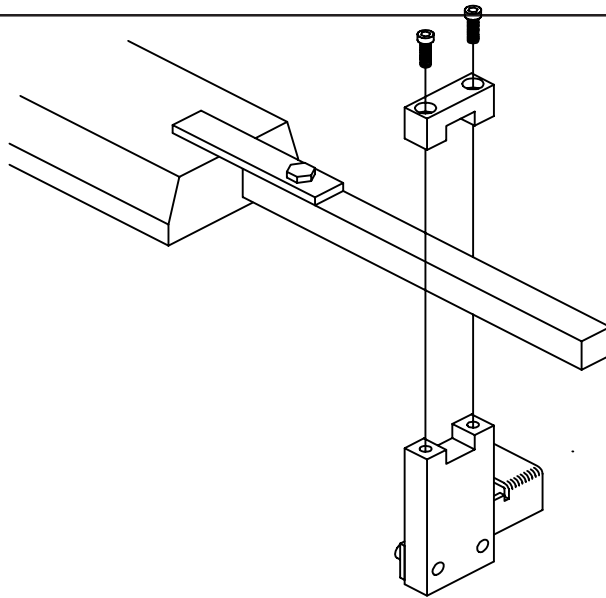
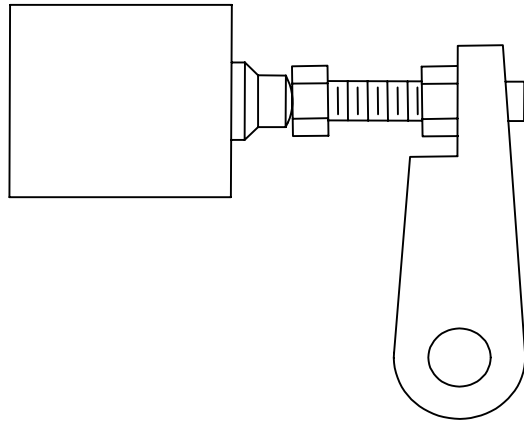

## INSTALLATION

**4**

Adjust the screw on the end of the timing arm so that it is just touching the button on the switch when the timing cam is in the off position.

---

**5**

Attach the provided OPS mounting bracket assembly to the square tie bar in the delivery as shown in the diagram. This square bar is the same bar that the delivery light is attached. Do not tighten the bolts that secure the bracket to the bar at this time as it will be necessary to reposition the bracket in a later step.

---

**6**

Repeat the previous step for the NOPS as shown in the diagram.

**7**

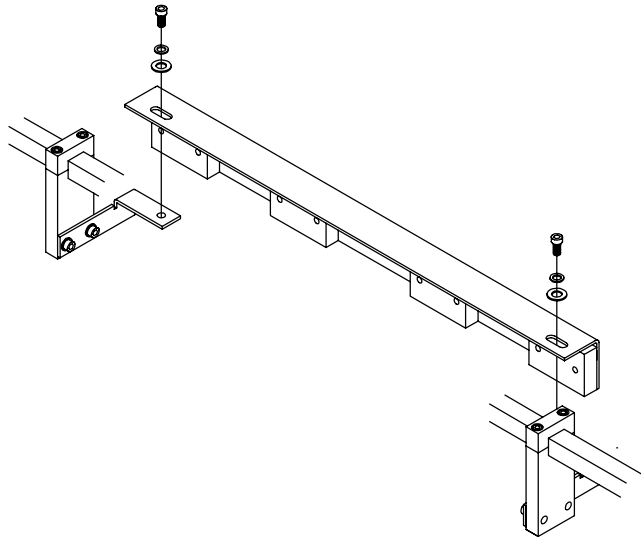

## INSTALLATION

**7**

Using the provided hardware install the PowderPro spray bar assembly to the mounting brackets as shown in the diagram. Route the spray hoses through the same hole in the NOPS press frame that the original spray hose went through. Use the provided zip-ties to secure the hoses as necessary to clear any moving parts in the delivery.

**8**

Connect the hoses from the spray bar to the PowderPro control box. The black hoses must be attached to the lower two tubes coming out the side of the box and the white hoses attach to the upper two tubes.

**9**

Connect the timing switch cable to the four pin connector coming out of the PowderPro control box.

**9**

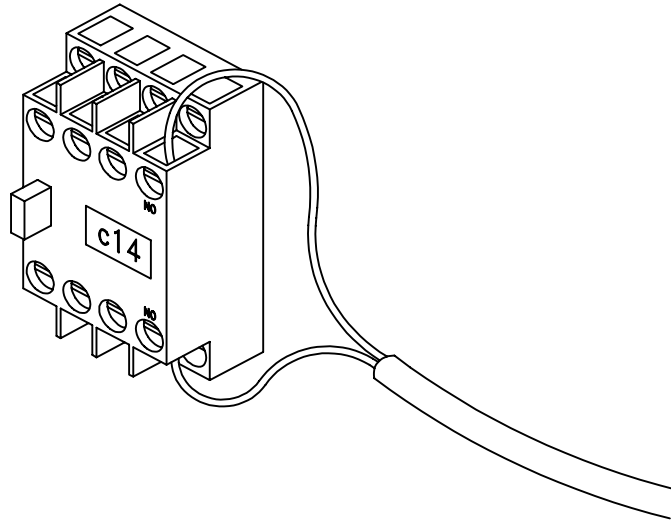

## INSTALLATION

**10**

Connect the impression signal cable (provided loose) to the two pin connector coming out of the control box. Route this cable into the press electrical cabinet. Locate the c14 relay in the cabinet and connect the cable to an open set (not being used by other wires) of normally open contacts on the relay as shown in the diagram. Use the provided zip-ties to secure the cable as necessary.

**11**

Set the provided pump on the floor under the NOPS walkway, near where the original pump was located. Plug the power cable from the pump into the appropriate mating connector coming out of the PowderPro control box. Connect the provided hose from the barbed fitting on the pump to the barbed fitting on the hose coming out of the control box. Use the supplied zip-ties to secure any loose cable or hose as necessary.

**12**

Plug the PowderPro power cord into a standard 110 VAC outlet. The PowderPro will draw a maximum of three amps.

Proceed to the next section "Operation & Maintenance" section for proper pump adjustment and operation.

**11**

## OPERATION & MAINTENANCE

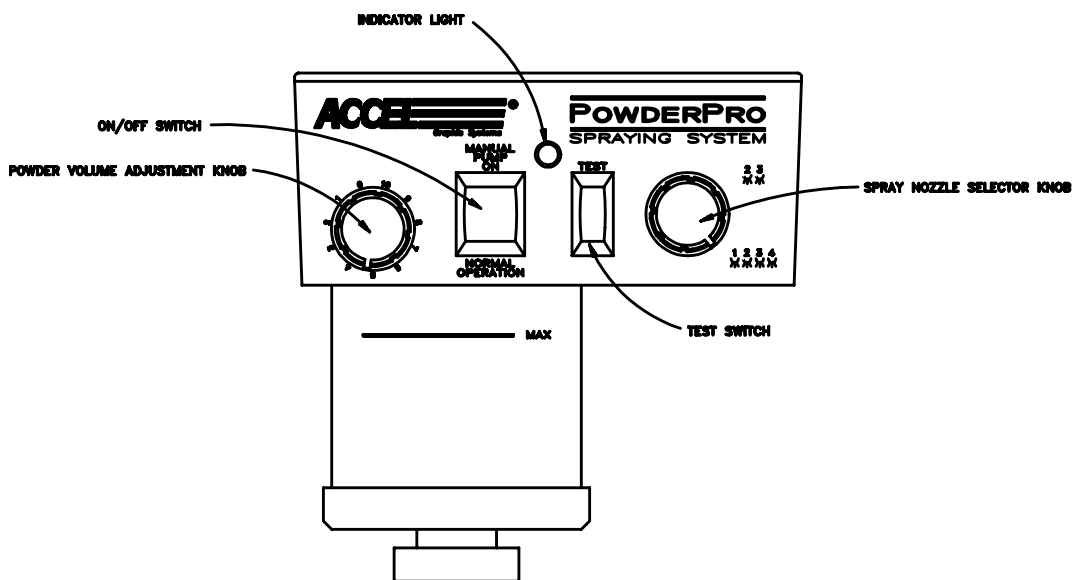

### POWDER PRO CONTROLS

#### VOLUME ADJUSTMENT KNOB

Adjusts the amount of spray powder with "0" the minimum and "10" the maximum.

#### ON/OFF SWITCH

When switched to "Manual Pump On" the pump will come on for setting spray powder volume. When switched to "Normal Operation" the system is armed and sprays only when the press goes on impression.

#### INDICATOR LIGHT

This light is illuminated only when the unit is actually spraying. The light goes on and off as sheets pass under the spray nozzles.

#### TEST SWITCH

Use this switch for setting powder volume when not printing. With the "On/Off" switch set to "Manual Pump On," push the test switch to visually see the amount of powder being sprayed. Adjust if necessary.

#### NOZZLE SELECTOR KNOB

This knob lets you control which spray nozzles are being used. For maximum width sheets, set the selector to the lower position. This setting sprays all four nozzles. For narrow sheets (generally 11" wide or less), set the selector to the upper position. This setting sprays only the center two nozzles.

## OPERATION & MAINTENANCE

### PUMP ADJUSTMENT

Powder volume range is adjusted by the outlet pressure of the pump. Locate the adjustment knob on the pump near the outlet hose. Loosen the locking knob and turn the adjustment knob clockwise to increase the pressure for more powder. Turn the knob counter clockwise to decrease pressure for less powder. Set the correct pump pressure as follows:

1. Turn the pump on by switching the large switch on the PowderPro® control box to the "Manual Pump On" position.
2. Set the nozzle selector knob on the PowderPro® control box to "4".
3. Set the powder volume adjustment knob to "10".
4. Hold the "Test" switch "On" while looking at the spray nozzles in the delivery.
5. Have someone slowly adjust the pressure on the pump until the powder is barely visible. A powder setting of "10" with visible powder in the delivery is more than enough powder. Consequently, a setting of "5" results in no visible powder but sufficient powder for most jobs.

*If powder is visible at the "5" setting than too much powder is being sprayed. Return to step 3 and reset the pump.*

6. Tighten the locking knob on the pump adjustment.

### INITIAL SETTINGS

The initial setting for the powder volume adjustment on an average job is "5". If more powder is required than is available at a setting of "10" you need to adjust the pump. If less powder is required than is available at a setting of "0" you also have to adjust the pump. So that you have a wide range of powder volume adjustment available for different jobs you want your "normal" setting for average jobs to be somewhere in the range from "4" to "6", otherwise you need to adjust the pump.

## OPERATION & MAINTENANCE

### MAINTENANCE

1. Clean the filter on the pump once a week, blowing it clean with compressed air.
2. Remove powder that may accumulate on the bottom of the spray nozzles daily.
3. Never use solvents containing oil when cleaning any part of the sprayer.
4. Use compressed air only if your compressor is equipped with a proper in-line dryer. Otherwise, use canned air. Moisture in the sprayer affects its performance.

### OPERATION

1. Fill the powder hopper with an intermediate grain (20-25) powder (such as **SP25**, available from Accel) up to the "MAX" line on the hopper.
2. Place the On\Off switch to the "Normal Operation" position.
3. Place the original spray ON/OFF switch to the "ON" position.
4. Consider the sheet width and if necessary change the spray nozzle selector knob. When switching from four to two nozzles reduce the total amount of powder being sprayed by turning the powder volume adjustment knob to a lower number.
5. The spray length is controlled by the original adjustment mechanism.
6. Adjust the powder volume adjustment knob if necessary.
7. The sprayer operates automatically when the press goes on impression and a sheet is present under the spray nozzles.

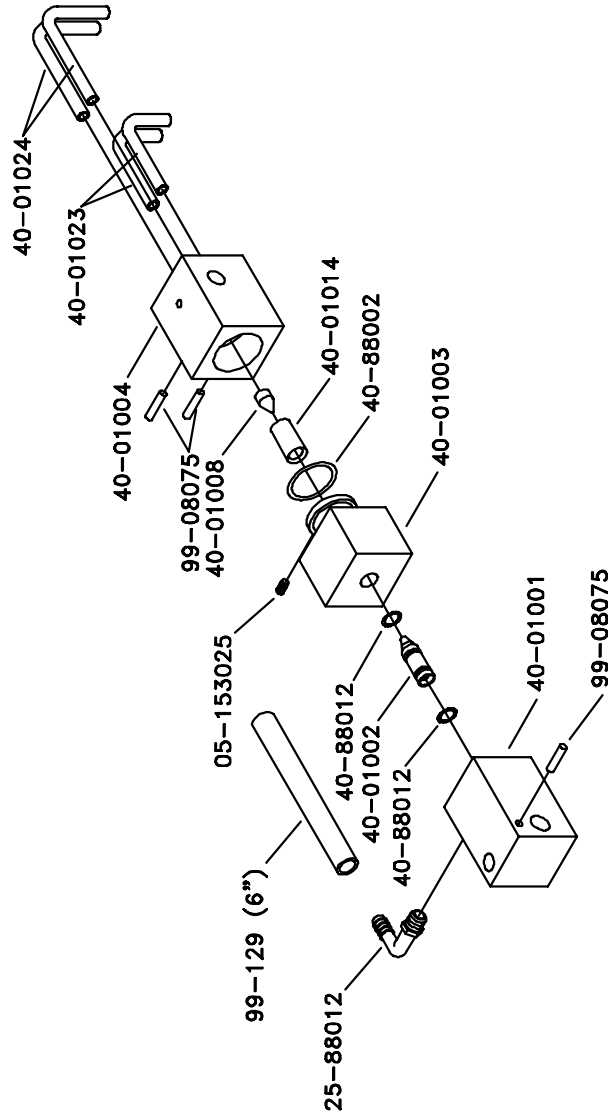

SORP01, 8-27-97

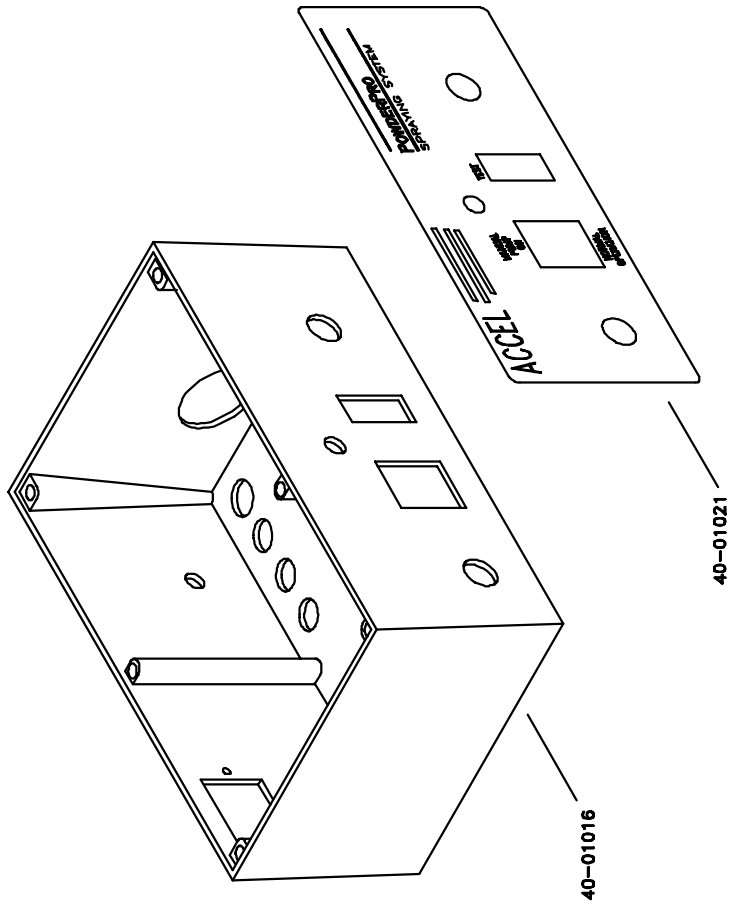

SORF02, 8-27-97

WIRE COLOR	SWITCH POSITION NO.
RED	12
ORANGE	11
BLUE	13
WHITE	24
BLACK	26

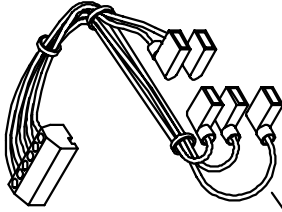

SA-40031

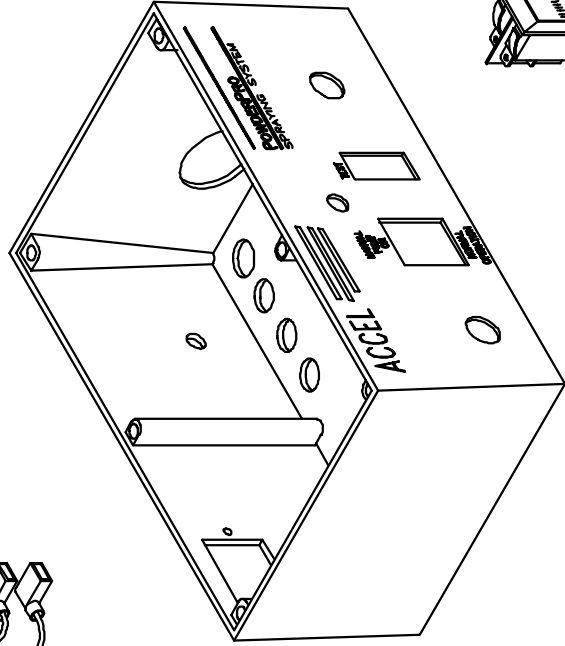

40-88042



SOP03, 8-27-97

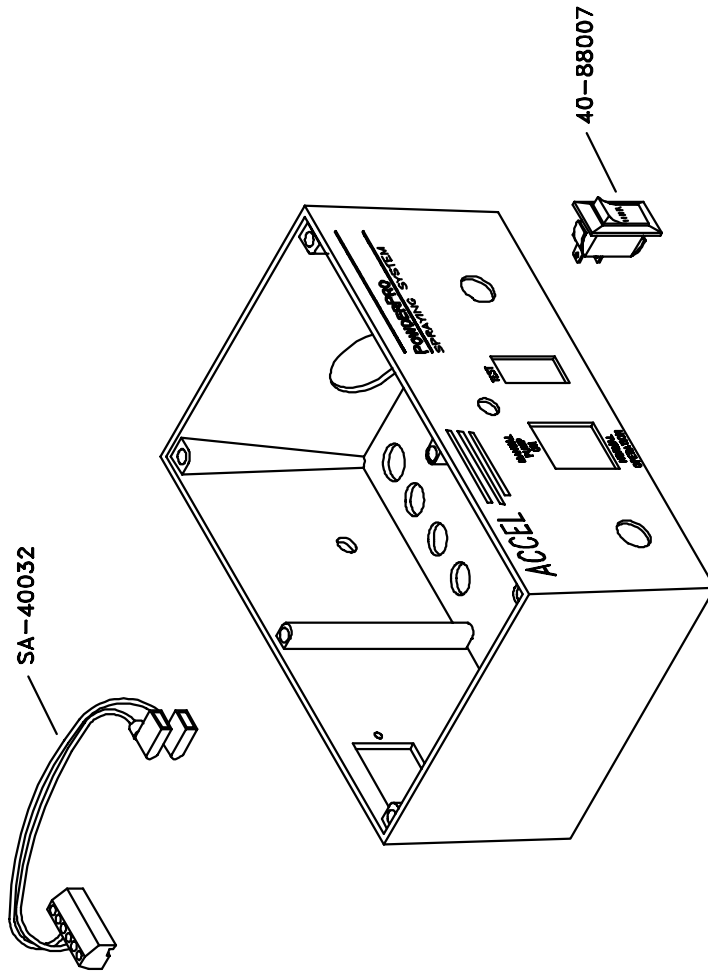

SURPO4, 8-27-97

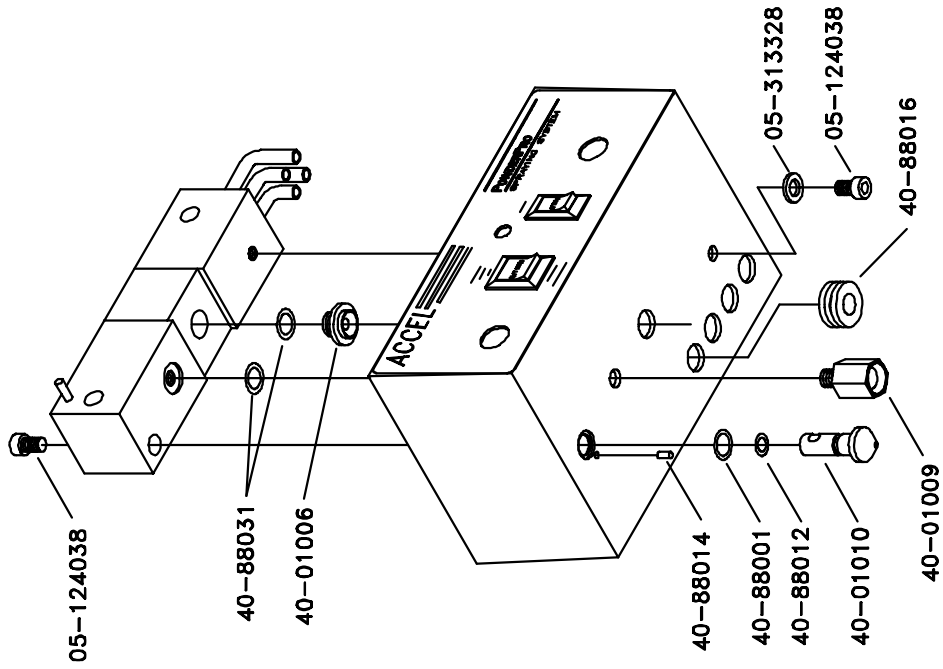

SORP05, 8-27-97

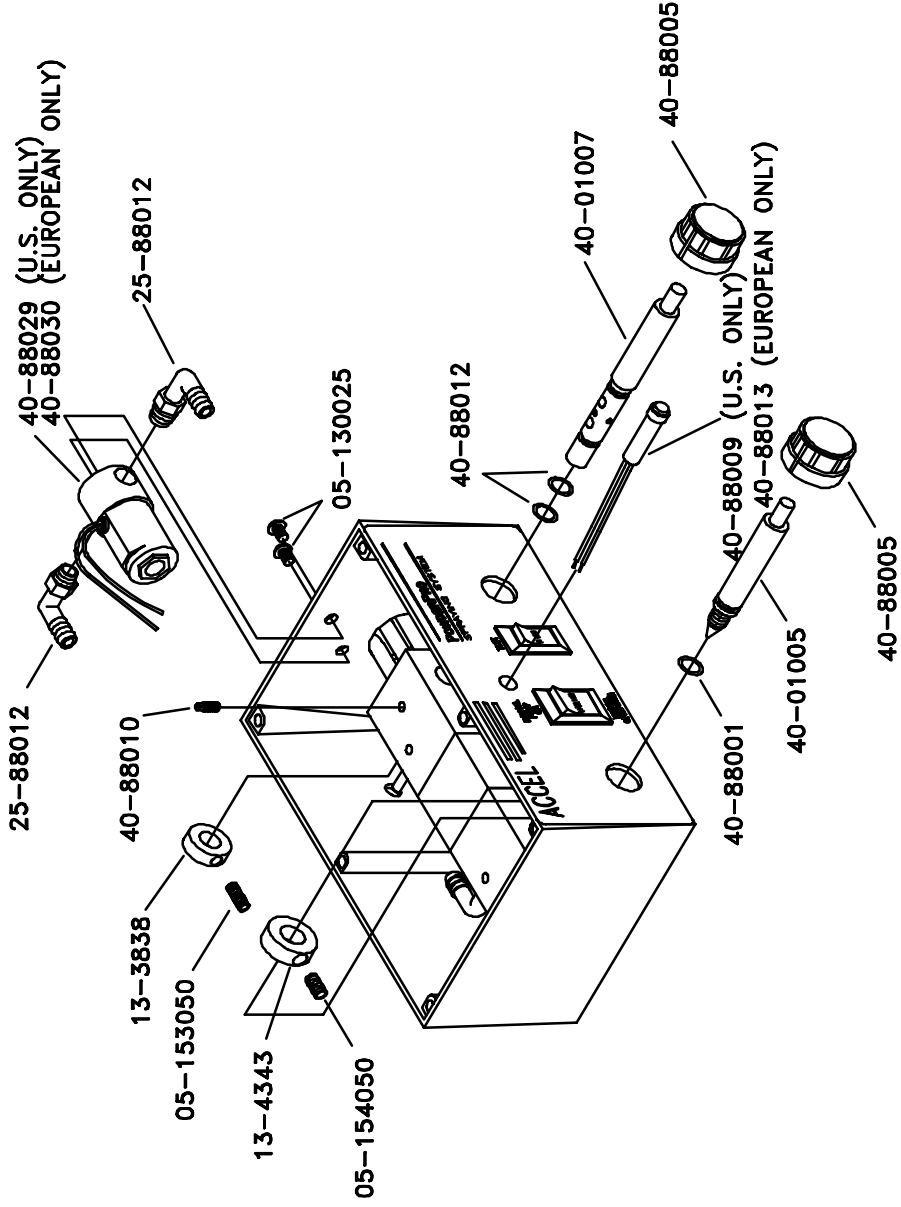

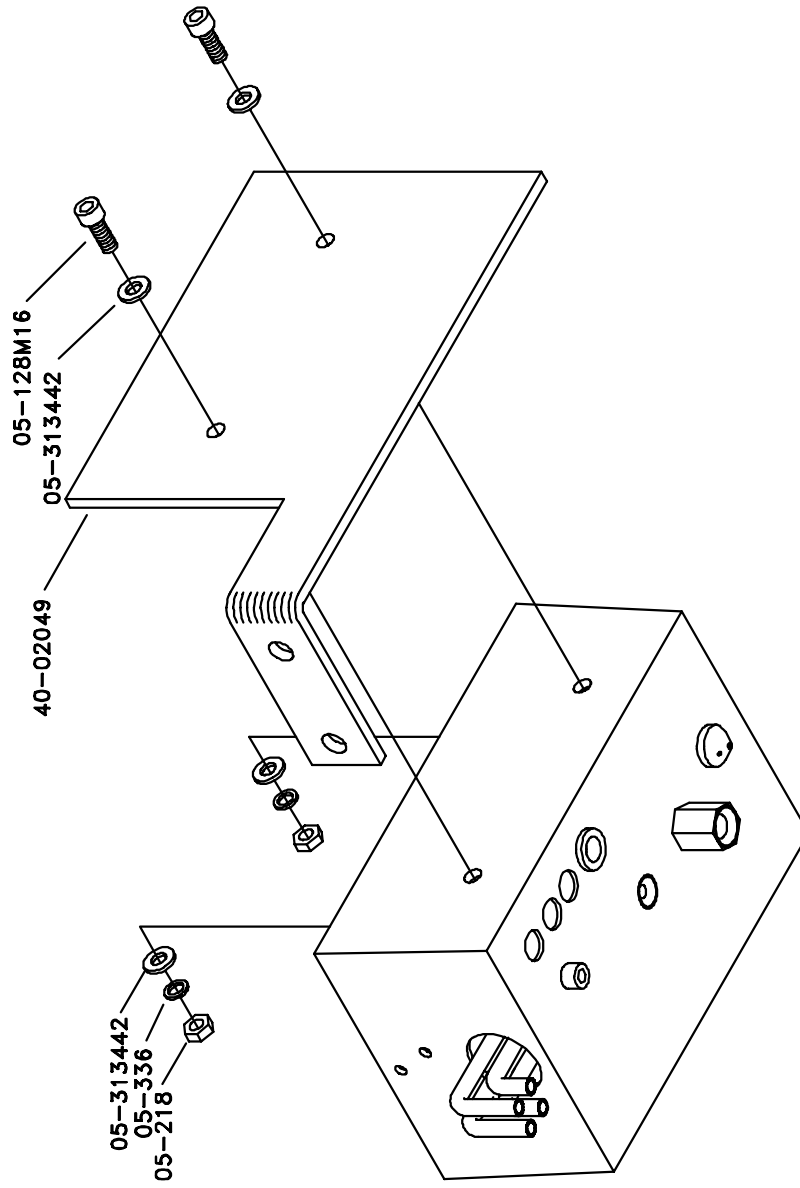

SURP07, 8-27-97

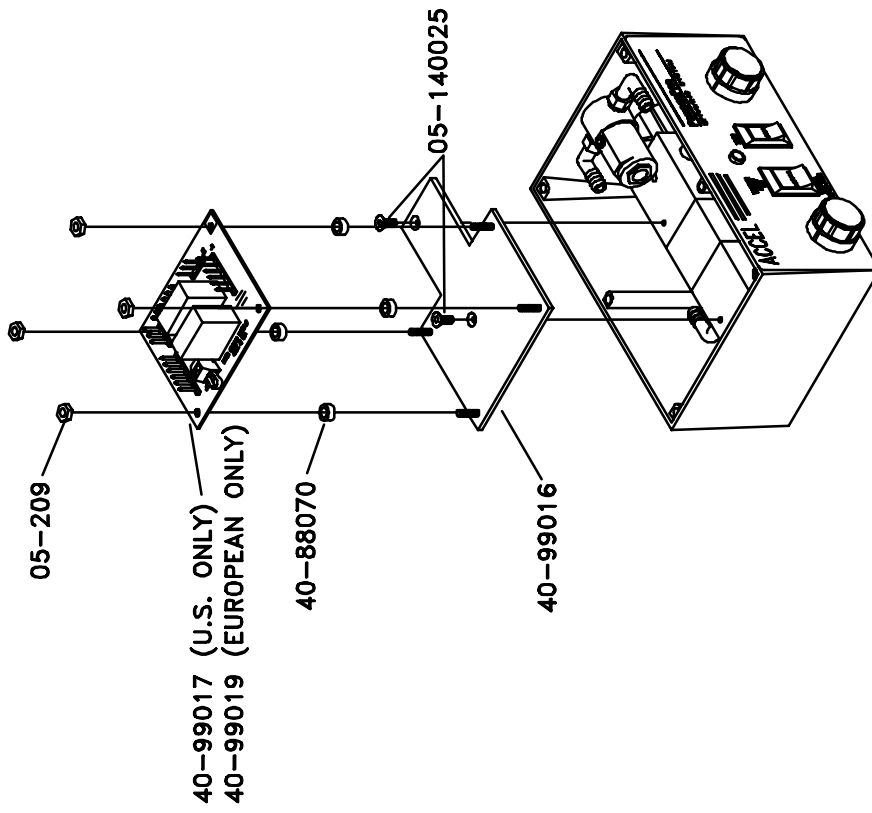

SORP08, 11-4-97

3 POSITION CONNECTOR	
POSITION NO.	WIRE COLOR
1	GREEN
2	BLACK
3	WHITE

40-88025 (U.S. ONLY)  
SA-40057 (EXPORT ONLY)

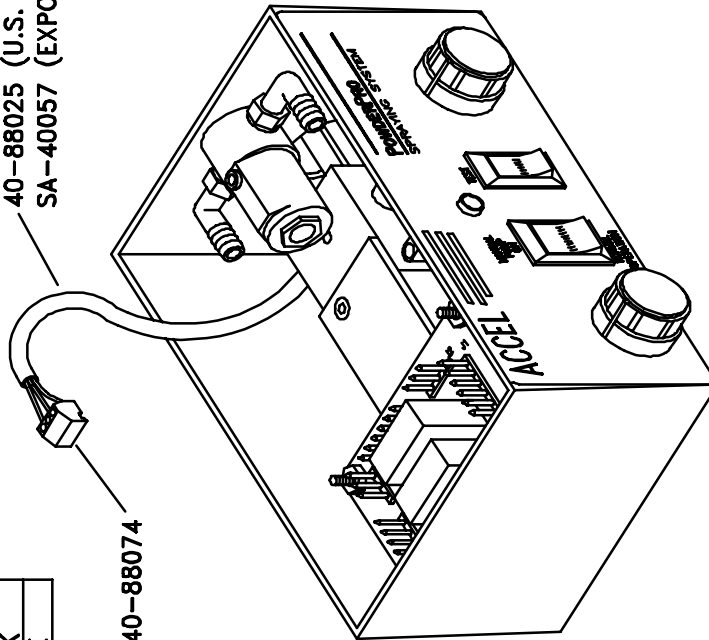

40-88074

SORPOS, 8-27-97

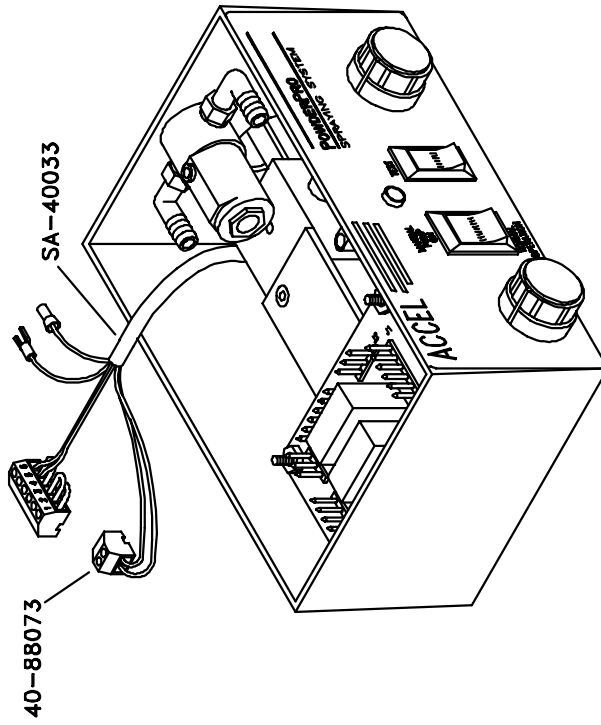

SORP11, 8-27-97

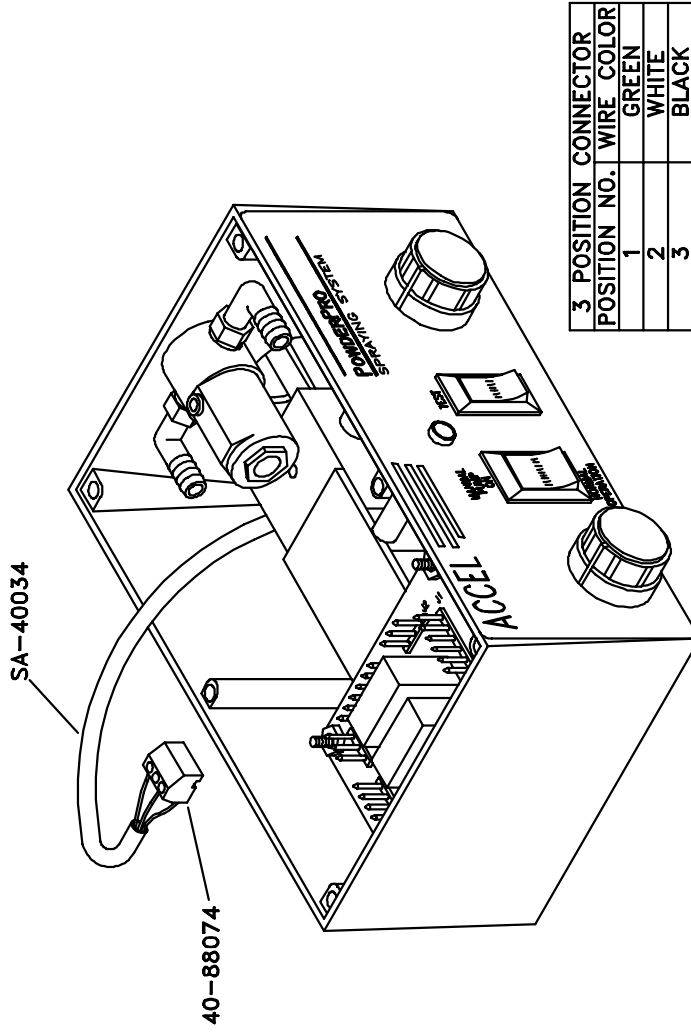

SORP12, 8-27-97

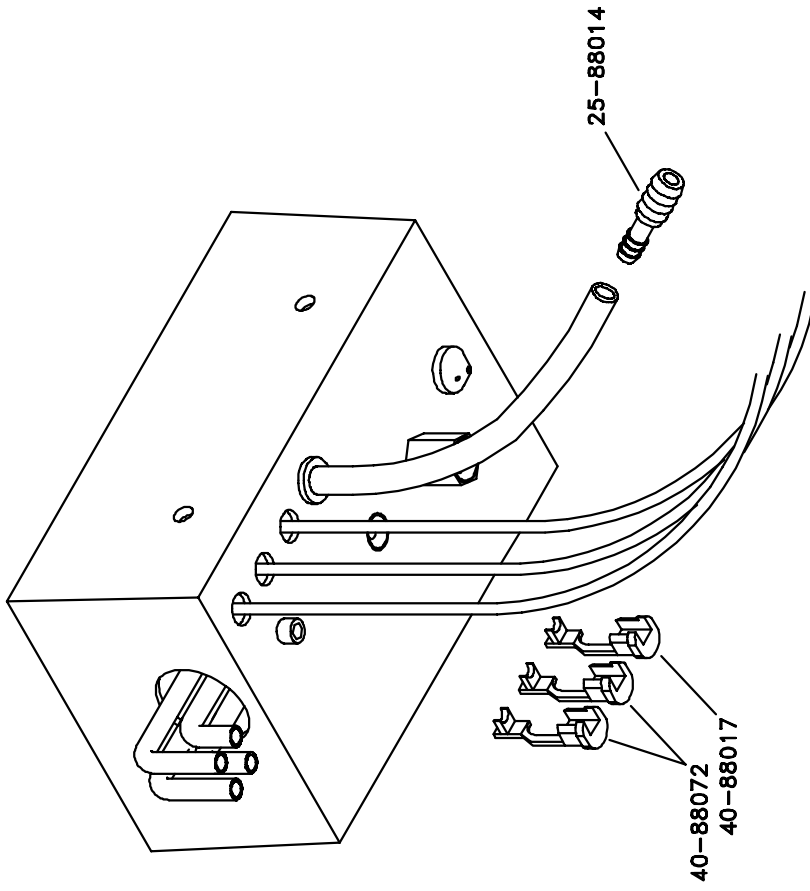

SORP14, 8-27-97

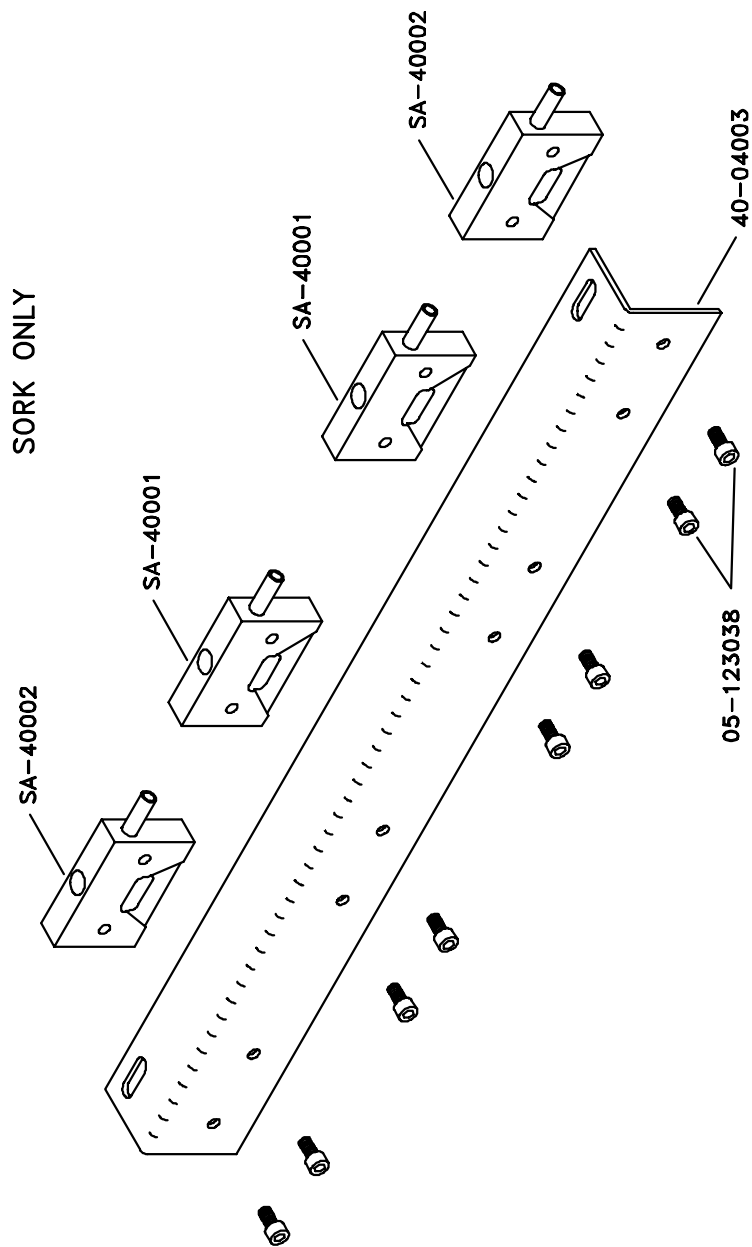

SORP15, 8-27-97

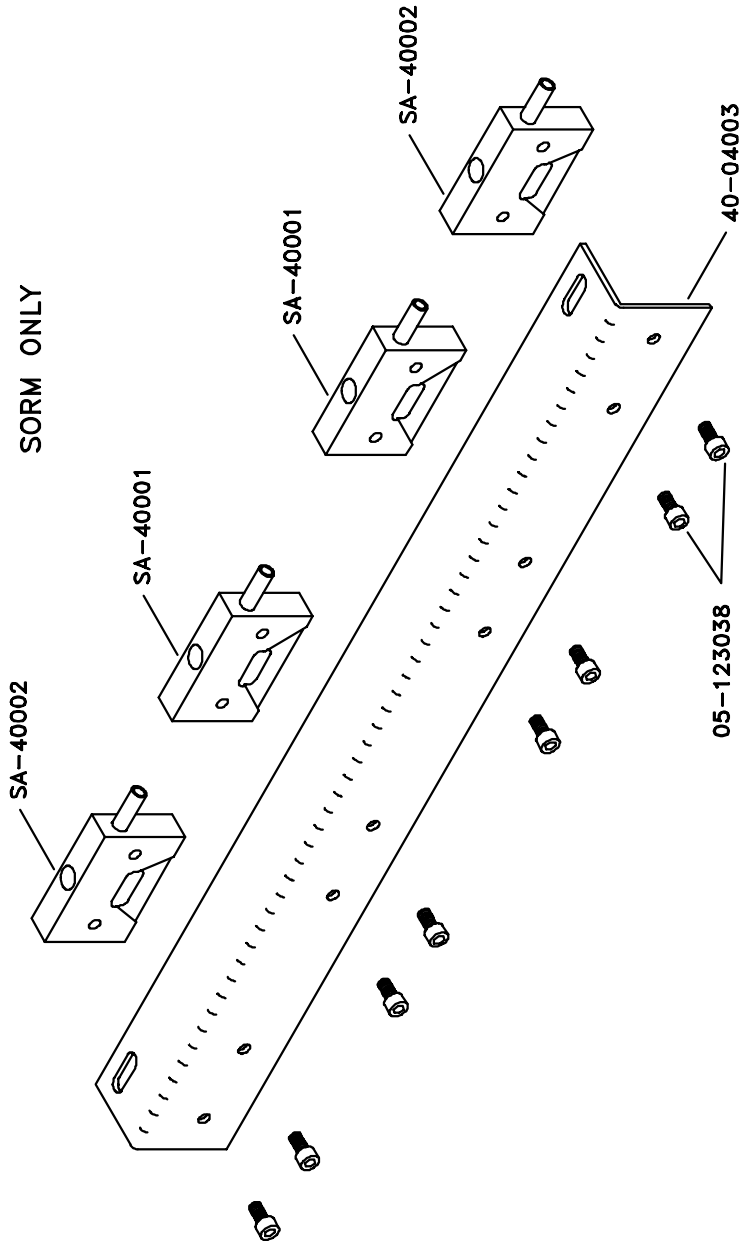

SORP15, 8-27-97

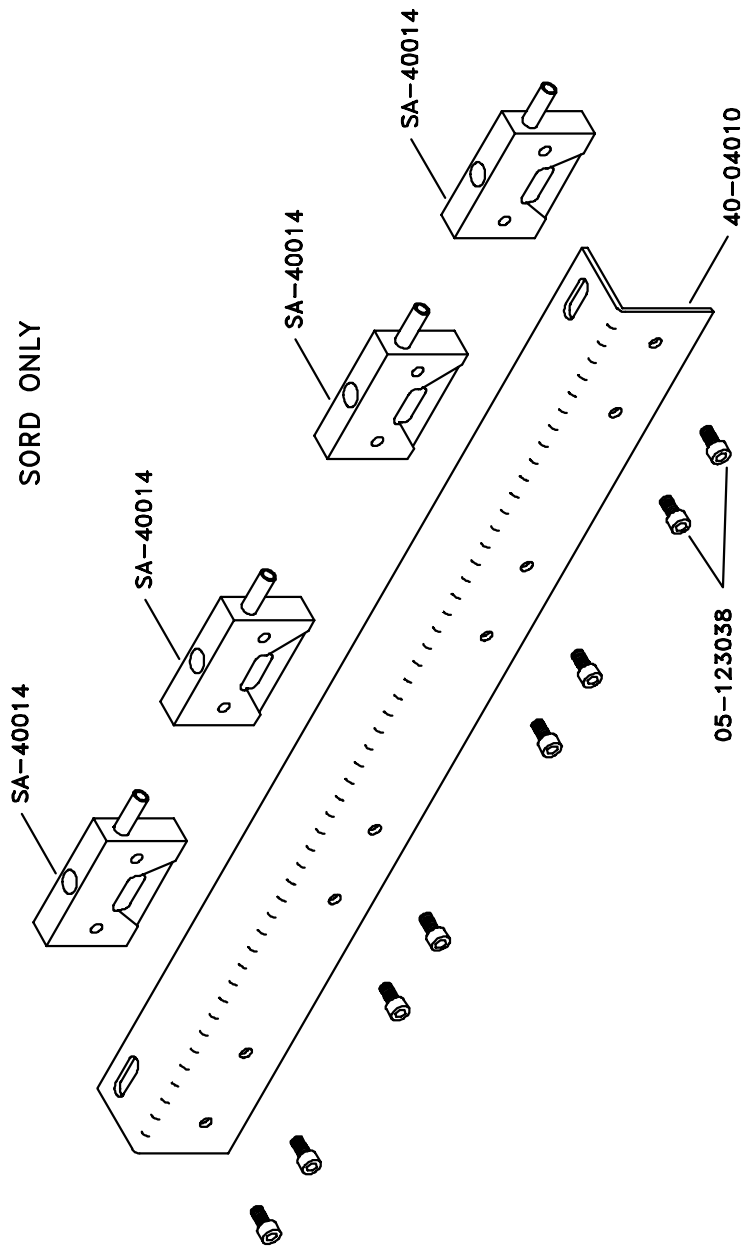

SORP22, 8-27-97

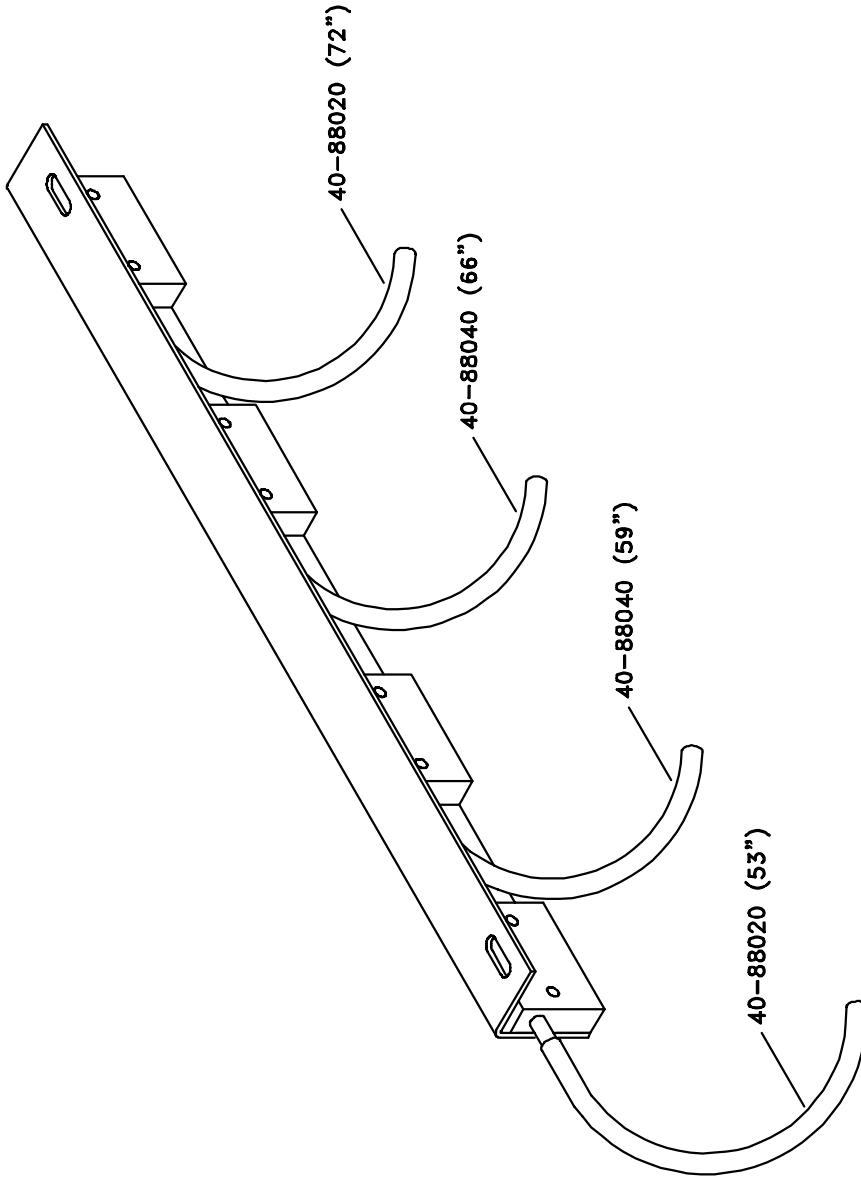

SORP16, 8-27-97

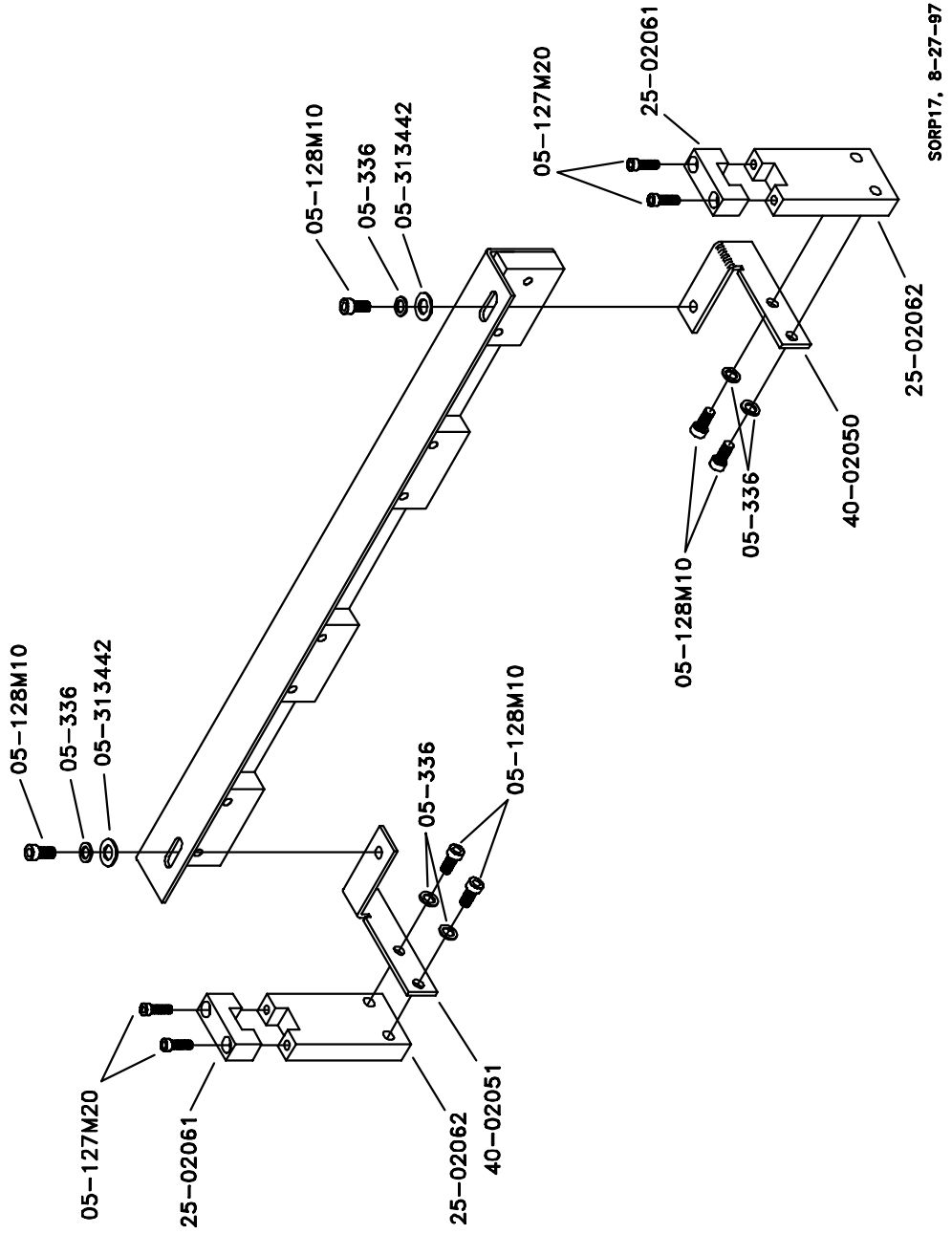



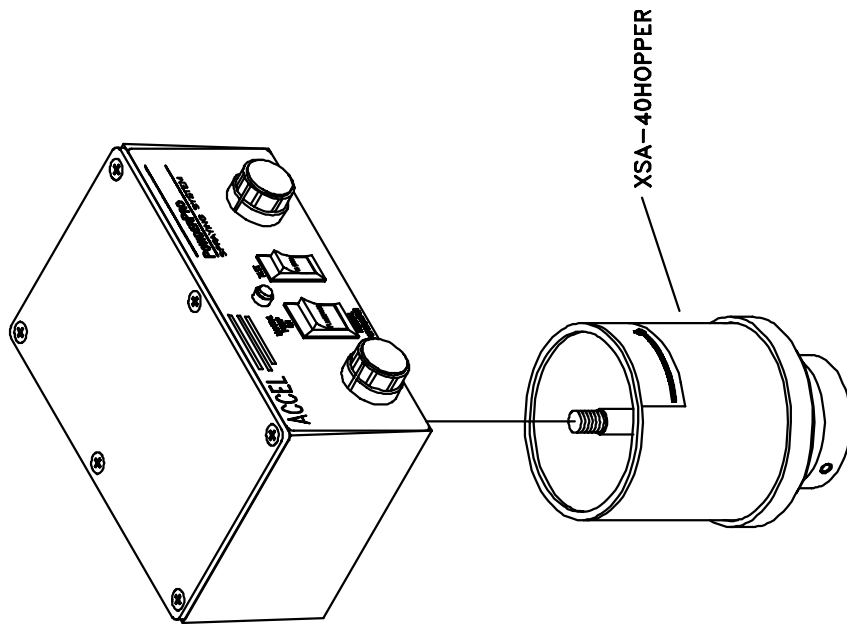

SORP19, 8-27-97

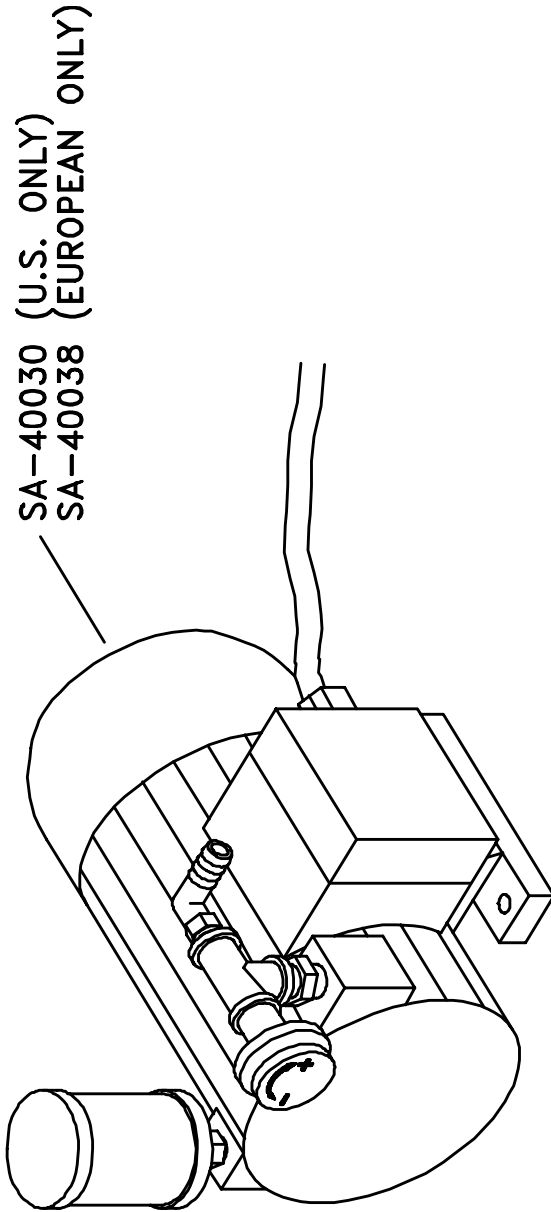

SORF20, 2-4-98

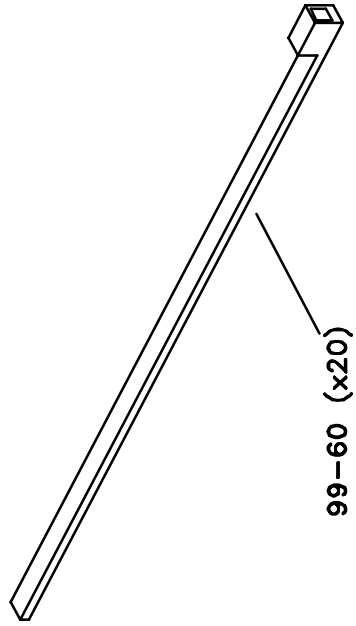
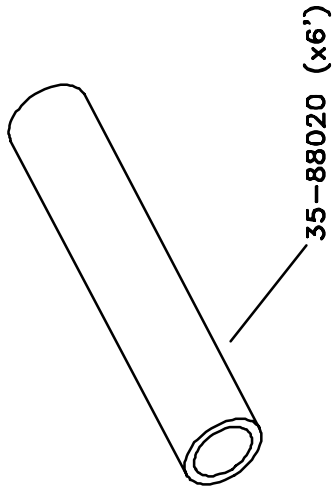

SORP21, 8-27-97



**ACCEL**  <sup>®</sup>  
*Graphic Systems*

11103 Indian Trail, Dallas, TX 75229 Phone 972-484-6808, Fax 800-365-6510  
E-mail [accel@dallas.net](mailto:accel@dallas.net), Web Site [www.accelgraphicsystems.com](http://www.accelgraphicsystems.com)