

PowderPro[®] Spray System

Installation Instructions

Heidelberg MO

ACCEL  [®]
Graphic Systems

GENERAL INFORMATION

**ATTENTION
POWDERPRO®
OWNER!**

Accel Graphic Systems provides parts and service through its authorized distributors and dealers. Therefore, all requests for parts and service should be directed to your local dealer.

The philosophy of Accel Graphic Systems is to continually improve all of its products. Written notices of changes and improvements are sent to Accel Graphic Systems' Dealers.

If the operating characteristics or the appearance of your product differs from those described in this manual, please contact your local Accel Graphic Systems Dealer for updated information and assistance.

Always update your equipment when improvements are made available, especially those related to safety.

YOUR AUTHORIZED POWDERPRO® DEALER IS:

**THE SERIAL NUMBER OF YOUR
POWDERPRO® IS:**

For technical assistance, please contact:

ACCEL GRAPHIC SYSTEMS
11103 Indian Trail
Dallas, TX 75229
(972) 484-6808
FAX (800) 365-6510
E-MAIL accel@dallas.net
WEB SITE www.accelgraphicsystems.com

PowderPro® is covered by U.S. Patents Pending

INSTALLATION

1

Disconnect the electrical power from the press.

2

Remove the NOPS delivery side cover.

3

Remove the original powder spray system from the press including the hopper, pump and valve. **Do not remove** the spray length adjustment cams or its actuation arms. This timing system is used with the PowderPro® spray system

3

Diagram A

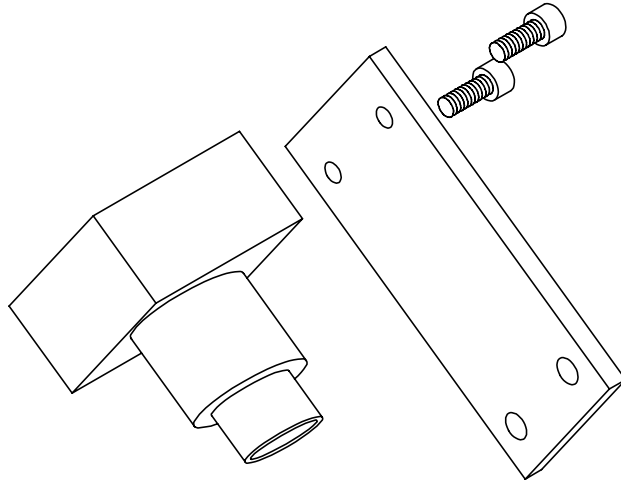
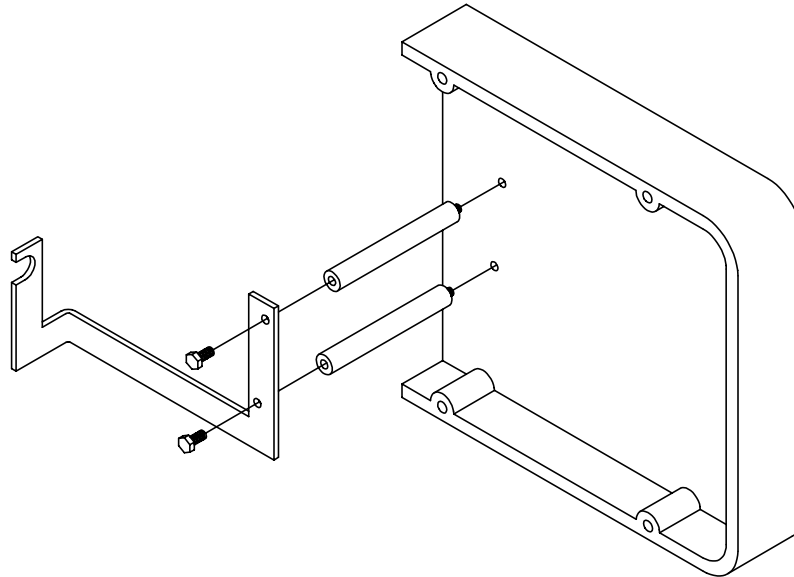

Diagram B



INSTALLATION

4

Remove the spray valve from the mounting plate as shown in Diagram A. Save the plate, the bolts that secured the valve to the plate, and the bolts and spacers that secured the assembly to the press frame.

5

If the press is a late model machine with the powder hopper mounted to a separate bracket, instead of directly to the valve, remove the two large, round stand off bars that the bracket bolts to as shown in Diagram B.

6

Remove the original spray bar, transition pipe and hoses from the press.

5

Diagram C

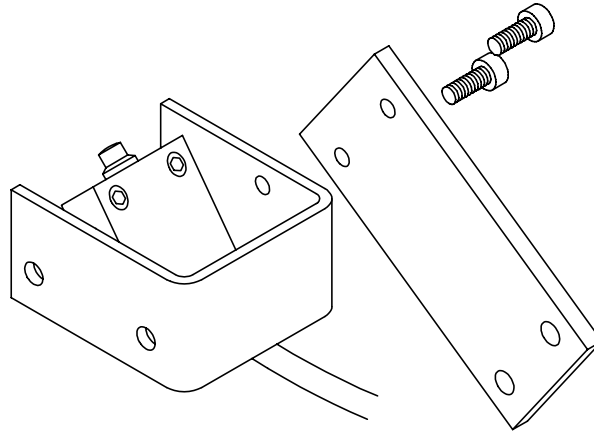

Diagram D

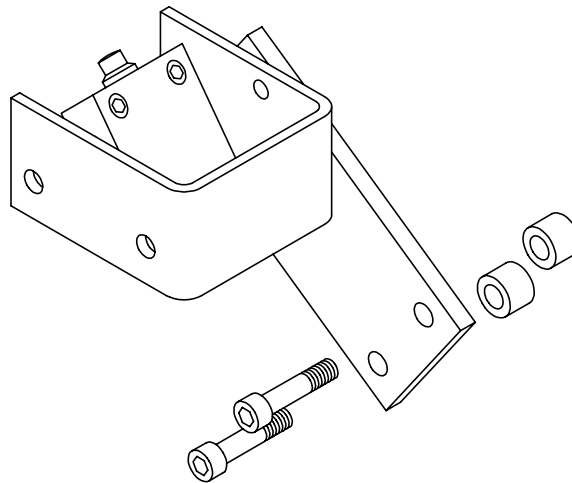
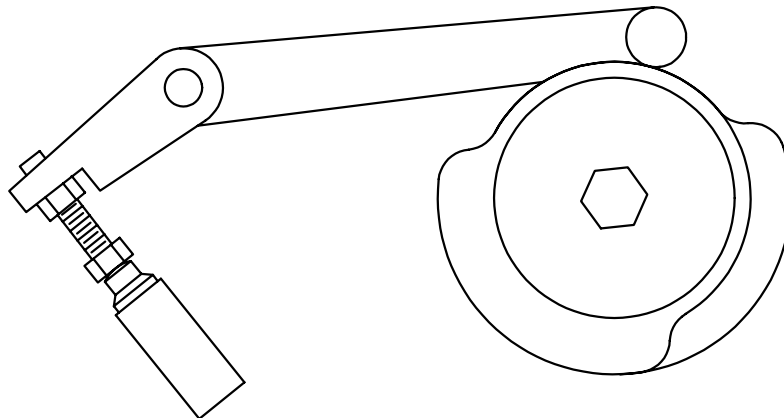

Diagram E



INSTALLATION

7

Secure the provided switch and mounting adapter assembly to the mounting plate saved in step 4, using the original bolts as shown in Diagram C.

8

Using the original bolts and spacers, attach the assembly from the previous step to the press as shown in Diagram D. Use the provided zip ties to secure the cable away from any moving parts. The cable exits from the bottom of the delivery side cover when it is replaced in a later step.

9

Adjust the bolt on the end of the valve actuation arm so that it is just touching the button on the switch when the spray length cam is in the **off** position as shown in Diagram E.

Diagram F

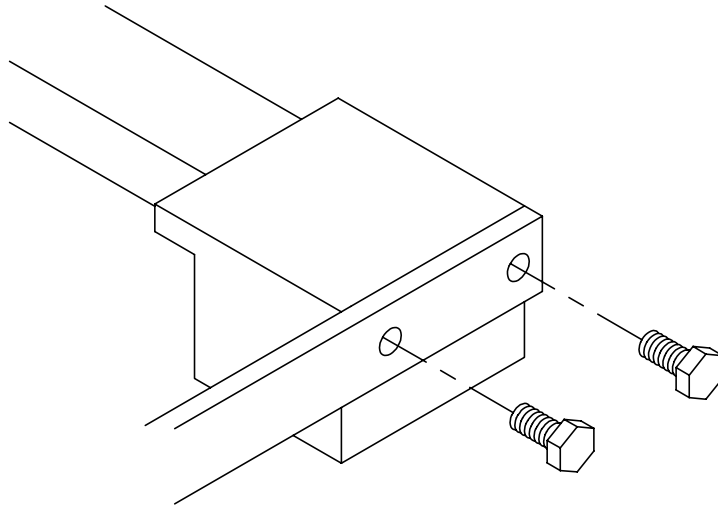
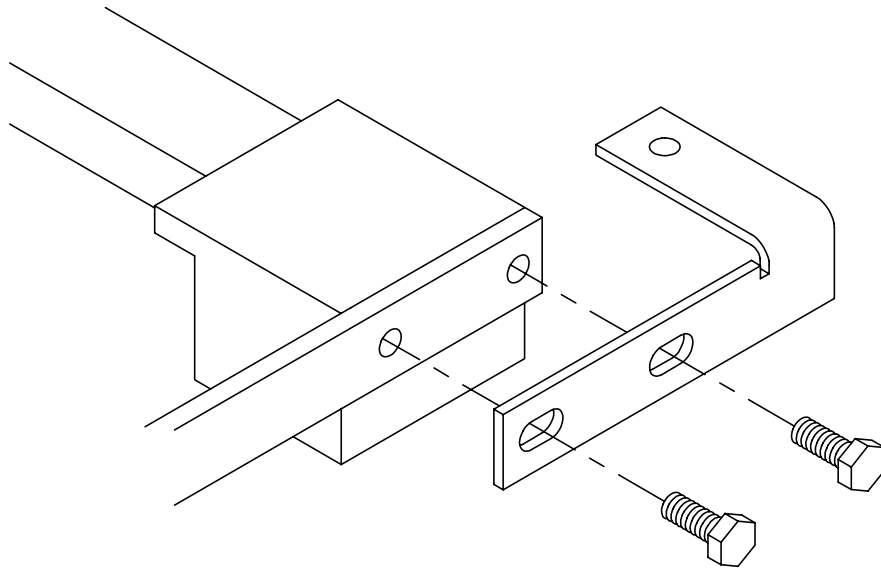

Diagram G



INSTALLATION

10

Remove the two bolts on the OPS that secure the light to the delivery as shown in Diagram F.

11

Using the provided longer bolts, install the OPS PowderPro® spray bar mounting brackets as shown in Diagram G.

12

Repeat the two previous steps for the NOPS mounting bracket.

Diagram H

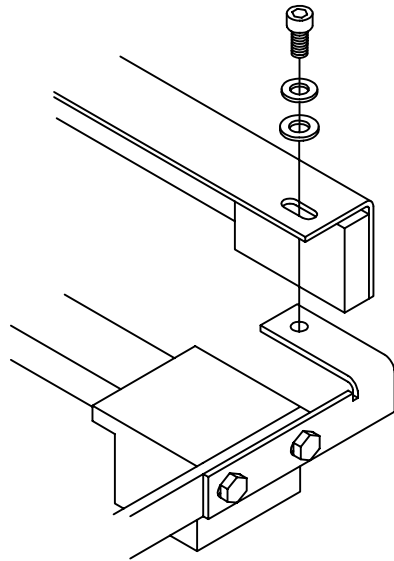
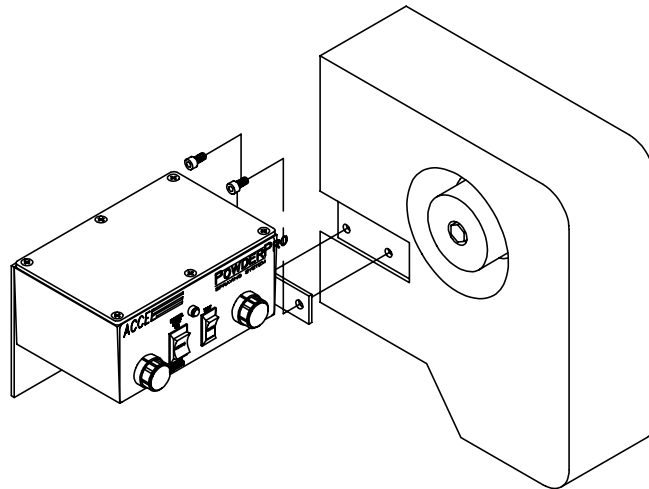
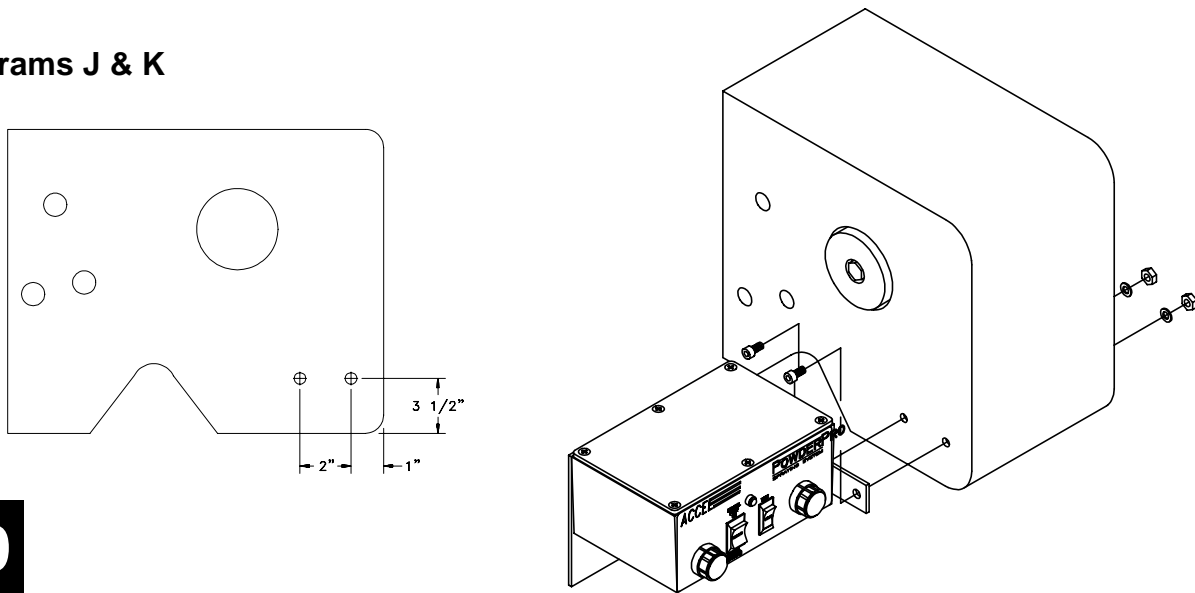

Diagram I



Diagrams J & K



INSTALLATION

13

Attach the PowderPro® spray bar, with hoses attached, to the mounting brackets as shown in Diagram H. Route the hoses through the same hole in the NOPS press frame that the original spray hoses came through. If necessary, use the provided 90° elbow tubes to prevent the hoses from kinking where they may need to make a sharp bend. Use the provided tie wraps to secure the hoses away from any moving parts in the delivery.

14

If the machine is an older model press (does not have the large control console on the NOPS, at the delivery) replace the NOPS delivery cover on the press. The hoses from the spray bar will exit from the bottom of the side cover. Using the provided hardware, attach the PowderPro® control box to the mounting adapter, installed in a previous step, as shown in Diagram I.

15

If the machine is a late model press (with control console) use Diagram J to locate and drill two 3/8" diameter holes in the cover. Using the provided hardware attach the PowderPro® control box to the side cover as shown in Diagram K. Replace the cover on the press. The hoses from the spray bar will exit from the bottom of the cover.

Diagram L

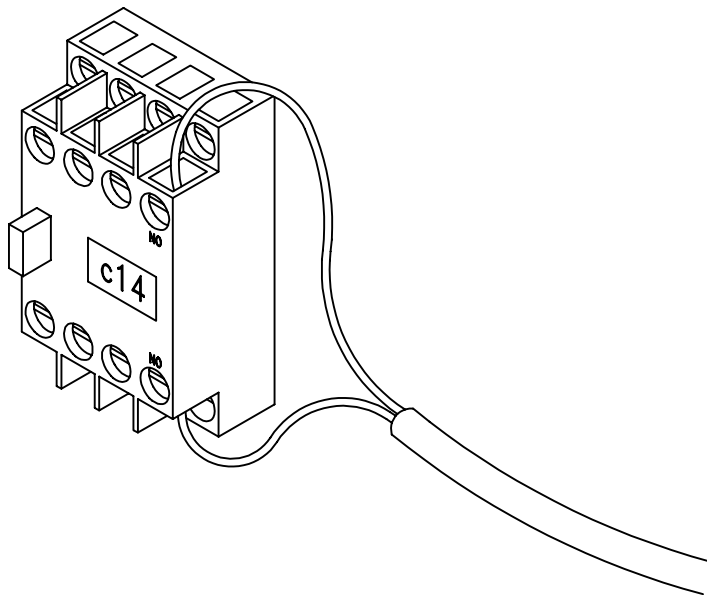

INSTALLATION

16

Connect the hoses from the spray bar to the control box. The two hoses with black tape on the ends must be attached to the lower two tubes coming out of the box.

17

Connect the six-pin connector on the cable coming from the switch installed in step 8 to the appropriate mating receptacle coming out of the PowderPro® control box. Route the long two-conductor cable into the press electrical cabinet. Secure the cable as necessary using the provided zip-ties.

18

On older presses, locate the c14 relay in the electrical cabinet. Insert the wires in the cable routed in the previous step into an open set (not being used by other wires) of normally open contacts on the c14 relay as shown in diagram L. Insert the cable into the ducting for a clean installation.

13



INSTALLATION

19

On newer presses locate the 15K35M relay in the electrical cabinet. Insert the wires in the cable routed in the previous step into an open set (not being used by other wires) of normally open contacts on the c14 relay as shown in diagram L. Insert the cable into the ducting for a clean installation. Insert the wires into the wire duct for a clean installation.

20

Set the provided pump on the floor under the NOPS walkway, near where the original pump was located. Plug the power cable from the pump into the appropriate mating receptacle coming out of the PowderPro® control box. Connect the hose from the pump to the barbed fitting on the hose coming out of the PowderPro® control box. Use the supplied zip-ties to secure any loose cable or hose as necessary.

21

Plug the PowderPro® power cord into a standard 115 VAC outlet. The unit will draw a maximum of three amps.

Replace the covers on the press, then proceed to the "Operation & Maintenance" section for proper pump adjustment and operation.

OPERATION & MAINTENANCE

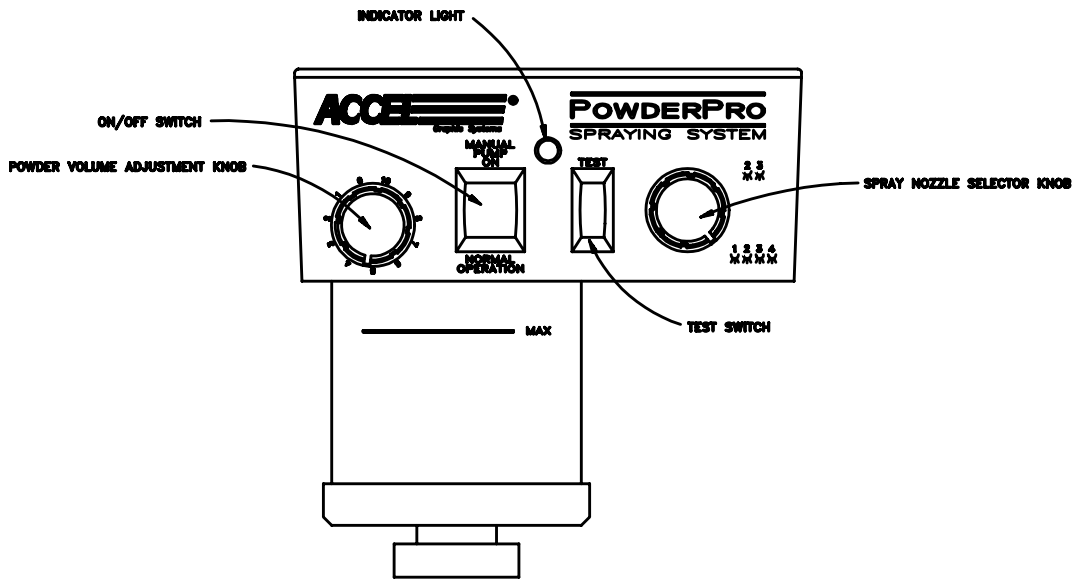

POWDER PRO® CONTROLS

VOLUME ADJUSTMENT KNOB

Adjusts the amount of spray powder with "0" the minimum and "10" the maximum.

ON/OFF SWITCH

When switched to "Manual Pump On" the pump will come on for setting spray powder volume. When switched to "Normal Operation" the system is armed and sprays only when the press goes on impression.

INDICATOR LIGHT

This light is illuminated only when the unit is actually spraying. The light goes on and off as sheets pass under the spray nozzles.

TEST SWITCH

Use this switch for setting powder volume when not printing. With the "On/Off" switch set to "Manual Pump On," push the test switch to visually see the amount of powder being sprayed. Adjust if necessary.

NOZZLE SELECTOR KNOB

This knob lets you control which spray nozzles are being used. For maximum width sheets, set the selector to the lower position. This setting sprays all four nozzles. For narrow sheets (generally 11" wide or less), set the selector to the upper position. This setting sprays only the center two nozzles.

OPERATION & MAINTENANCE

PUMP ADJUSTMENT

Powder volume range is adjusted by the outlet pressure of the pump. Locate the adjustment knob on the pump near the outlet hose. Loosen the locking knob and turn the adjustment knob clockwise to increase the pressure for more powder. Turn the knob counter clockwise to decrease pressure for less powder. Set the correct pump pressure as follows:

1. Turn the pump on by switching the large switch on the PowderPro® control box to the "Manual Pump On" position.
2. Set the nozzle selector knob on the PowderPro® control box to "4".
3. Set the powder volume adjustment knob to "10".
4. Hold the "Test" switch "On" while looking at the spray nozzles in the delivery.
5. Have someone slowly adjust the pressure on the pump until the powder is barely visible. A powder setting of "10" with visible powder in the delivery is more than enough powder. Consequently, a setting of "5" results in no visible powder but sufficient powder for most jobs.

If powder is visible at the "5" setting than too much powder is being sprayed. Return to step 3 and reset the pump.

6. Tighten the locking knob on the pump adjustment.

INITIAL SETTINGS

The initial setting for the powder volume adjustment on an average job is "5". If more powder is required than is available at a setting of "10" you need to adjust the pump. If less powder is required than is available at a setting of "0" you also have to adjust the pump. So that you have a wide range of powder volume adjustment available for different jobs you want your "normal" setting for average jobs to be somewhere in the range from "4" to "6", otherwise you need to adjust the pump.

OPERATION & MAINTENANCE

MAINTENANCE

1. Clean the filter on the pump once a week, blowing it clean with compressed air.
2. Remove powder that may accumulate on the bottom of the spray nozzles daily.
3. Never use solvents containing oil when cleaning any part of the sprayer.
4. Use compressed air only if your compressor is equipped with a proper in-line dryer. Otherwise, use canned air. Moisture in the sprayer affects its performance.

OPERATION

1. Fill the powder hopper with an intermediate grain (20-25) powder (such as **SP-25**, available from Accel) up to the "MAX" line on the hopper.
2. Place the On\Off switch to the "Normal Operation" position.
3. Place the original spray ON/OFF switch to the "ON" position.
4. Consider the sheet width and if necessary change the spray nozzle selector knob. When switching from four to two nozzles reduce the total amount of powder being sprayed by turning the powder volume adjustment knob to a lower number.
5. The spray length is controlled by the original adjustment mechanism.
6. Adjust the powder volume adjustment knob if necessary.
7. The sprayer operates automatically when the press goes on impression and a sheet is present under the spray nozzles.

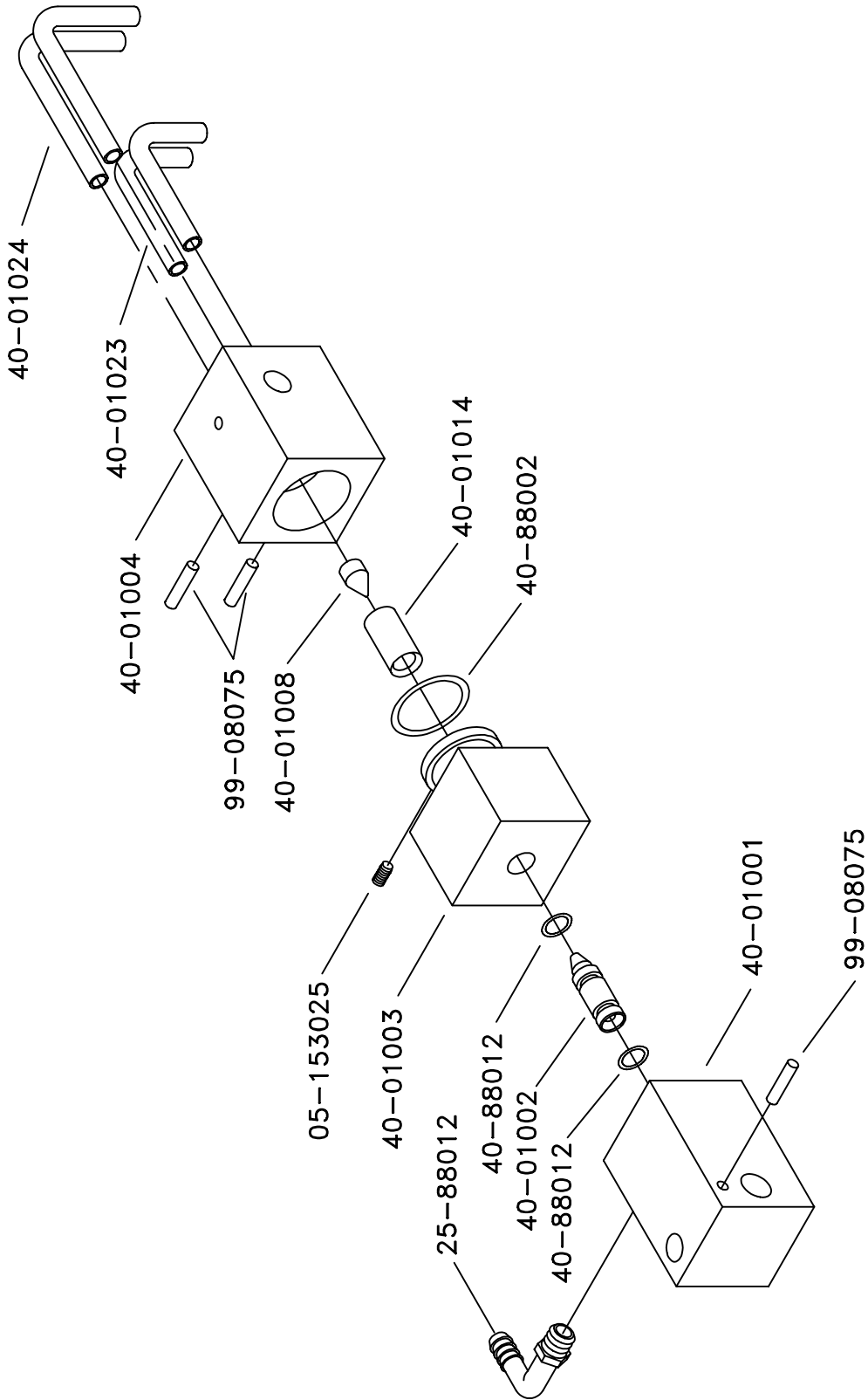

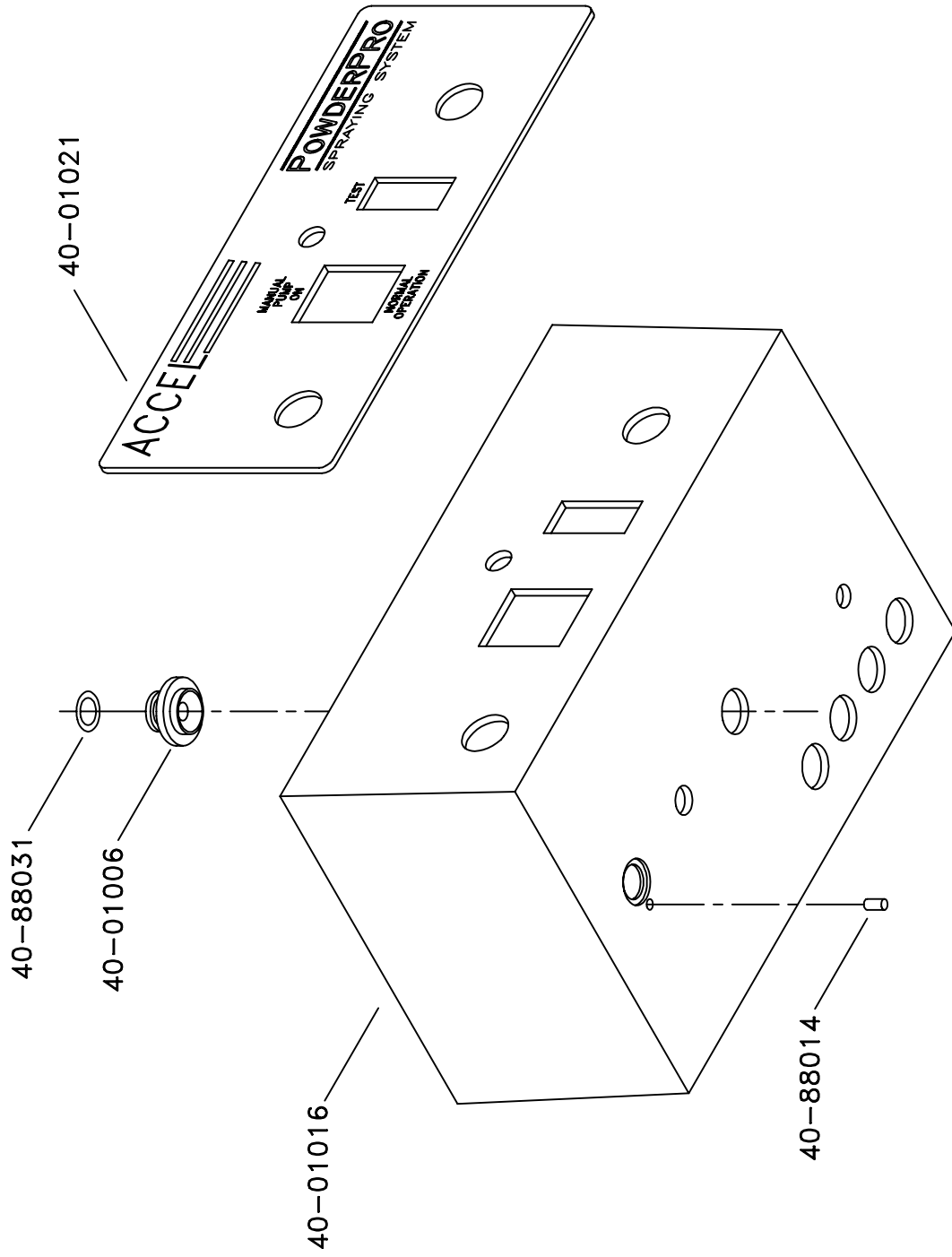

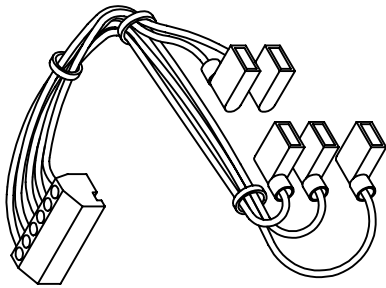

WIRE COLOR	SWITCH POSITION NO.
RED	12
ORANGE	11
BLUE	13
WHITE	24
BLACK	26

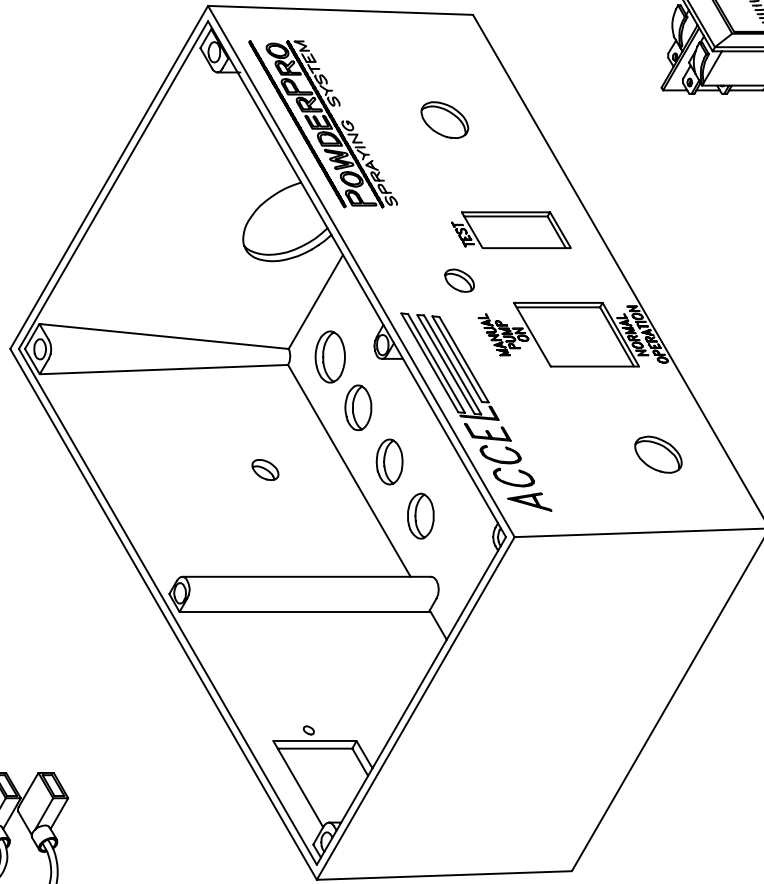

40-88042



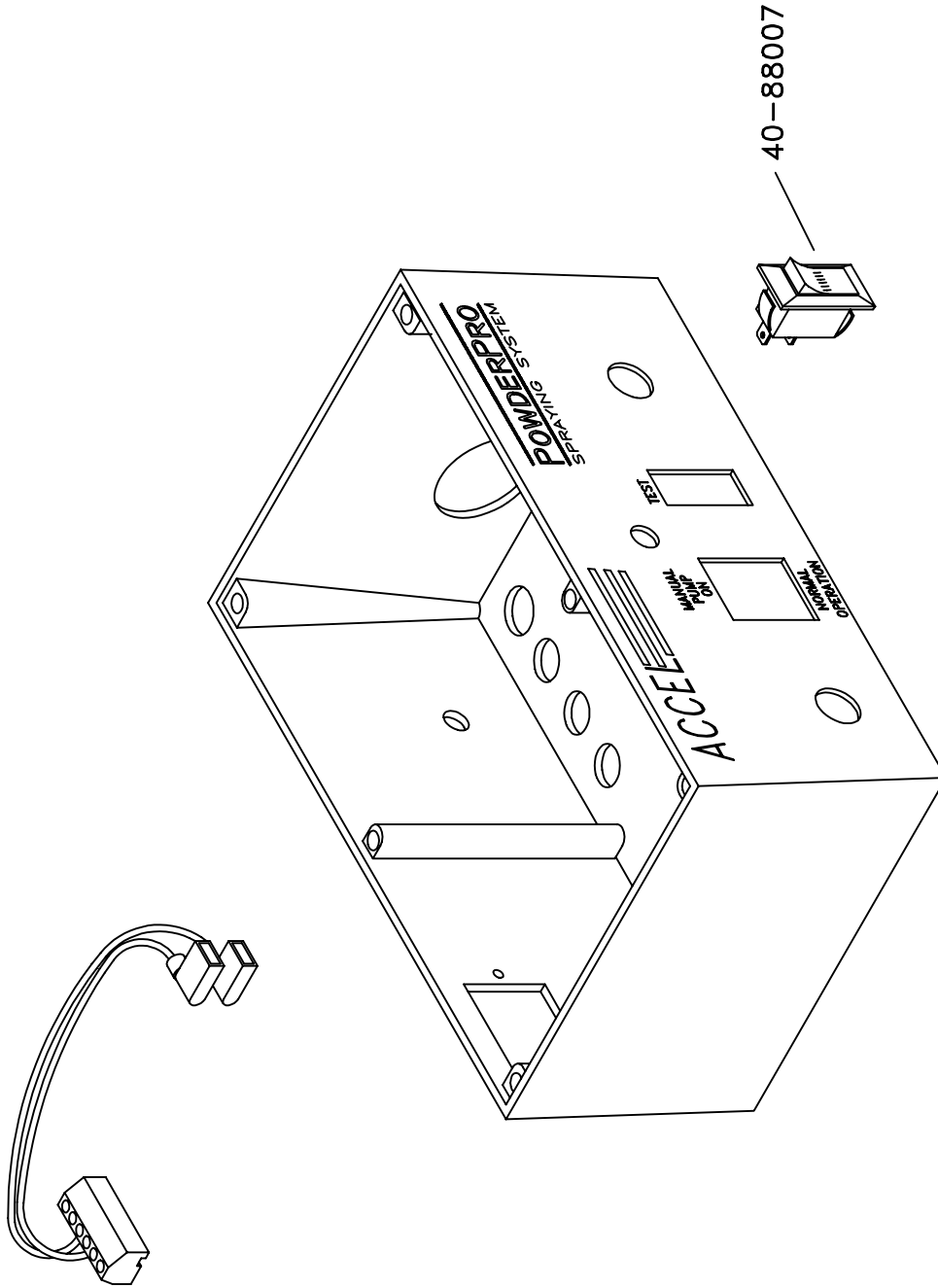

MOP11, 12-2-96

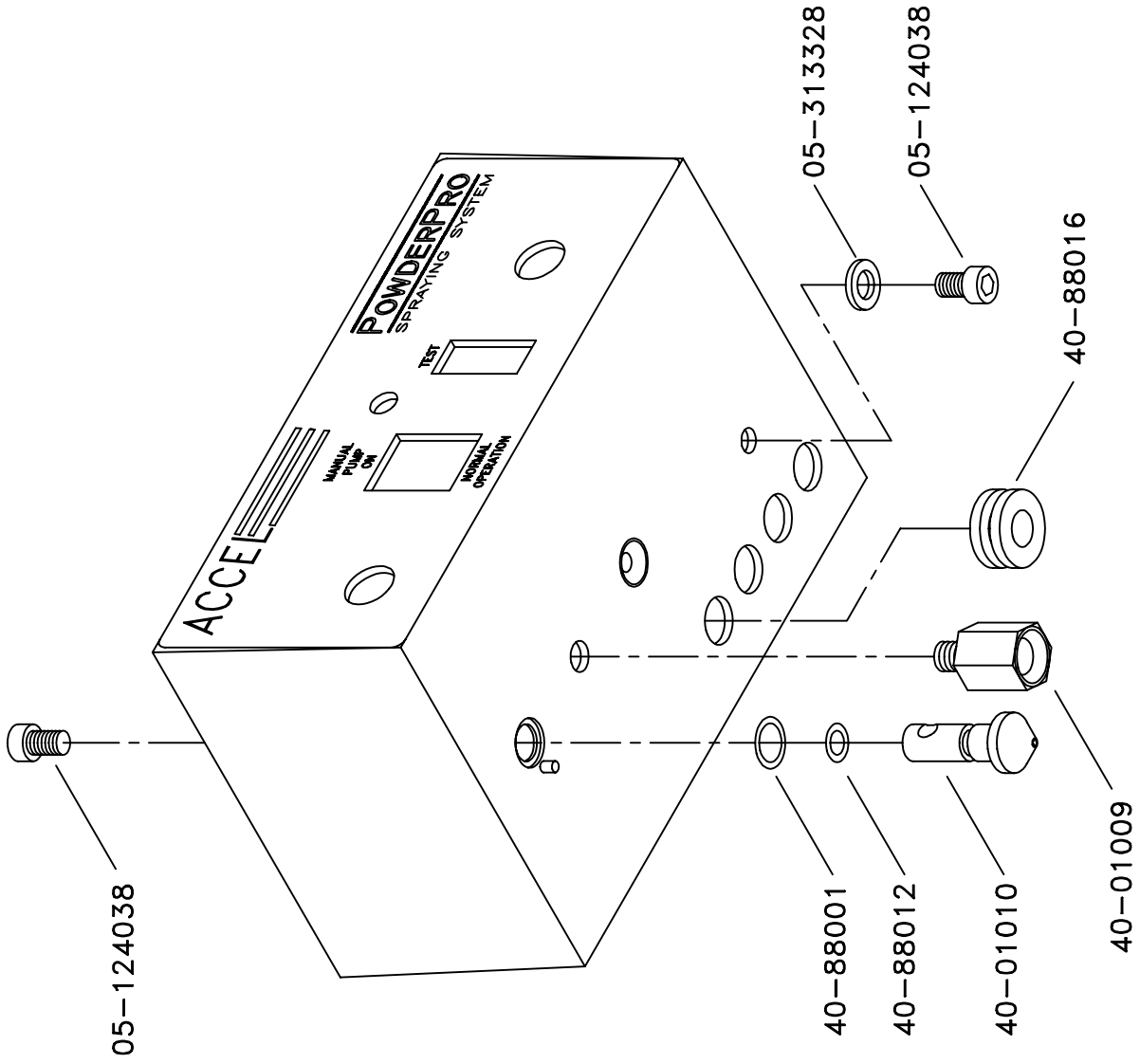

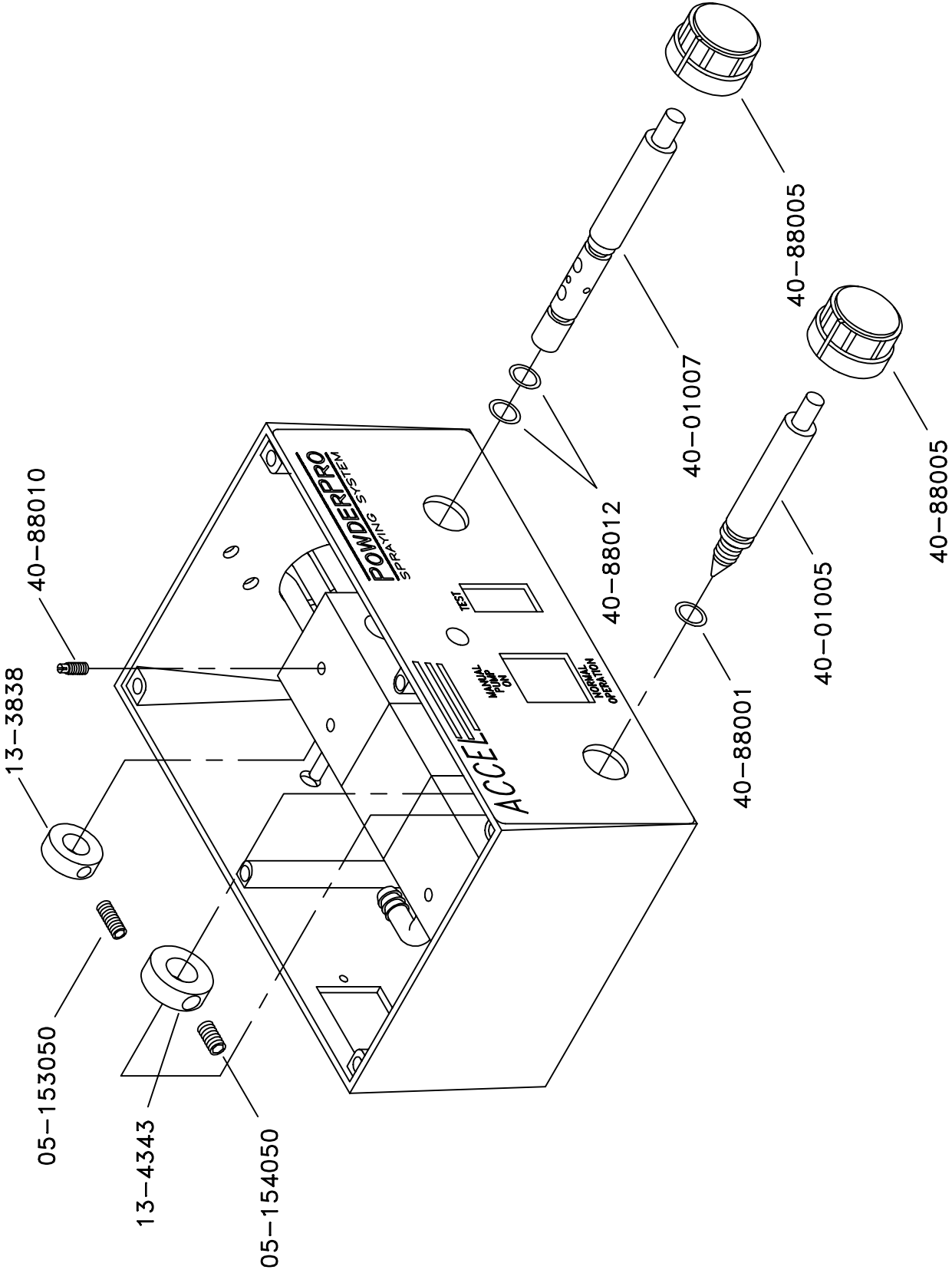

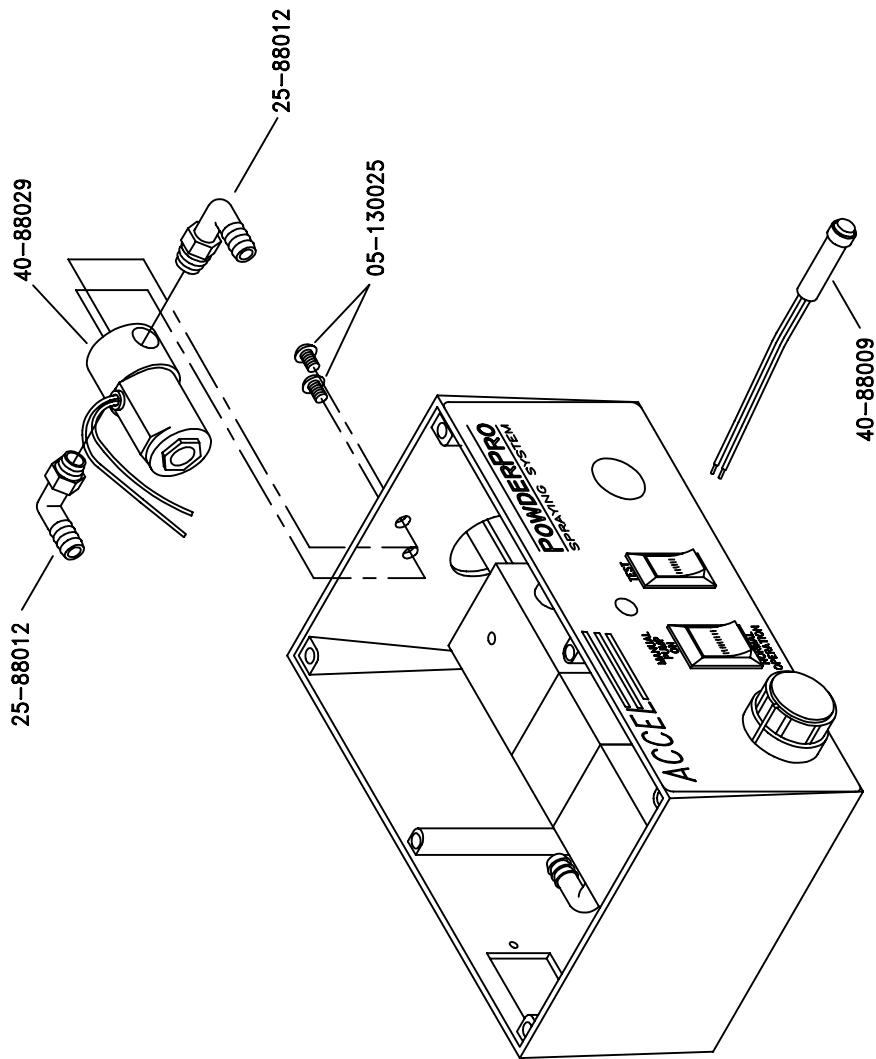

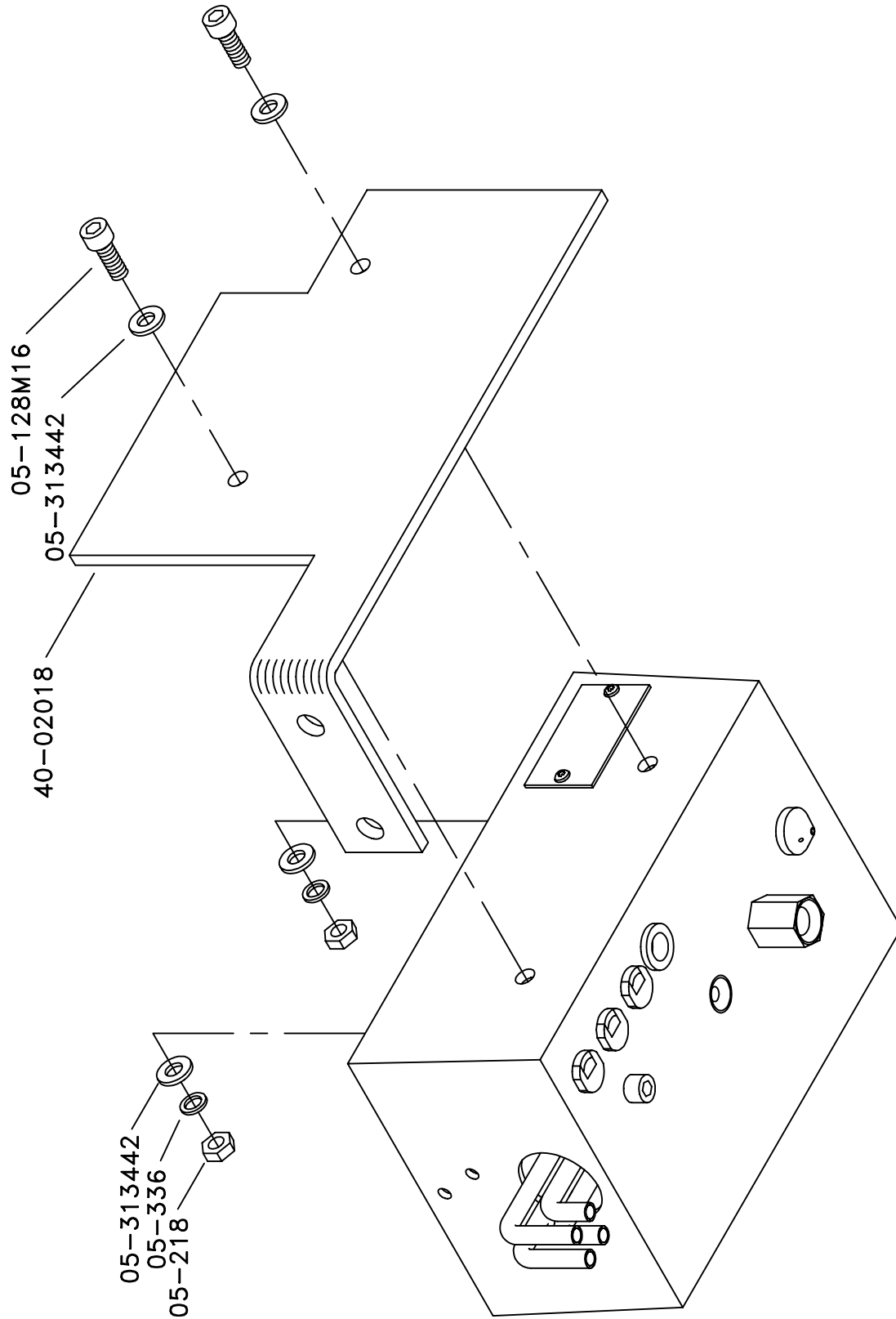

MDP16, 12-2-96

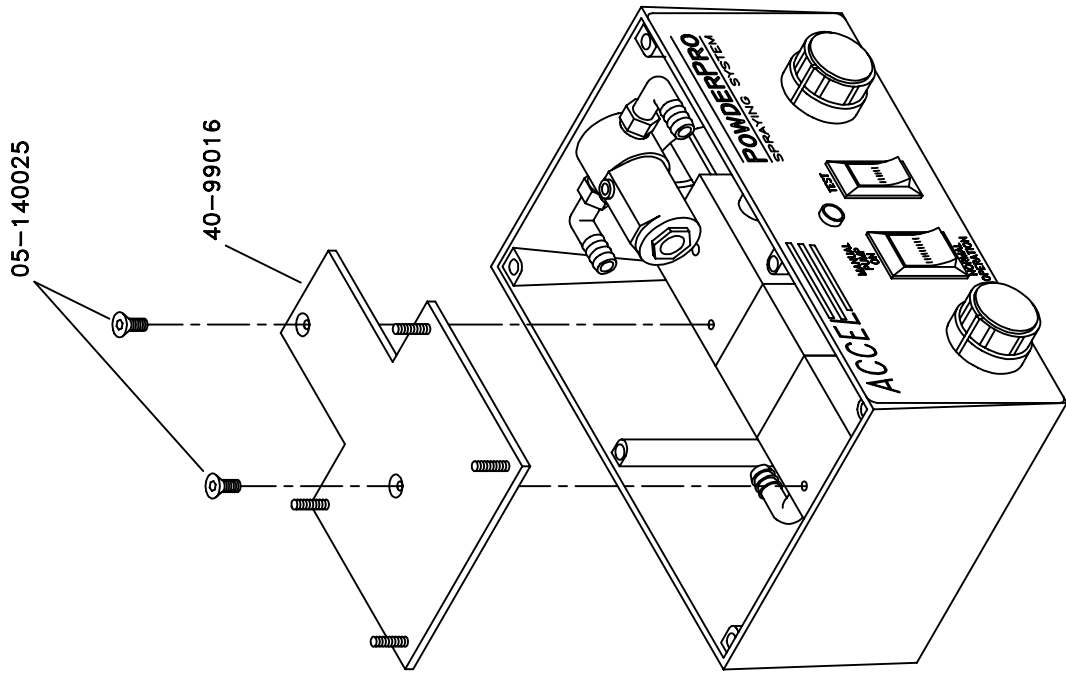

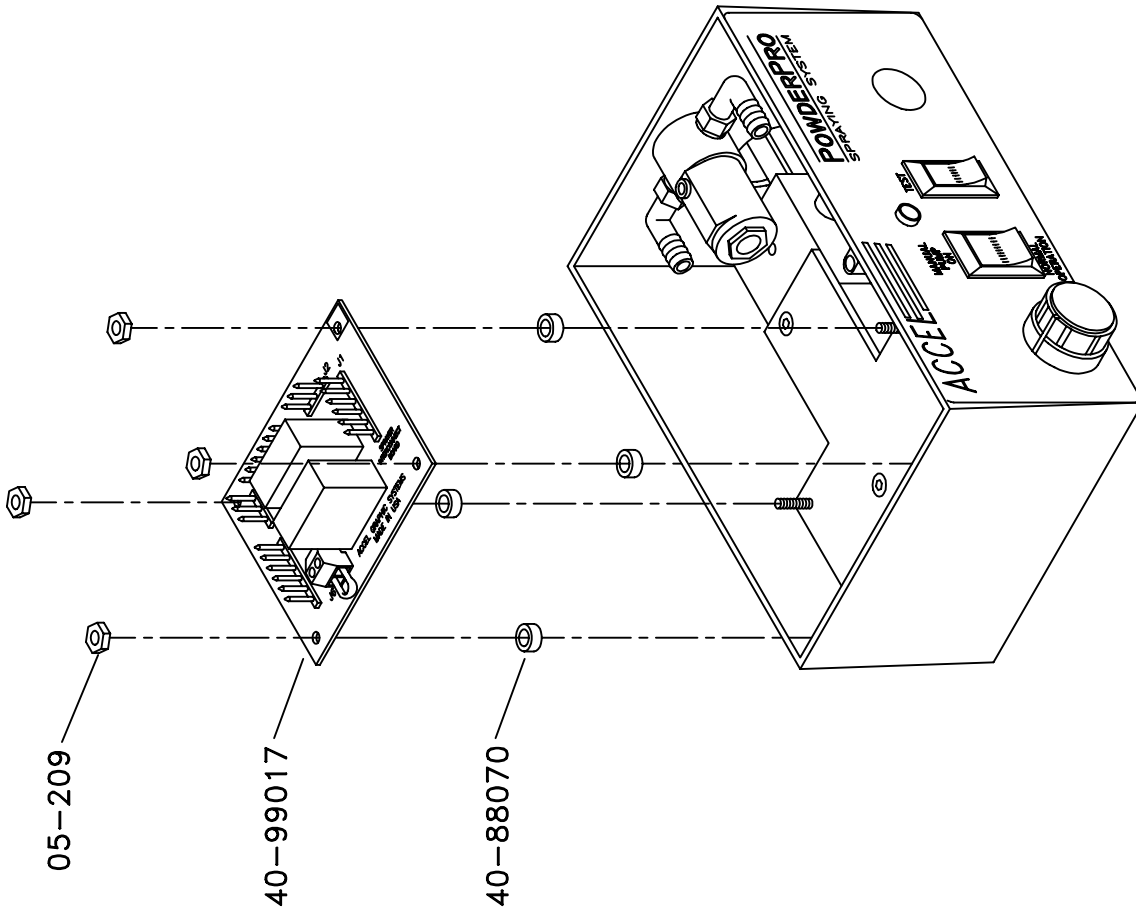

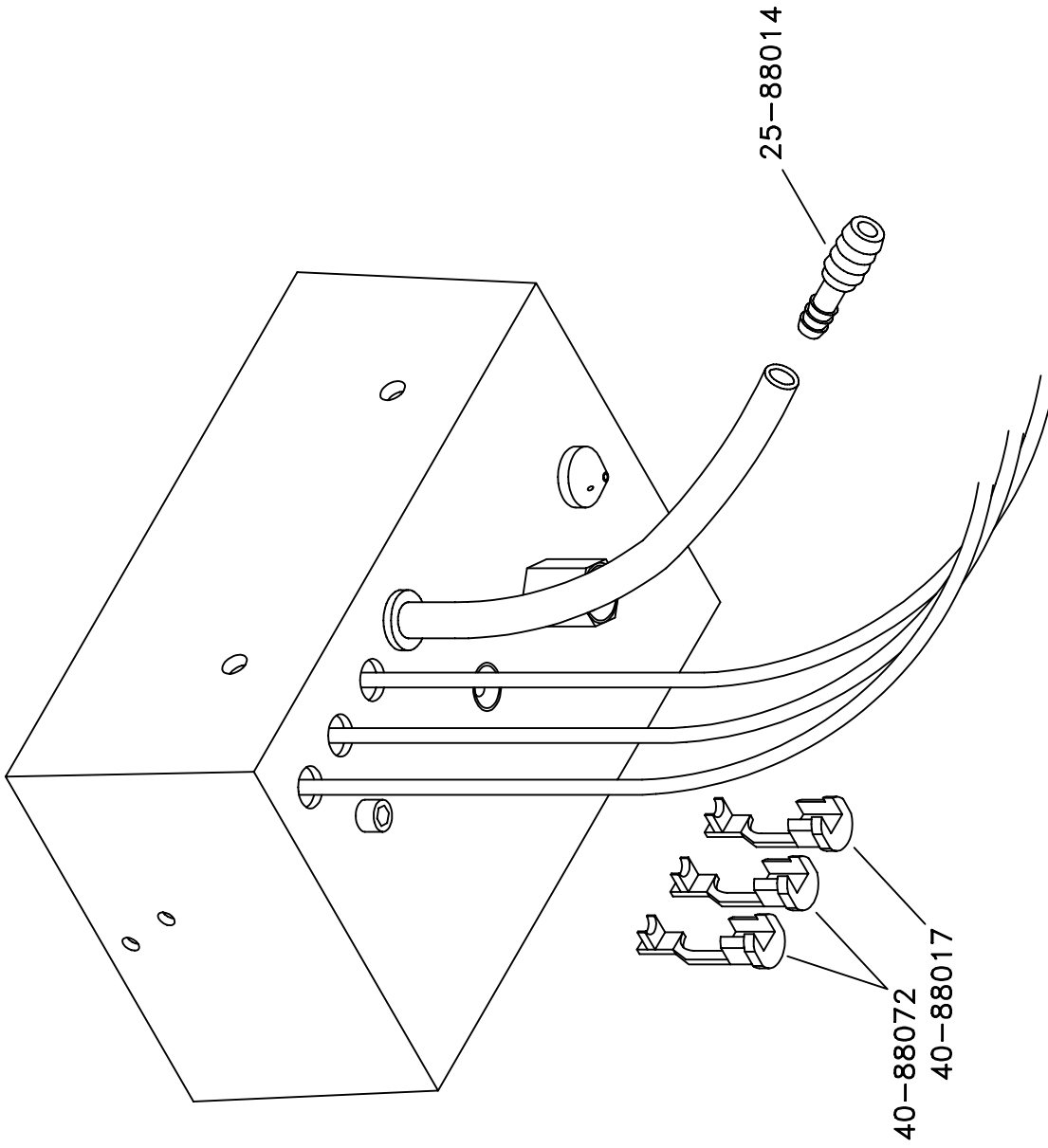

MOP28, 12-2-96

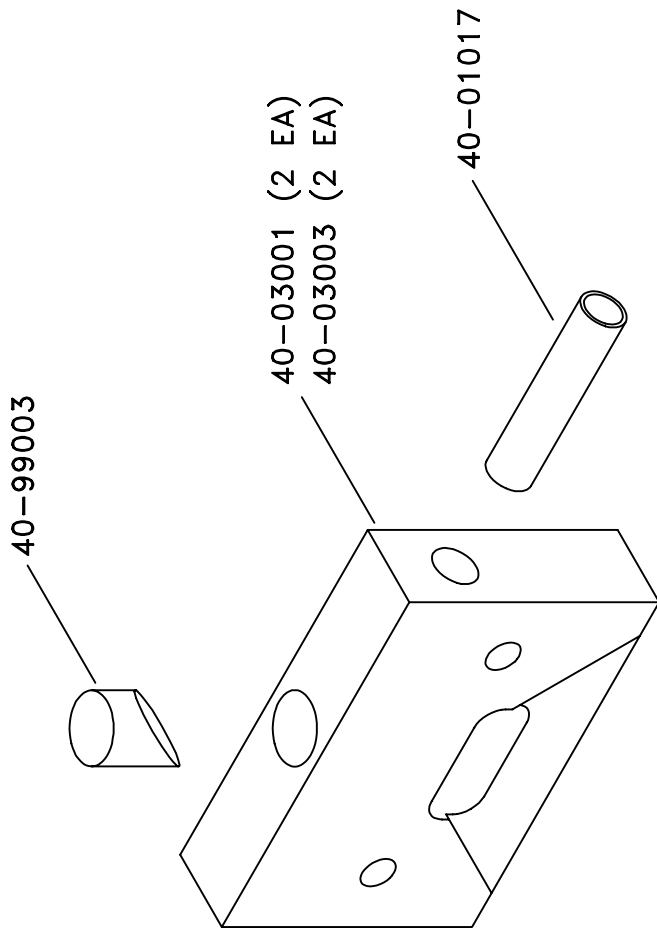

MOP30, 12-2-96

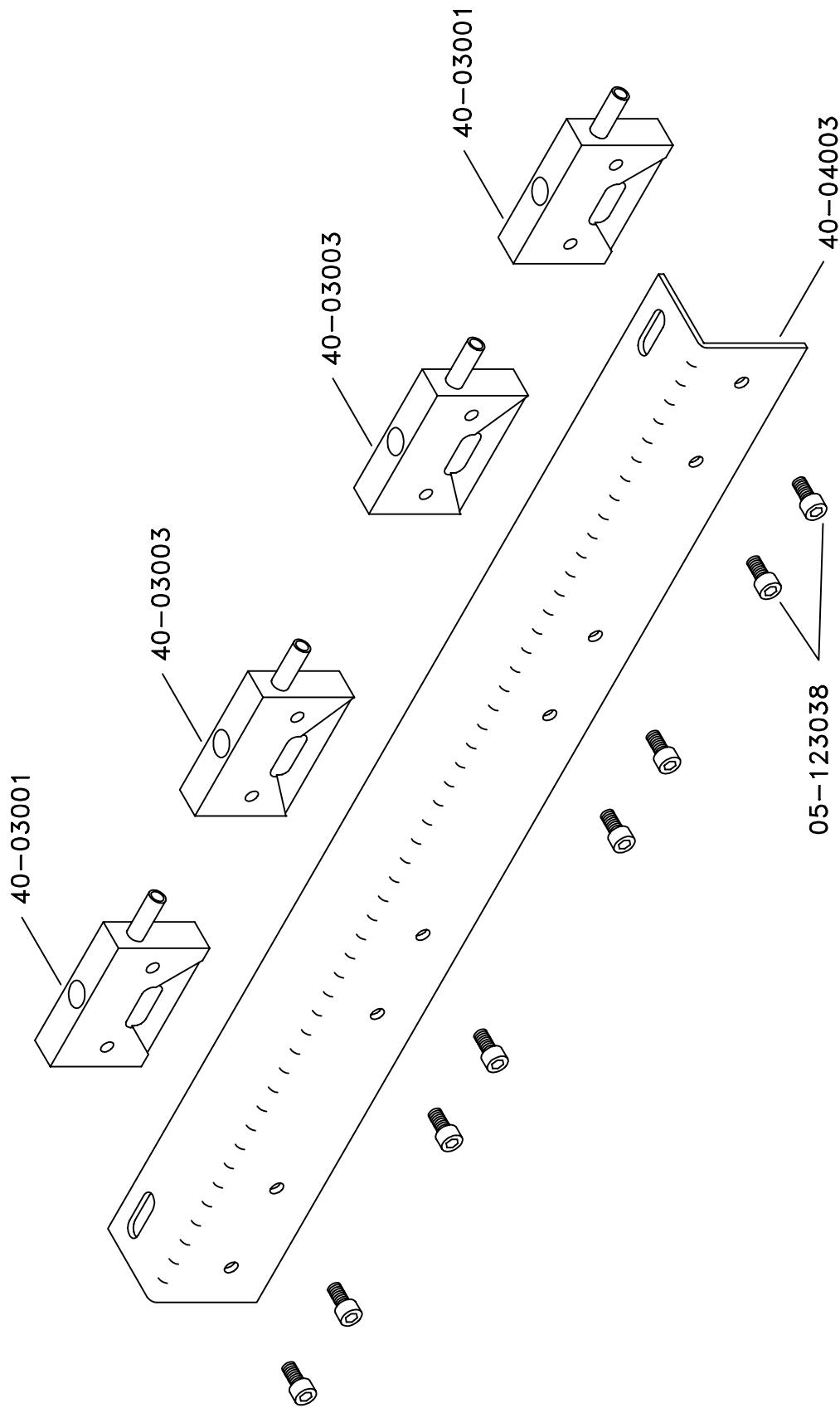

MOP31, 12-2-96

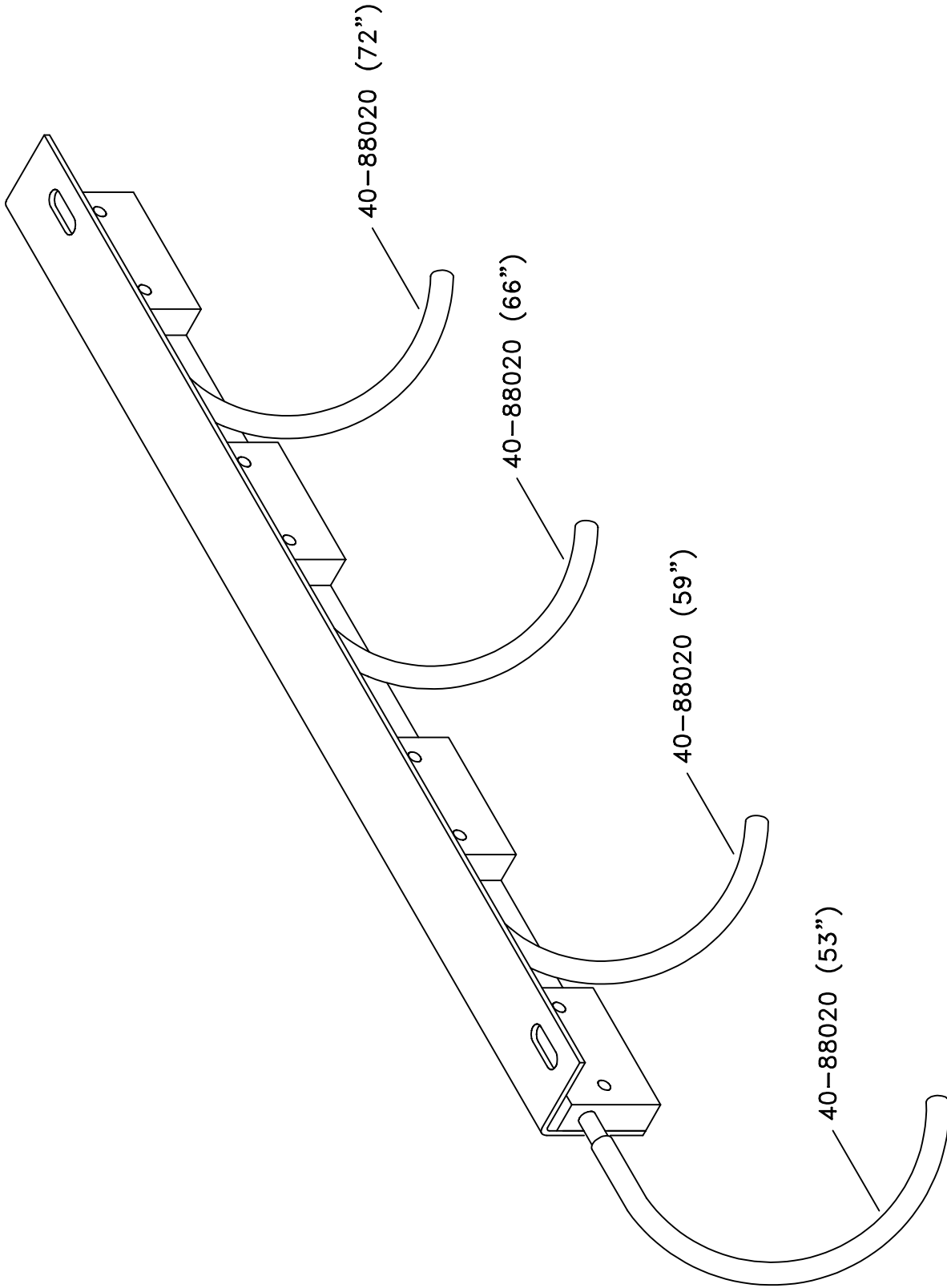

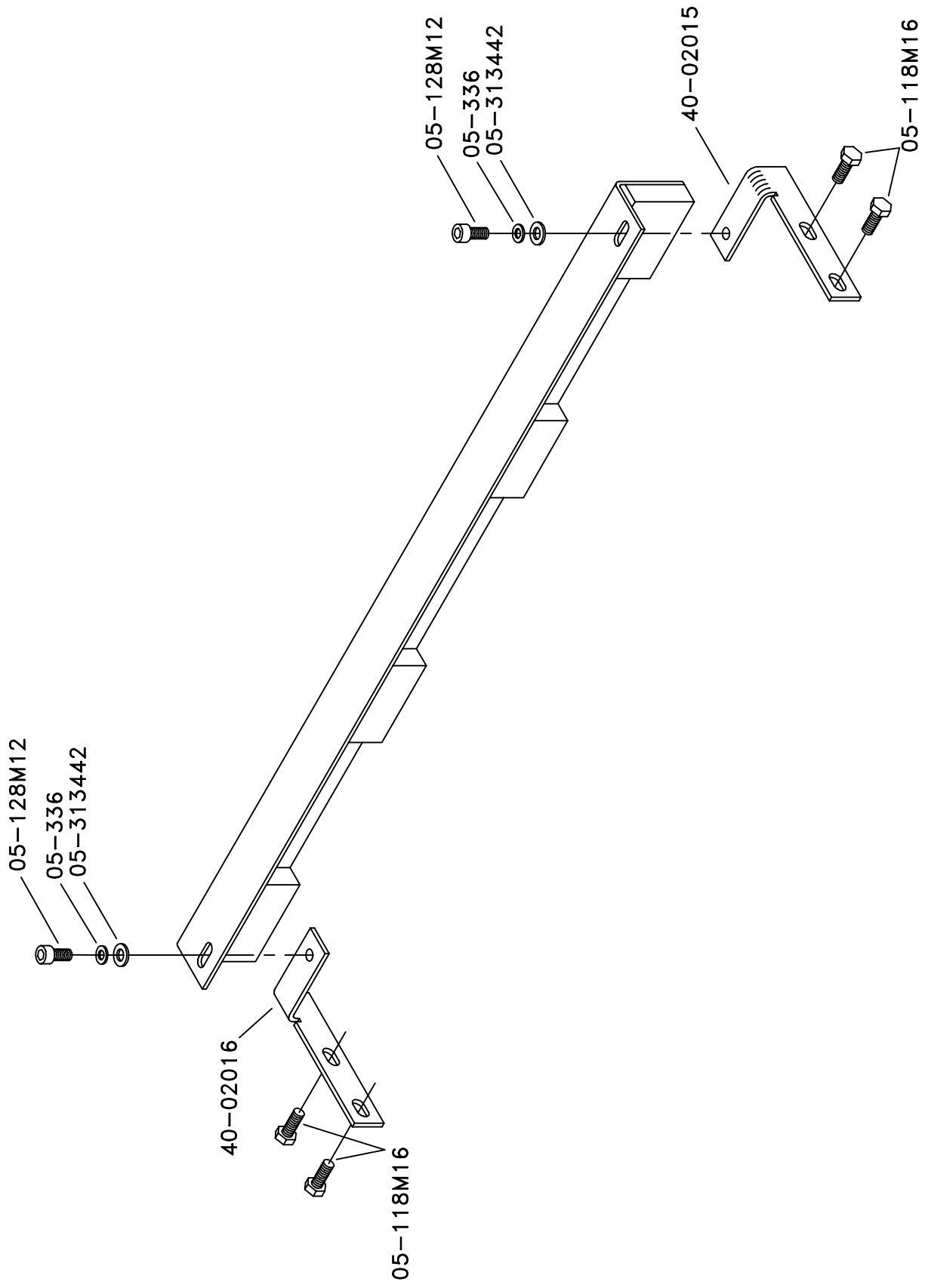

MOP33, 12-2-96

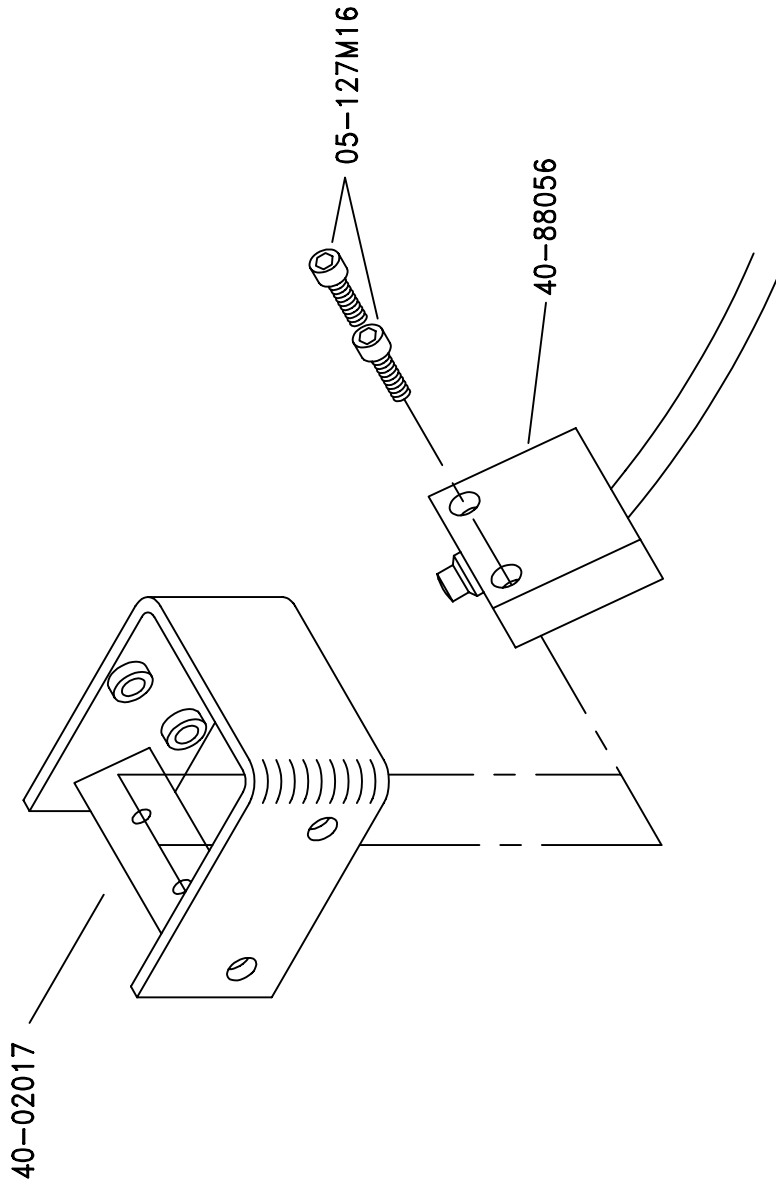

MOP35, 12-2-96

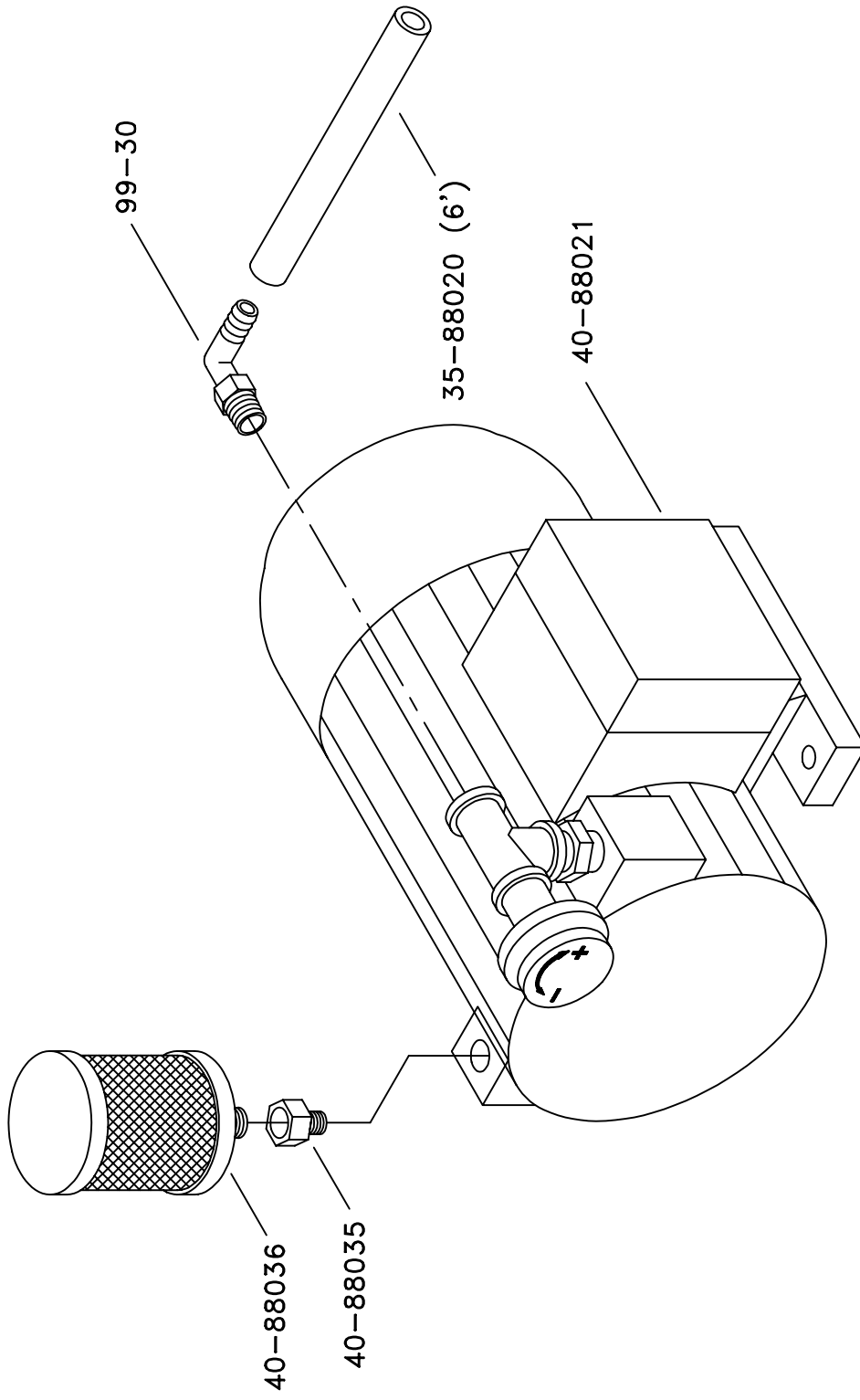

MOP36, 12-2-96

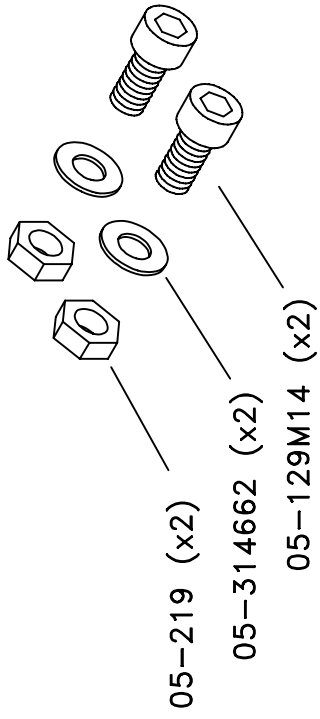
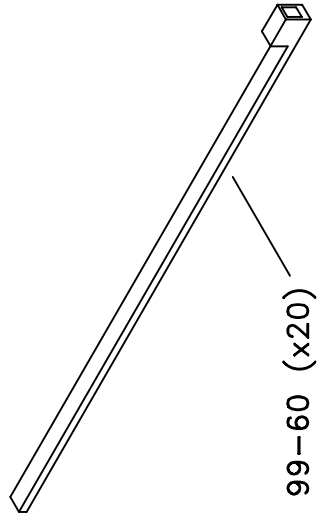

ACCEL  [®]
Graphic Systems

11103 Indian Trail, Dallas, TX 75229 Phone 972-484-6808, Fax 800-365-6510
E-mail accel@dallas.net, www.accelgraphicsystems.com