

Parts Catalog

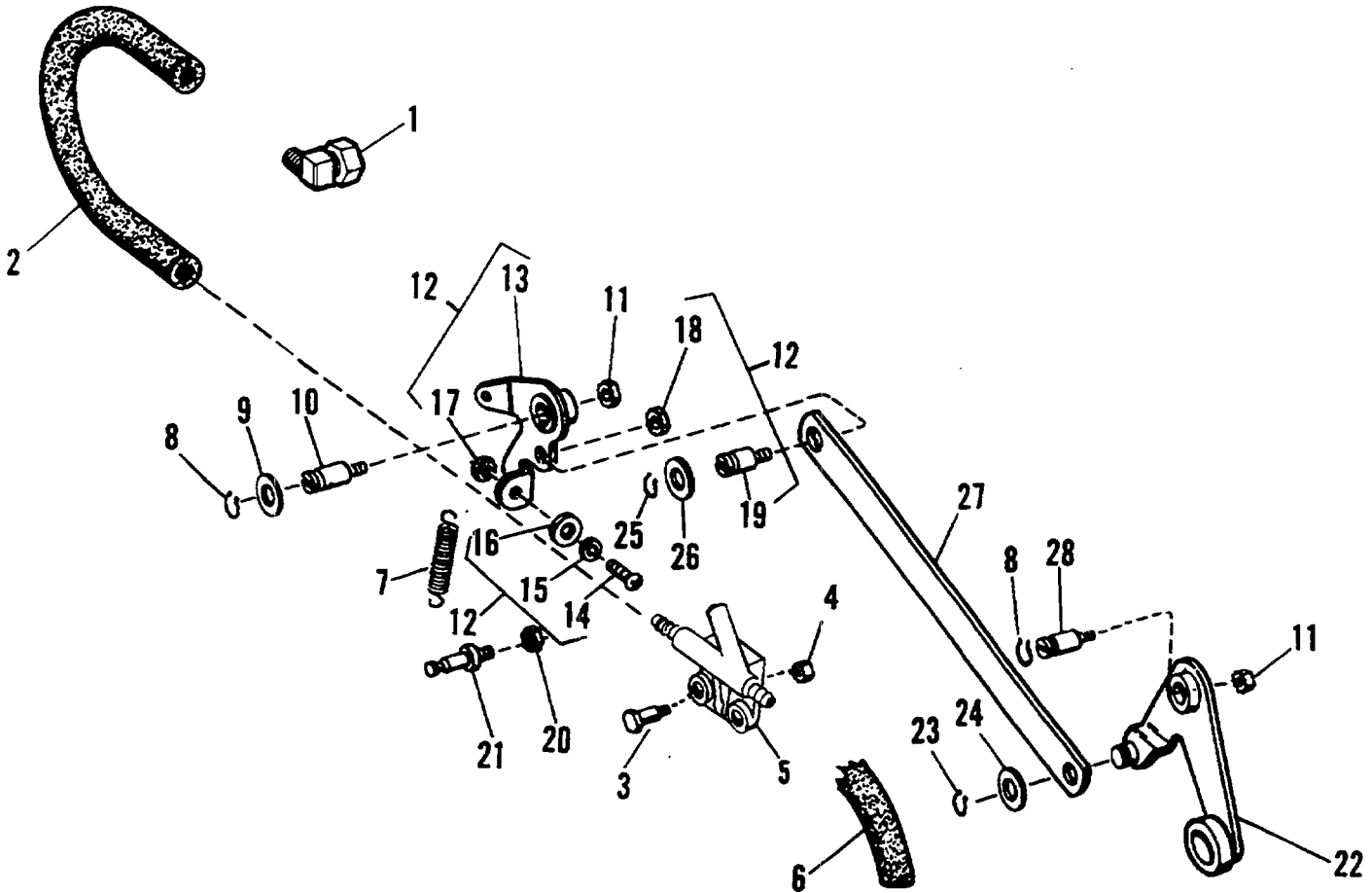

FIGURE 46
MODEL 9815/9850 Vacuum Make and Break Control

Parts Catalog

Index No.	Part No.	MODEL 9805/9850 Figure 46 Description	Units Per Assy.
1	191844	ELBOW - Vacuum Hose	1
2	072254	HOSE - Vacuum	1
3	193894	SCREW - Vacuum Valve	2
4	150085	NUT - 1/4-28	2
5	076142	VALVE - Vacuum	1
6	072256	TUBE - Sucker	1
7	072442	SPRING - Tension, .343 I.D. x 2.000 O.A.L.	1
8	001047	RING - Retaining, .340 I.D. x .027	2
9	001755	WASHER - .385 I.D. x .625 O.D. x .047	1
10	073497	STUD - Vacuum Break Lever	1
11	150083	NUT - 10-32	2
12	073496	LEVER ASSEMBLY - Vacuum Break	1
13	071570	LEVER - Vacuum Break	1
14	014369	SCREW - 8-32 x 3/8	1
15	003850	WASHER - .172 I.D. x .375 O.D. x .059	1
16	072704	WASHER - Leather, .172 I.D. x .322 O.D. x .063	1
17	014811	NUT - 8-32	1
18	014808	NUT - 10-32	1
19	073498	PIN - Vacuum Break Lever	1
20	014808	NUT - 10-32	1
21	072412	STUD - Vacuum Break Lever Spring	1
22	073493	LEVER - Cam Roller	1
23	001049	RING- Retaining, .227 I.D. x .027	1
24	021203	WASHER - .254 I.D. x .500 O.D. x .029	1
25	001046	RING - Retaining, .283 I.D. x .027	1
26	001750	WASHER - .328 I.D. x .562 O.D. x .047	1
27	073494	LINK - Vacuum	1
28	072734	STUD - Cam Roller Lever	1