

Parts Catalog

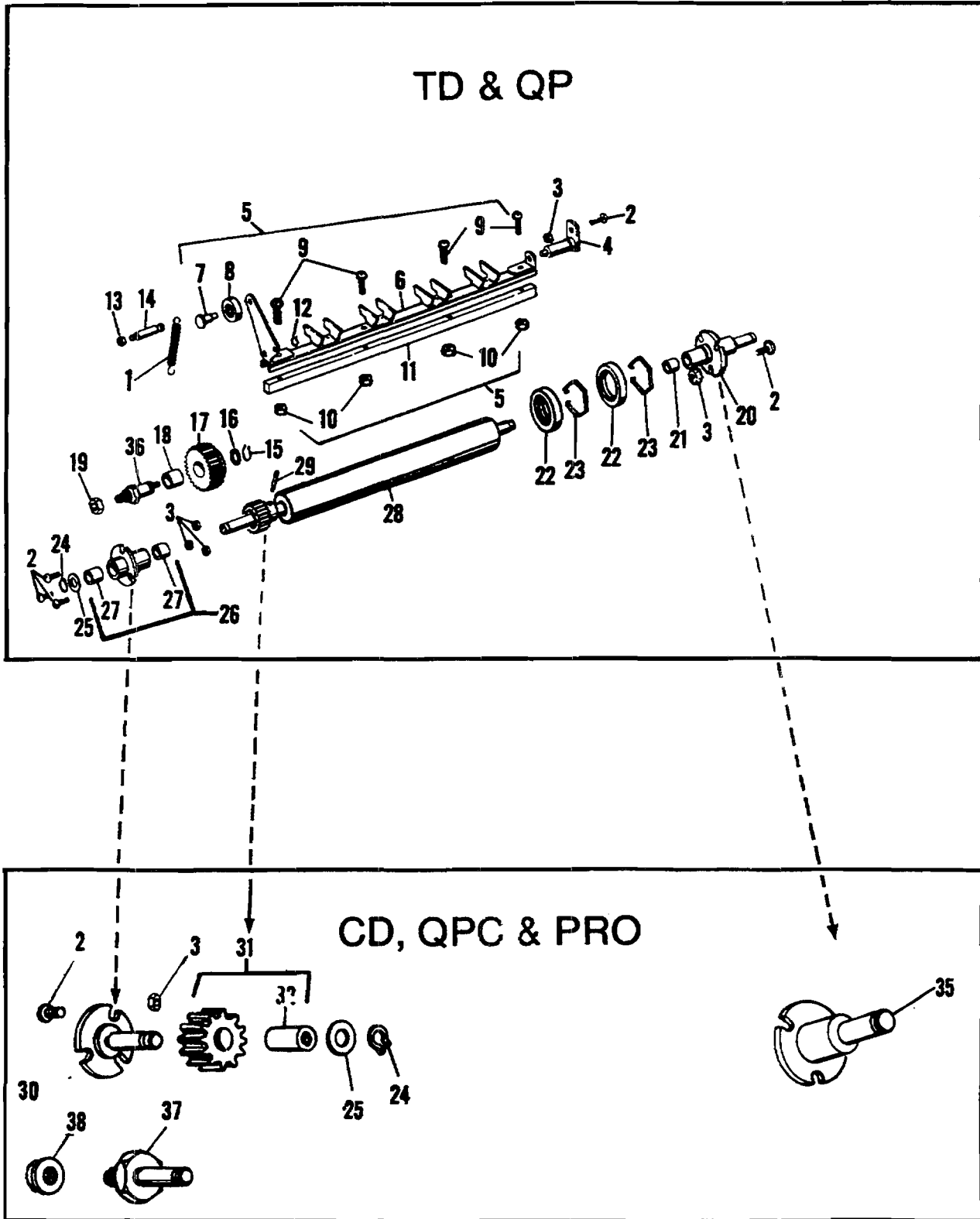

FIGURE 49
MODEL 9815/9850 Stripper Assembly and Delivery Roller

Parts Catalog

Index No.	Part No.	MODEL 9805/9850 Figure 49 Description	Units Per Assy.
1	058552	SPRING - Tension, .343 O.D. x 1.750 O.A.L.	1
2	111055	SCREW - 10-32 x 9/16	7
3	150083	NUT- 10-32	7
4	072314	PIVOT - Stripper Assembly	1
5	***007696	CHANNEL ASSEMBLY - Stripper	1
6	007697	STRIPPER CHANNEL	1
7	064112	RIVET	1
8	064234	BEARING	1
9	001267	SCREW - 10-32 x 3/4	4
10	014808	NUT - 10-32	4
11	007699	BAR - Stripper Channel Support	1
12	001044	RING - Retaining, .170 I.D. x .017	1
13	014807	NUT - 1/4-28	1
14	072328	SPRING ANCHOR - Stripper Channel Spring	1
15	001048	RING - Retaining, .463 I.D. x .037	1
16	014712	WASHER - .515 I.D. x .750 O.D. x .029	1
17	072325	IDLER GEAR ASSEMBLY	1
18	001413	BUSHING - .503 I.D. x .625 O.D. x .750 O.A.L.	1
19	150088	NUT - 3/8-16	1
20	072184	STUD ASSEMBLY - Raise, TD and QP	1
21	001404	BUSHING - .379 I.D. x .504 O.D. x .500 O.A.L.	1
22	072628	COLLAR - Adjustable	2
23	072629	SPRING - Friction	2
24	001047	RING - Retaining, .340 I.D. x .027	1
25	014727	WASHER - .382 I.D. x .750 O.D. x .029	1
26	072333	HOUSING ASSEMBLY - Delivery Roller, TD and QP	2
27	001404	BUSHING - .379 I.D. x .504 O.D. x .500 O.A.L.	2
28	007751	ROLLER AND GEAR DELIVERY - TD and QP	1
29	001978	PIN - Roll, .135 O.D. x .640 O.A.L.	1
30	>080195	SHAFT ASSEMBLY - Delivery Roller Gear, CD, QPC and PRO	1
31	>078492	GEAR ASSEMBLY - CD, QPC and PRO	1
31	016378	GEAR ASSEMBLY - CD, QPC and PRO	1
32	001401	BUSHING - .379 I.D. x .504 O.D. x .750 O.A.L.	1
32	>060012	BUSHING - .504 O.D. x .379 I.D. x .937 CD, QPC and PRO	1
33	014727	WASHER - .382 I.D. x .750 O.D. x .029, CD, QPC and PRO	1
34	001047	RING - Retaining, .340 I.D. x .027, CD, QPC and PRO	1
35	080192	STUD - Follower Lever Pivot, CD, QPC and PRO	1
36	072327	STUD - Idler Gear	1
37	150089	NUT - 3/8-24	1
38	196388	STUD	1

***Not Available as An Assembly
 >For Chain Delivery With Aluminum Frames