

Parts Catalog

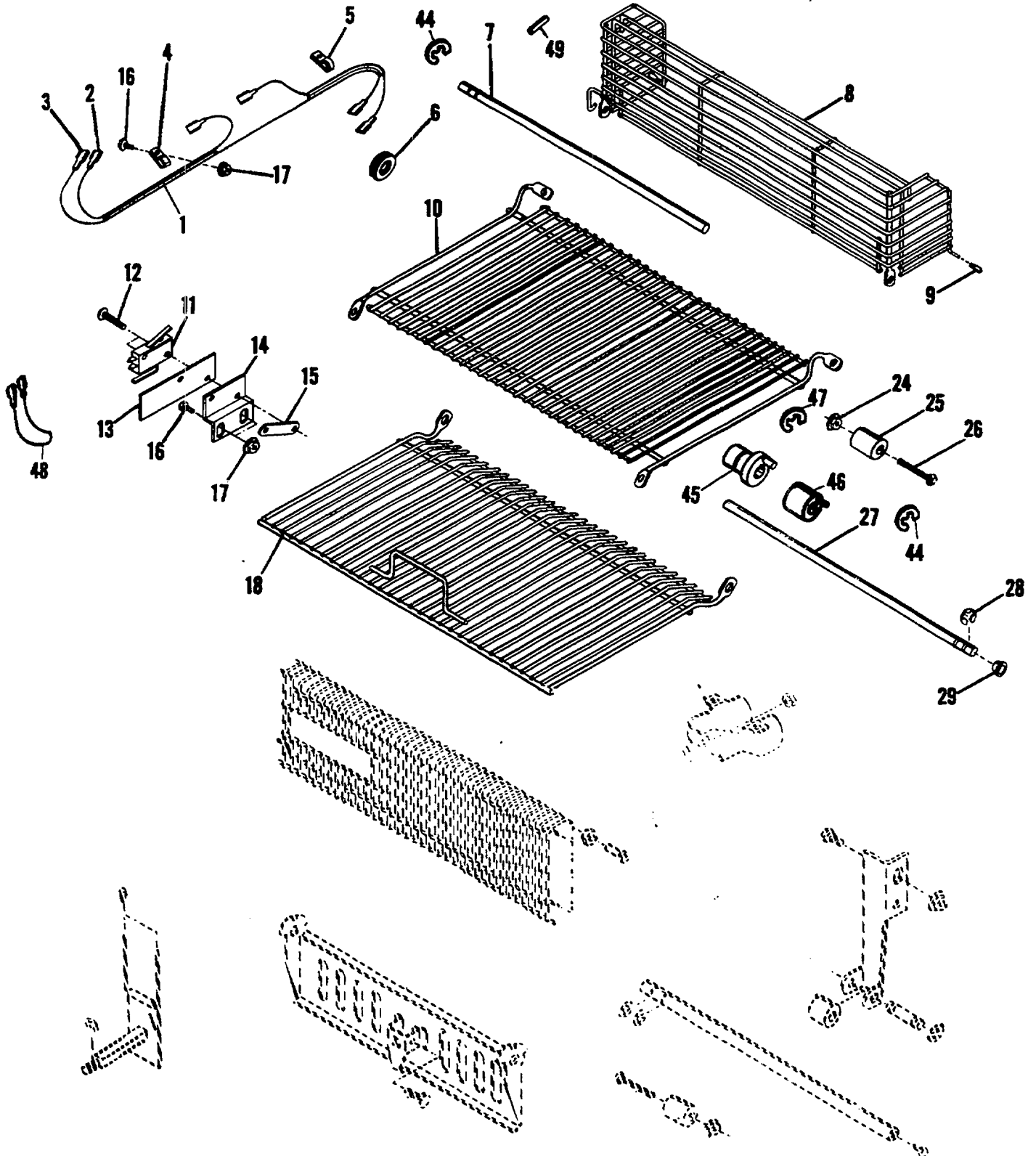

FIGURE 75A
MODEL 9820/9850 (1:1) Safety Screens and Back Stop

Parts Catalog

Index No.	Part No.	MODEL 9805/9850 Figure 75A Description	Units Per Assy.
1	016749	HARNESS ASSEMBLY - Guard Switches	1
2	250062	TERMINAL	6
3	250030	TUBING - Heat Shrink	6
4	250221	CLAMP - Cable, .144 x .312 I.D.	2
5	250204	CLAMP - Cable, 5/16 I.D.	1
6	101961	GROMMET- 3/8 I.D. x 5/8 O.D. x 3/16	1
7	016535	SHAFT - Guard Front	1
8	016525	GUARD - Front	1
9	101944	BUMPER - Vinyl	4
10	016526	GUARD - Chain Front	1
11	250137	SWITCH - 24V. Safety Circuit (9810)	2
11	252439	SWITCH - 5V. Safety Circuit	2
12	111006	SCREW - 4-40 x 9/16	4
13	006917	INSULATION - Switch	2
14	016536	BRACKET - Switch	2
15	190555	PLATE - Nut 4-40	2
16	111035	SCREW - 8-32 x 7/16	4
17	150081	NUT - 8-32	6
18	016527	GUARD - Chain, Rear	1
24	150083	NUT - 10-32	11
25	196454	SPACER- Guard Stop	6
26	100366	SCREW - Flat Head, 10-32 x 1-1/4	1
26	111060	SCREW - 10-32 x 1-1/8	5
27	016534	SHAFT - Guard, Chain	1
28	014504	RING - Retaining, .146 I.D. x .335 O.D. x .027	6
29	100539	BUSHING- Flanged, Nylon .187 I.D. x .250 O.D. x .078	8

For 48-dash 9805/50 240V 50Hz. United Kingdom Machines

1	018341	HARNESS ASSEMBLY	United Kingdom	1
7	192731	SHAFT	United Kingdom	1
8	018325	GUARD	United Kingdom	1
10	018328	GUARD	United Kingdom	1
11	253211	SWITCH	United Kingdom	2
12	101983	SCREW - 6-32 x 1-5/8	United Kingdom	2
13	010342	INSULATION - Switch	United Kingdom	2
15	190731	PLATE - Nut, 6-32	United Kingdom	1
18	018328	GUARD	United Kingdom	1
27	018334	SHAFT- Hex	United Kingdom	1
29	018329	BUSHING - Hex	United Kingdom	1
44	001060	RING - Retaining .208 I.D. x .027	United Kingdom	2
45	018331	CAM SLEEVE ASSEMBLY	United Kingdom	1
46	018340	ADAPTER ASSEMBLY	United Kingdom	1
47	001073	RING - Retaining, .577 I.D.	United Kingdom	1
48	196635	WIRE ASSEMBLY	United Kingdom	1
49	001974	PIN - Roll, 3/32 x 7/16	United Kingdom	1