

Parts Catalog

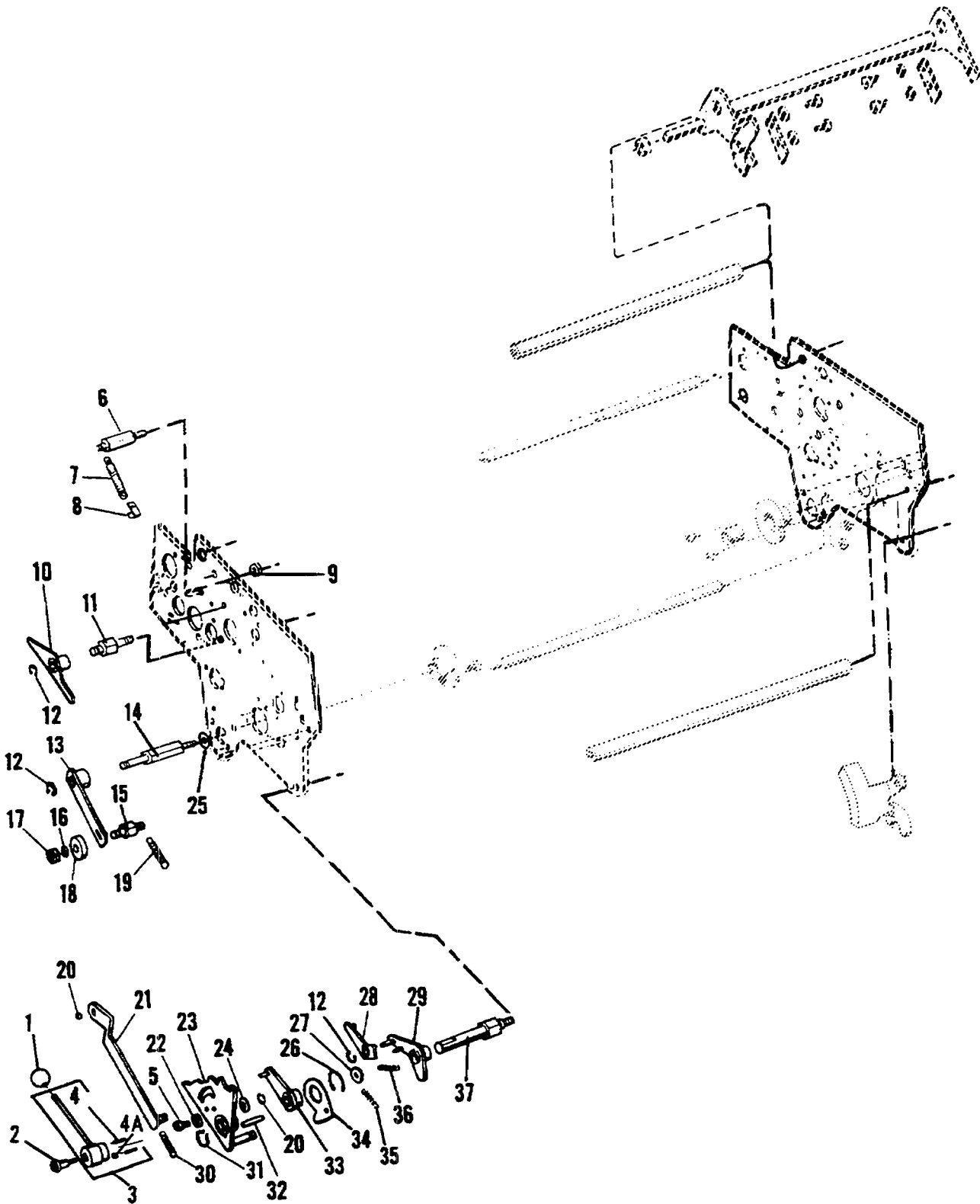

FIGURE 24A
MODEL 9805/9810 Operation Control Lever

Parts Catalog

Index No.	Part No.	MODEL 9805/9850 Figure 24A Description	Units Per Assy.
1	017819	KNOB	1
2	196249	SCREW - Shoulder, 1/4 - 28	1
3	017744	LEVER - Control, 9805-9810	1
4	100827	PIN- Spiral, .168 O.D. x .635 O.A.L.	2
4A	194849	INSERT	2
5	014350	SCREW - Cap, 10-32 x 5/16	1
6	075644	STUD	1
7	064589	SPRING - Tension, .250 O.D. x 1.187 O.A.L.	1
8	073107	HOOK	1
9	014808	NUT - 10-32	1
10	071611	LEVER	1
11	191034	STUD	1
12	001060	RING - Retaining, .208 I.D.	2
13	071606	LEVER	1
14	191935	STUD	1
14	196823	STUD - (Without Washer)	1
15	191934	STUD	1
16	000666	WASHER- Lock, .194 I.D. (Split)	1
17	001812	NUT - 10-32	1
18	064234	TRUCK	1
19	065402	SPRING - Tension, .375 O.D. x 1.593 O.A.L.	1
20	001095	RING - Retaining, .245 I.D.	2
21	071596	LINK	1
22	071610	DISC	1
23	071598	CAM	1
23	075537	CAM - Alternate Sheetfeed	1
24	018062	WASHER - .328 I.D.	1
25	190631	WASHER - Spacer, .250 I.D. x .562 O.D. x .125	1
26	014520	RING - Retaining, .683 I.D.	1
27	014709	WASHER - .767 I.D.	1
28	071603	LEVER	1
29	071601	LEVER	1
30	073542	SPRING - Tension, .390 O.D. x 1.821 O.A.L.	1
31	001048	RING - Retaining, .463 I.D.	1
32	191939	STUD	1
33	076698	LEVER	1
34	076702	LEVER	1
35	193007	SPRING - .250 O.D. x 1.140 O.A.L.	1
36	022343	SPRING - Tension, .187 O.D. x .687 O.A.L.	1
37	084407	SHAFT	1