

Parts Catalog

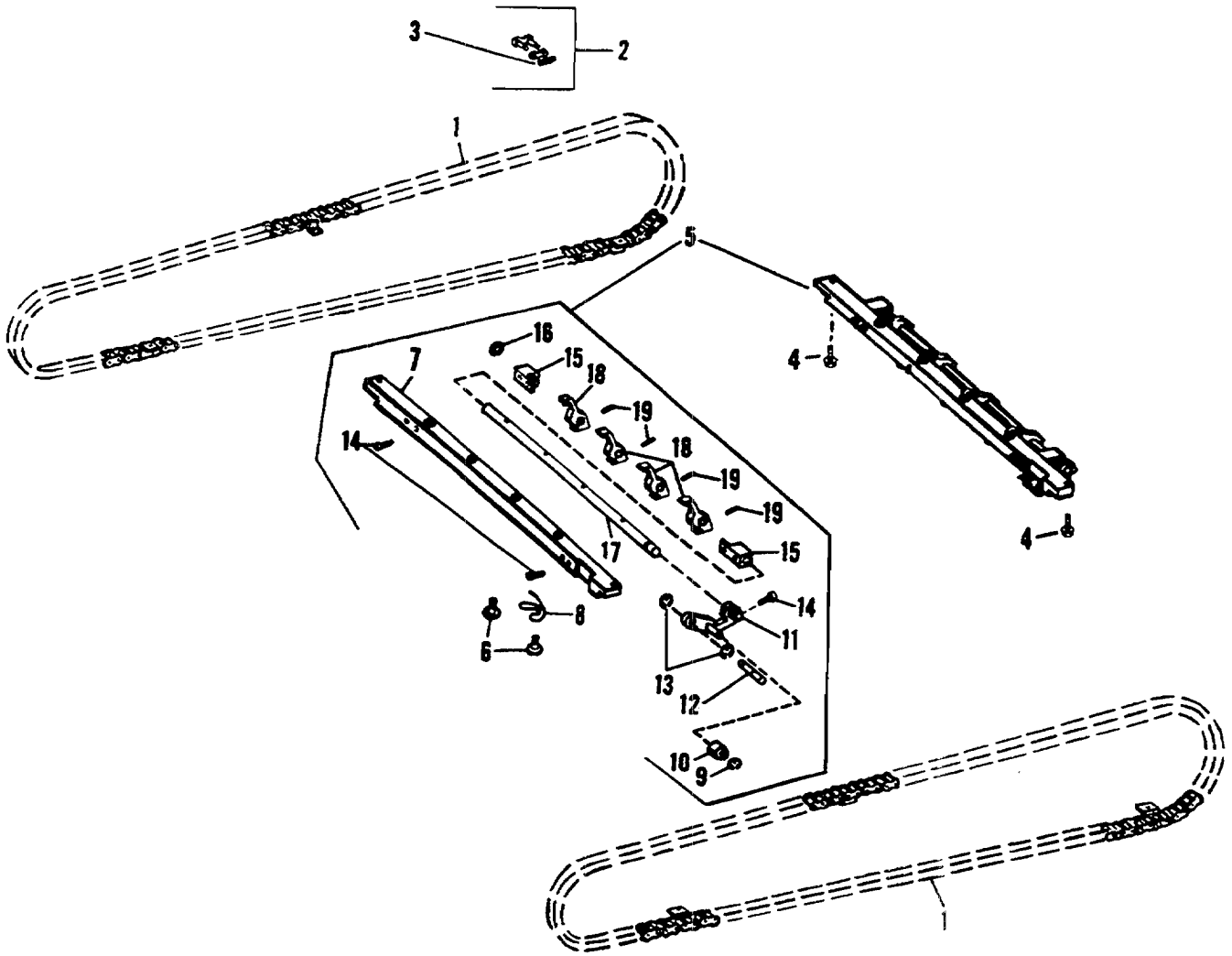

FIGURE 67
MODEL 9815/9850 Gripper Bar and Chain Assemblies

Parts Catalog

Index No.	Part No.	MODEL 9805/9850 Figure 67 Description	Units Per Assy.
1	>078485	CHAIN ASSEMBLY - Gripper Bar Carrier #40	2
1	016381	CHAIN ASSEMBLY - Gripper Bar #41	2
2	>081885	LINK ASSEMBLY - Chain Coupler #40	2
2	196473	LINK ASSEMBLY - Chain Coupler #41	1
4	>014327	SCREW - 10-32 x 1/2	6
4	101918	SCREW - Hex Socket, Nylok, 10-32 x 5/8 (Old Design)	6
4	100976	SCREW - Hex Head, NYLOK 10-32 x 5/16	6
5	016690	GRIPPER BAR ASSEMBLY	3
6	041750	SCREW - Shoulder, 8-32	2
7	016691	BAR ASSEMBLY - Gripper	1
8	007982	SPRING - Gripper Tension	2
9	>001060	RING - Retaining, .208 I.D. x .027	1
9	001049	RING - Retaining, .227 I.D. x .027	1
10	>073064	TRUCK - Cam Follower	1
10	196412	TRUCK - Cam Follower	1
11	>081765	CAM FOLLOWER - Gripper Assembly	1
11	016501	CAM FOLLOWER - Gripper	1
12	080564	STUD - Cam Follower	1
13	014504	RING - Retaining, .146 I.D. x .027	2
14	014164	SCREW - 8-32 x 7/16	5
15	081764	BEARING - Gripper Shaft	2
16	001046	RING - Retaining, .283 I.D. x .027	1
17	007727	SHAFT ASSEMBLY - Gripper	1
18	081762	GRIPPER - Paper	4
19	014576	PIN - Driv-Lok, .093 O.D. x 9/16	4

>For Chain Delivery With Aluminum Frames