

# Parts Catalog

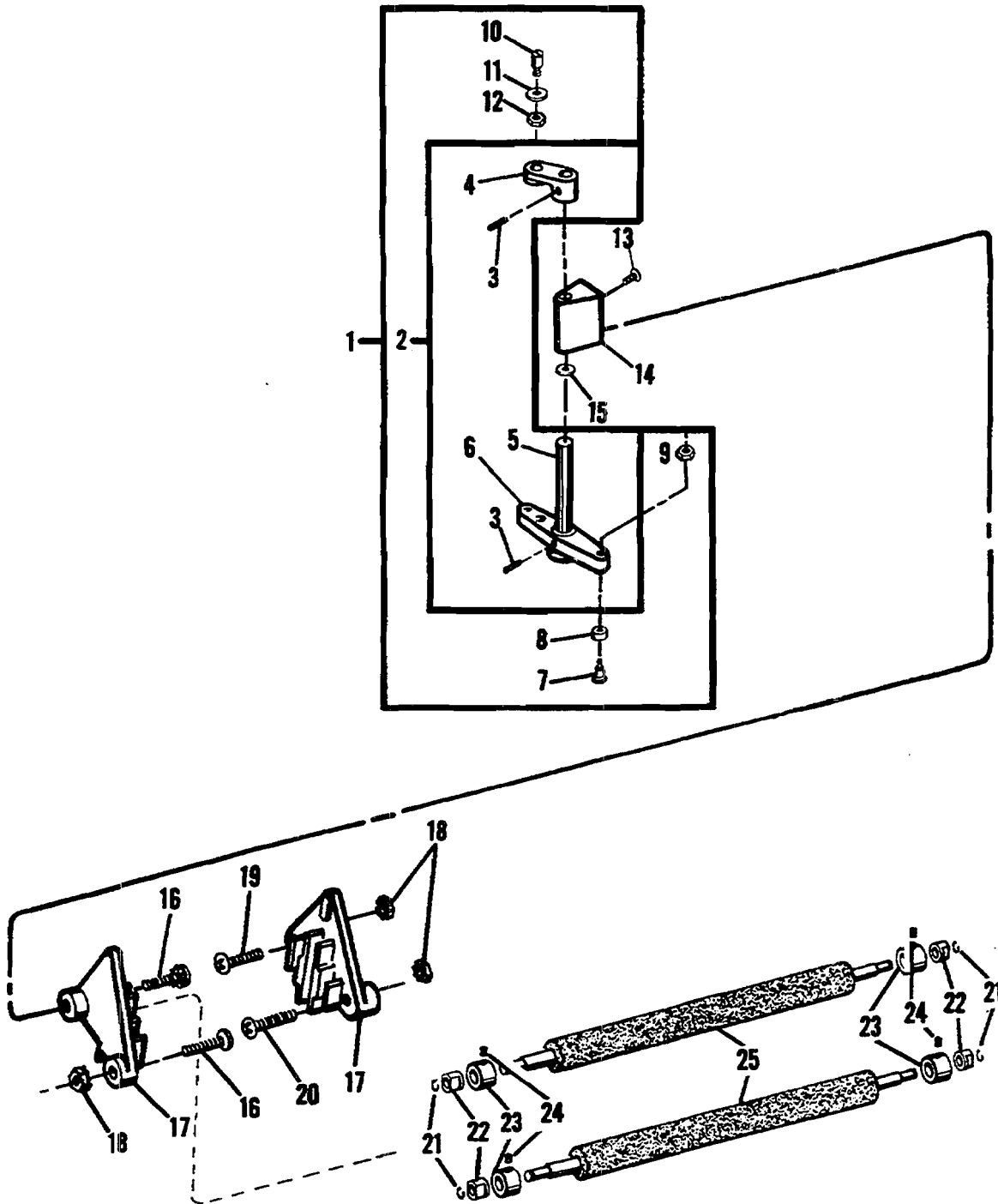

FIGURE 11  
MODEL 9815/9850 Rider Rollers

# Parts Catalog

| Index No. | Part No. | MODEL 9805/9850 Figure 11<br>Description            | Units<br>Per Assy. |
|-----------|----------|---|--------------------|
| 1         | 087496   | LEVER AND SHAFT ASSEMBLY - Standard.....            | 1                  |
| 1         | 080300   | LEVER AND SHAFT ASSEMBLY - Dampener.....            | 1                  |
| 2         | 087497   | SHAFT ASSEMBLY - Standard.....                      | 2                  |
| 2         | 081151   | SHAFT ASSEMBLY - Dampener.....                      | 1                  |
| 3         | 192900   | PIN - Taper, .750 O.A.L.....                        | 2                  |
| 4         | *073116  | LEVER - Standard.....                               | 1                  |
| 4         | *080689  | LEVER - Dampener.....                               | 1                  |
| 5         | *080317  | SHAFT.....  | 1                  |
| 6         | *080297  | LEVER.....  | 1                  |
| 7         | 080298   | SCREW - Shoulder, 10-32.....                        | 2                  |
| 8         | 080299   | TRUCK.....  | 2                  |
| 9         | 101051   | NUT - 10-32.....                                    | 2                  |
| 10        | 073339   | SCREW - Eccentric, 10-32, Standard.....             | 1                  |
| 10        | 080688   | SCREW - Eccentric, Dampener.....                    | 1                  |
| 11        | 001702   | WASHER - .195 I.D. x .500 O.D., Standard.....       | 1                  |
| 11        | 001710   | WASHER - Lock, .319 I.D. x .575 O.D., Dampener..... | 1                  |
| 12        | 001812   | NUT - 10-32, Standard.....                          | 1                  |
| 12        | 001834   | NUT - 5/16-24, Dampener.....                        | 1                  |
| 13        | 111073   | SCREW - 1/4-28 x 5/8.....                           | 3                  |
| 14        | 073108   | BRACKET - Waver Operation.....                      | 1                  |
| 15        | 192766   | WASHER - .385 I.D. x .750 O.D.....                  | 2                  |
| 16        | 111076   | SCREW - 1/4-28 x 1.000.....                         | 2                  |
| 17        | 073234   | BRACKET - Oscillating Rider Roller.....             | 2                  |
| 18        | 150085   | NUT - 1/4-28.....                                   | 3                  |
| 19        | 111077   | SCREW - 1/4-28 x 1.125.....                         | 1                  |
| 20        | 111079   | SCREW - 1/4-28 x 1.500.....                         | 1                  |
| 21        | 001778   | RING - Retaining, .214 I.D.....                     | 8                  |
| 22        | 073004   | BUSHING - .253 I.D. x .500 O.D. x .140 O.A.L.....   | 8                  |
| 23        | 073152   | COLLAR - Rider Roller.....                          | 8                  |
| 24        | 001207   | SCREW - Set, 8-32 x 3/16.....                       | 8                  |
| 25        | 007547   | ROLLER - Rider.....                                 | 4                  |

\*Not Procurable Separately