

Parts Catalog

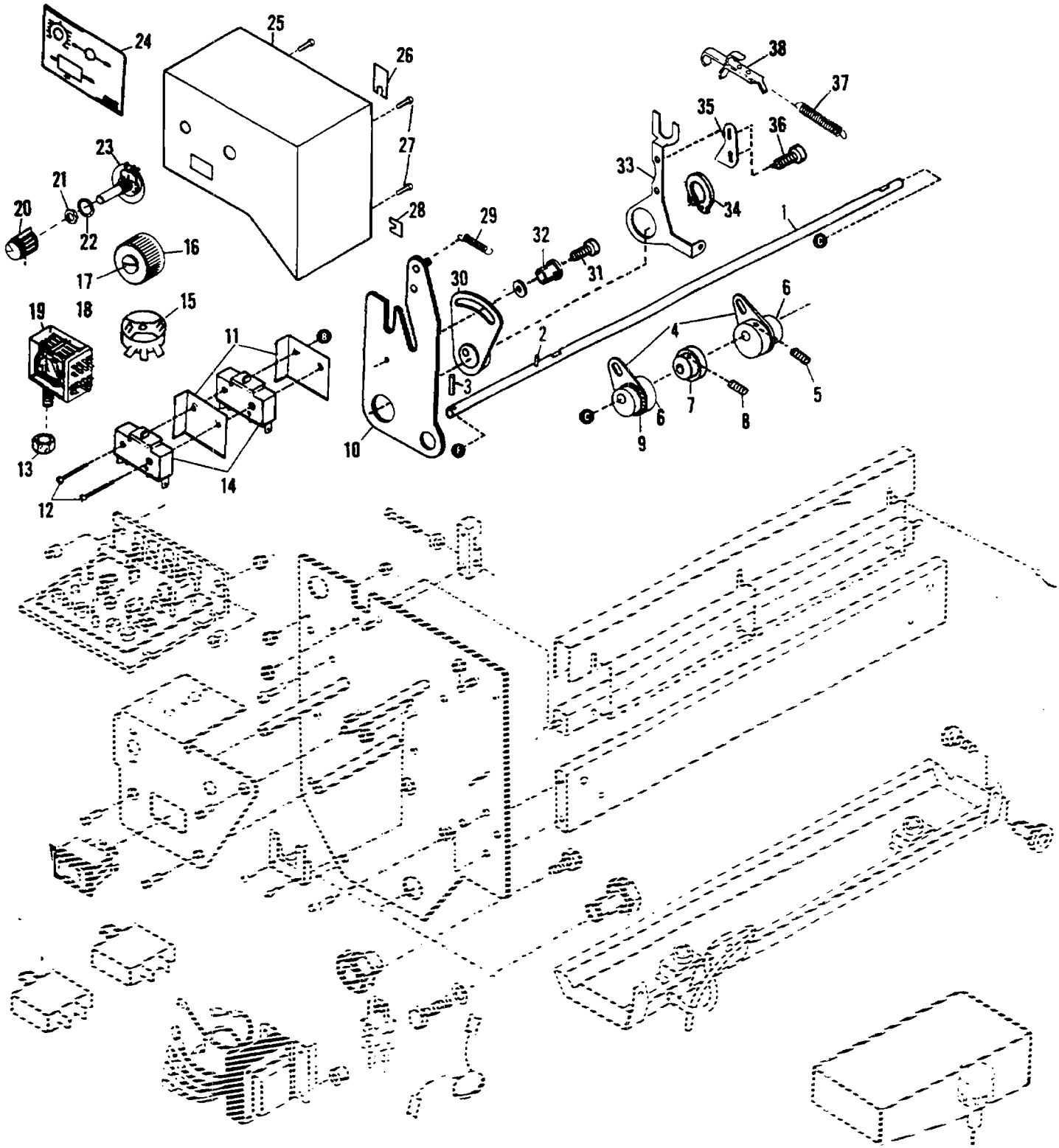

FIGURE 9B
MODEL 9815/9850 Dampener - Part I

Parts Catalog

Index No.	Part No.	MODEL 9805/9850 Figure 98 Description	Units Per Assy.
1	016771	SHAFT ASSEMBLY	1
2	001978	PIN - ROLL, .135 O.D. x .765 O.A.L.	1
3	001980	PIN - ROLL, .135 O.D. x .640 O.A.L.	1
4	083556	LEVER	2
5	100167	SCREW - Set, 1/4-28 x 5/8	2
6	083557	ECCENTRIC	2
7	016683	BUSHING - Eccentric	2
8	014108	SCREW - Set, 10-32 x 3/8	2
9	083555	RING - Self Locking	1
10	083566	ARM ASSEMBLY - O.S.	1
11	010342	INSULATOR	2
12	101983	SCREW - 6-32 x 1-5/8	2
13	014812	NUT - 6-32	2
14	253211	SWITCH	2
15	083610	POTENTIOMETER	1
16	017735	KNOB	1
17	196246	SCREW - Knob	1
18	039642	RING - Plastic	1
19	253468	RELAY	1
20	193823	KNOB	1
21	100144	NUT - 8-32	1
22	100835	WASHER - Lock, .383 I.D. x .562 O.D.	1
23	083609	POTENTIOMETER	1
24	016824	NAME PLATE	1
25	083506	COVER ASSEMBLY - O.S.	1
26	016199	STOP - Guard Long	2
27	014311	SCREW - 8-15 x 5/8	3
28	016198	STOP - Guard Short	1
29	006987	SPRING- 19/64 O.D. x 1-15/32 O.A.L.	1
30	083483	HUB ASSEMBLY - O.S.	1
31	014175	SCREW - 10-32 x 7/8	1
32	196309	SPACER	2
33	016677	LEVER ASSEMBLY - Lockout, O.S.	1
33	016680	LEVER ASSEMBLY - Lockout, N.O.S. (Not Illustrated)	1
34	001087	RING - Retaining, 1.108 I. D. x .052	2
35	016682	STOP - Adjustable	2
36	111033	SCREW - 8-32 x 5/16	4
37	065402	SPRING - Tension, 11/32 O.D. x 1-17/32 O.A.L.	2
38	016687	HOOK ASSEMBLY - Latching	2