

Parts Catalog

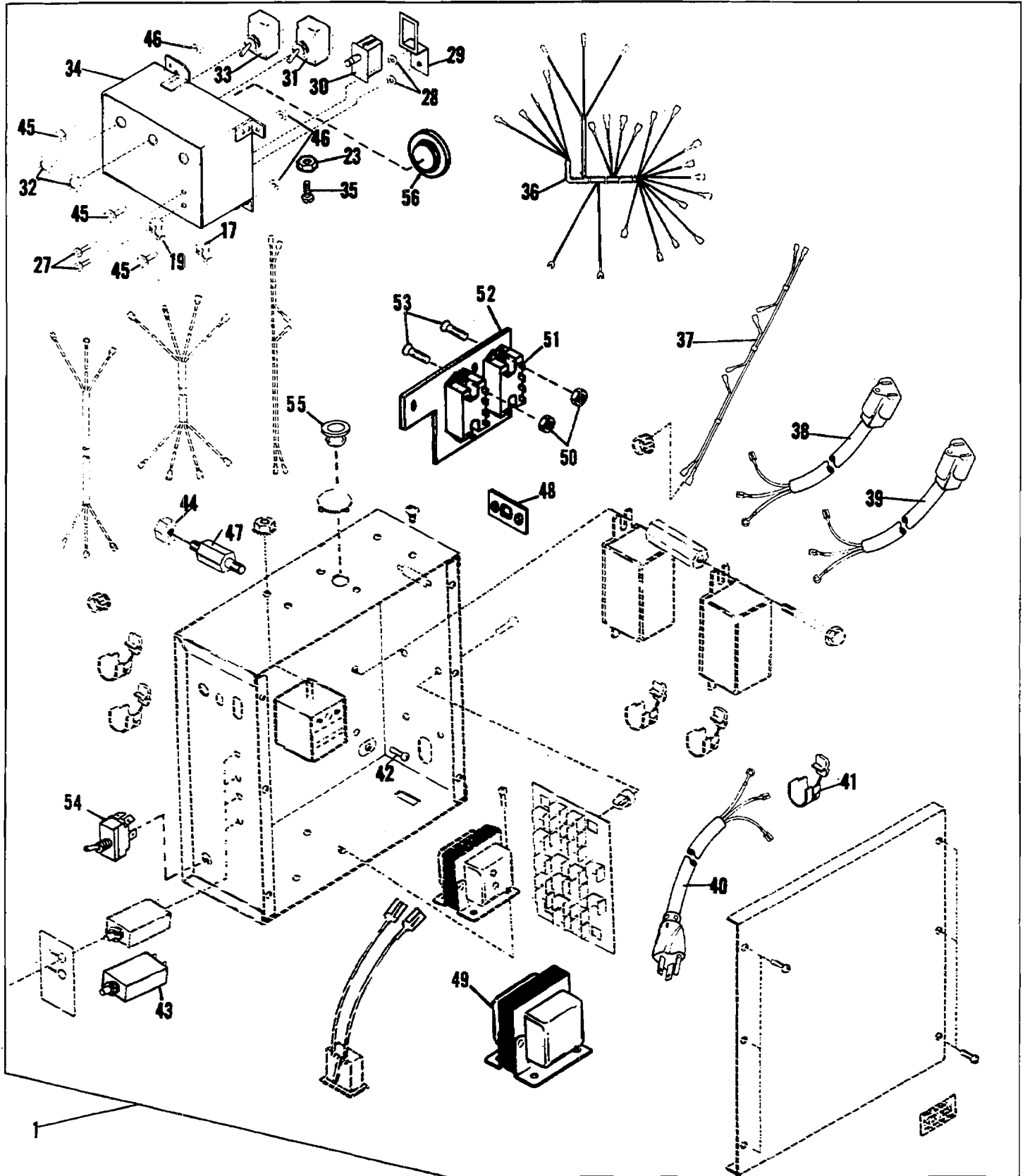

FIGURE 50B
MODEL 9805/9810 Control and Switch Box Assemblies - Part II

Parts Catalog

Index No.	Part No.	MODEL 9805/9850 Figure 50B Description	Units Per Assy.
1	018195	CONTROL AND SWITCH BOX ASSEMBLY - 115V. 50/60 HZ	1
1	018319	CONTROL AND SWITCH BOX ASSEMBLY - 220V. 60 HZ	1
1	018320	CONTROL AND SWITCH BOX ASSEMBLY - 240V. 50 HZ	1
1	018322	CONTROL AND SWITCH BOX ASSEMBLY - 220V. 50 HZ	1
17	250293	STRAIN RELIEF - 5/8 O.D.	4
19	275000	STRAIN RELIEF - 1/2 O.D.	2
23	014812	NUT - 6-32	2
27	100657	SCREW - 10-32 X 5/16	2
28	001702	WASHER - .196 I.D. x .500 O.D. x .031	2
29	018092	BRACKET ASSEMBLY - Service By - Pass	1
30	250952	SWITCH - Push-Pull, Service By - Pass	1
31	253238	SWITCH - Toggle, Vacuum	1
32	018229	NUT - 15/32 - 32	2
33	250865	SWITCH - Toggle, Drive	1
34	018186	SWITCH BOX ASSEMBLY	1
35	001548	SCREW - 6-32 X 3/8, Grounding	1
36	018249	HARNESS ASSEMBLY- Control Box, 115V. 50/60 HZ.	1
36	018318	HARNESS ASSEMBLY - Control Box, 220/240V. 50/60 HZ.	1
37	079099	CABLE ASSEMBLY - N.O.S. 115/220V	1
37	018321	CABLE ASSEMBLY - N.O.S. 240V	1
38	196121	CORD ASSEMBLY - Motor, Vacuum	1
39	196117	CORD ASSEMBLY - Motor Drive	1
40	196230	CORD ASSEMBLY - Power 115 VAC.	1
41	059717	STRAIN RELIEF - 7/8 O.D.	2
42	001693	SCREW - 8-32 x 1/4, Grounding	2
43	250051	BREAKER - Circuit, 10 Amp. 115V.	3
43	252537	BREAKER - Circuit, 8 Amp. 220/240V.	2
43	252539	BREAKER - Circuit, 6 Amp. 230V.	2
44	014807	NUT - 1/4-28	3
45	111054	SCREW - 10-32 x 1/2, Switch Box Mounting	1
46	014808	NUT- 10-32	1
47	017144	POST - Control Box Mounting	1
48	016188	PLATE - Strain Relief, (9810 XCD Only)	4
49	079616	TRANSFORMER - T2, 220/240V. - 115V. Work Lamp	2
49	079615	TRANSFORMER - T2, 230V. - 115V. Work Lamp	1
50	001805	NUT - 6-32	4
51	253856	RELAY - Power, DPST. 24 VAC. 1HP. (New Design)	1
54	253005	SWITCH - Toggle DPST.	1
55	251520	BUSHING - Nylon, .500 O.D. 220/240V.	1
56	253839	PLUGBUTTON - 7/8 Dia. Hole	1