

# Parts Catalog

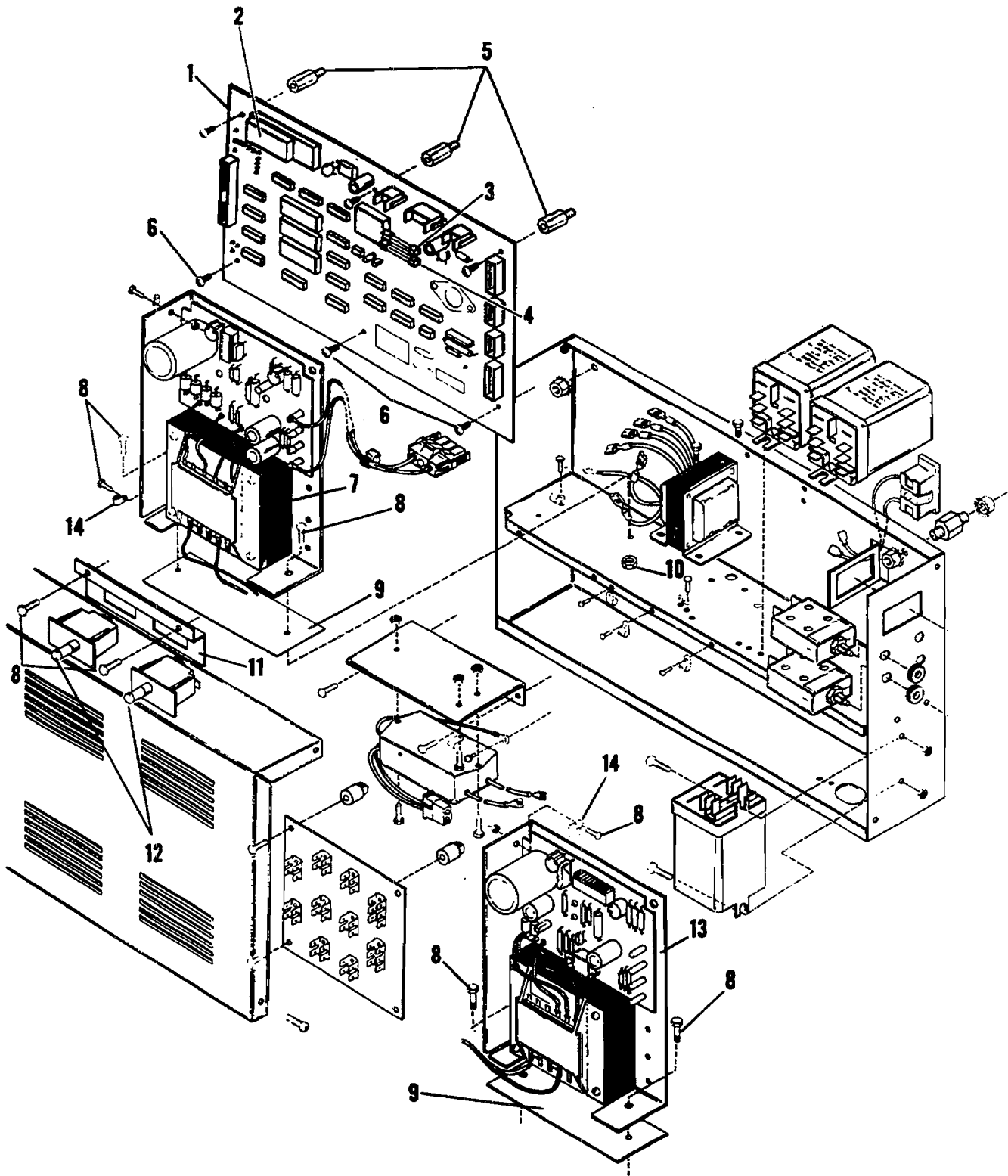

FIGURE 56  
MODEL 9815/9850 Control Box - Part II

# Parts Catalog

Index No.	Part No.	MODEL 9805/9850 Figure 56 Description	Units Per Assy.
1	017130	P.C. BOARD ASSEMBLY - Controller, Optical (TD and CD) .....	1
1	018490	P.C. BOARD ASSEMBLY - Hall Effect (TD and CD) .....	1
1	018385	P.C. BOARD ASSEMBLY - Controller, Optical (QP, QPC and PRO) .....	1
1	018491	P.C. BOARD ASSEMBLY - Hall Effect (QP, QPC and PRO) .....	1
2	016309	INTEGRATED CIRCUIT .....	1
3	252781	FUSE - 1-1/4Amp. 250V .....	1
4	250915	FUSE - 3Amp. 250V .....	1
5	196333	STAND-OFF .....	6
6	001548	SCREW - 6-32 x 3/8 .....	6
7	017870	POWER SUPPLY - 24V. 115V .....	1
8	111034	SCREW - 8-32 x 3/8 .....	9
9	017019	INSULATOR .....	2
10	014811	NUT - 8-32 .....	2
11	017032	BRACKET ASSEMBLY .....	1
12	250952	SWITCH - Bypass, Pump and Drive .....	2
13	017866	POWER SUPPLY - 5V. 115V .....	1
14	250505	CLAMP - Cable .....	3

For Other Than 115 V. 60 Hz. or 115 V 50/60 Hz. Dual Usage

7	017871	POWER SUPPLY - 24V. 100V. ....	1
7	017872	POWER SUPPLY - 24V. 200/220V. ....	1
7	017873	POWER SUPPLY - 24V. 230/240V. ....	1
13	017867	POWER SUPPLY - 5V. 100V. ....	1
13	017869	POWER SUPPLY - 5V. 200/220V. ....	1
13	017868	POWER SUPPLY - 5V. 230/240V. ....	1