

T-51 Swing-Away Turnbuckle Assembly Adjustment

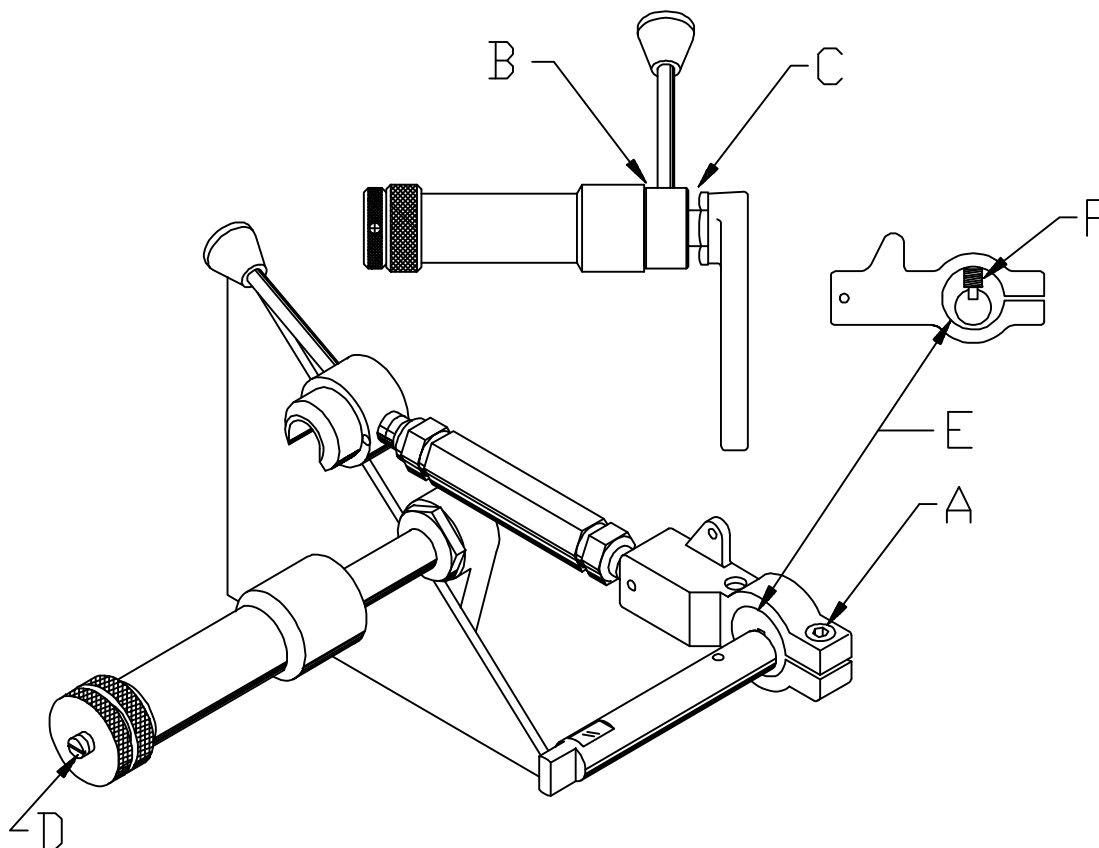

The turnbuckles and lock knobs need to be set properly to prevent binding and inconsistent plate to blanket pressures. Before making this adjustment, be sure that the T-51 is centered to the parent press. Refer to the installation instructions for proper centering of the T-51. It may be necessary to remove part of the single lever mechanism to reach the operator side turnbuckle.

With the T-51 swung away or on a bench, press the brass end of the turnbuckle against the side frame. Tighten the screw (A) in the brass so that it turns the yoke shaft when moving the hook up and down. Slowly back the screw out while moving the hook up and down. Stop when the turnbuckle moves with slight drag without turning the yoke shaft. Adjust both turnbuckle assemblies using this procedure.

Mount the T-51 on the parent press. Always keep slight pressure towards the T-51 side frame when attaching the hooks to the upper bracket stud. Adjust the lock knob so that the lock knob just contacts the flange (B) on the hook without moving the hook sideways. Adjust the stop screw (D) in the lock knob so that it just bottoms out. If you over tighten the stop screw, you will not be able to back the lock knob off by hand the first time it is used. This screw has a coating from the factory that will hold it in place after adjustment. It is not unusual to have a space (C) between the hook and the base of the stud on one or both sides.

Put the T-51 on impression and then back off. If the T-51 does not want to come out of print position or is very stiff, it may be necessary to loosen the screws (A) in the brass turnbuckle ends just slightly. It may be necessary to readjust plate to blanket pressures after this adjustment.

If inconsistent plate to blanket pressures or pressure related printing problems occur after turnbuckle adjustment, check the yoke shaft eccentrics (E) for looseness on the shaft. Remove the turnbuckles from the yoke shaft and check to see that the set screws (F) holding the eccentrics on the shaft have not become loose. If loose, you may want to put a thread locking solution on the set screws before tightening. Reinstall the turnbuckles and adjust as instructed above.